

N: 20,232.6460, E: 20,912.3913
 WL 1, Sta. 2+32.98=
 WL 2, Sta. 0+00.00
 1- 12" x 8" CI CL MJ Tee
 2- 12" Valve Assemblies (N,S)
 (MJ Butterfly Valves)
 1- 8" Anchored Valve Assemblies (E) RESERVE B
 (MJ Gate Valve)
 Top Valve Box El.= 1433.1 (N)
 Top Valve Box El.= 1433.2 (S)
 Top Valve Box El.= 1433.6 (E)

CAUTION !!!
 Prop. 8" SS Line

N: 20,232.6460, E: 20,972.4887
 WL 2, Sta. 0+60.10
 1- 2" Blowoff Assembly

FUTURE
 PARKING

HIGH
 SCHOOL

N: 19,999.6674, E: 20,912.3913
 WL 1, Sta. 0+00.0
 1- 12" x 12" CI CL MJ Tee
 1- 12" Anchored Valve Assembly (W)
 (MJ Gate Valve)
 Top Valve Box El.= 1434.9 (W)
 1- 12" CI MJ Plug (W)
 1- 12" x 8" PE x MJ Reducer (S)
 (Large End PE)
 5.00'-12" DI CL SJ Pipe (S)
 1- 2" Blowoff Assembly (S)
 Top Valve Box El.= 1434.9 (S)

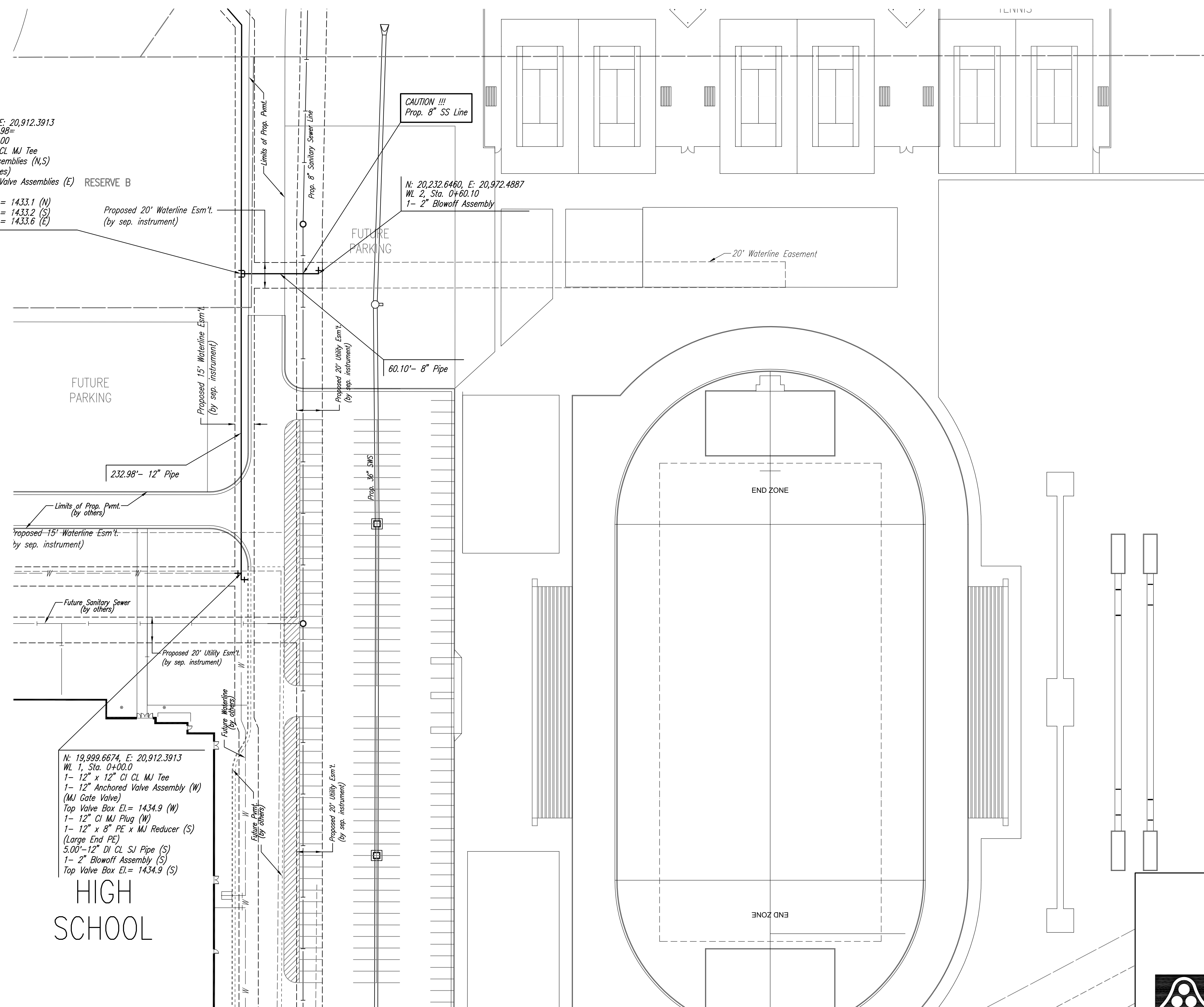
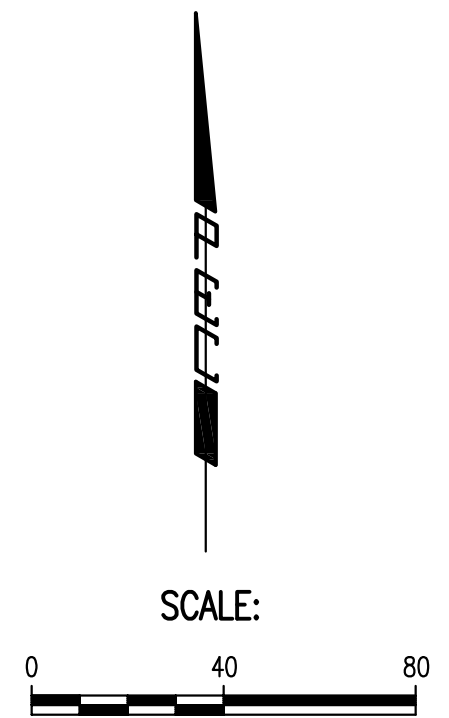

AS BUILT 4/15/2009

No.	Revision	By	Date
No.	Revision	By	Date
WATER DISTRIBUTION SYSTEM IMPROVEMENTS EISENHOWER MIDDLE SCHOOL - USD 265 GODDARD, KANSAS WATER LINE PLAN (SOUTH CENTRAL) JAMES L. ARMOUR, P.E. - CITY ENGINEER PRIVATE PROJECT NO. 1450 PFW (607853)			
Professional Engineering Consultants, P.A. 303 S. TOPEKA • WICHITA, KANSAS 67202 316-262-2691 • FAX 316-262-3003			
Designed by	RRY, MDK	Job No.	35-08430-259
Drawn by	TDS	Date	OCTOBER 2008
			Sht. C603

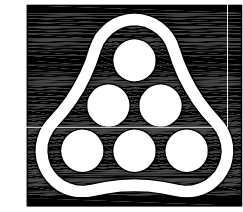

Saved: 01-19-2009 11:01:04 AM by RFT
 Plot Scale: 1"=40' 01-21-2009 1:20:02 PM
 C:\2009\08430\CHANGE ORDER\1\PPW\08430-C-603-WATER PLAN SOUTH-CENTRAL.dwg