

17th STREET FROM GROVE TO HILLSIDE

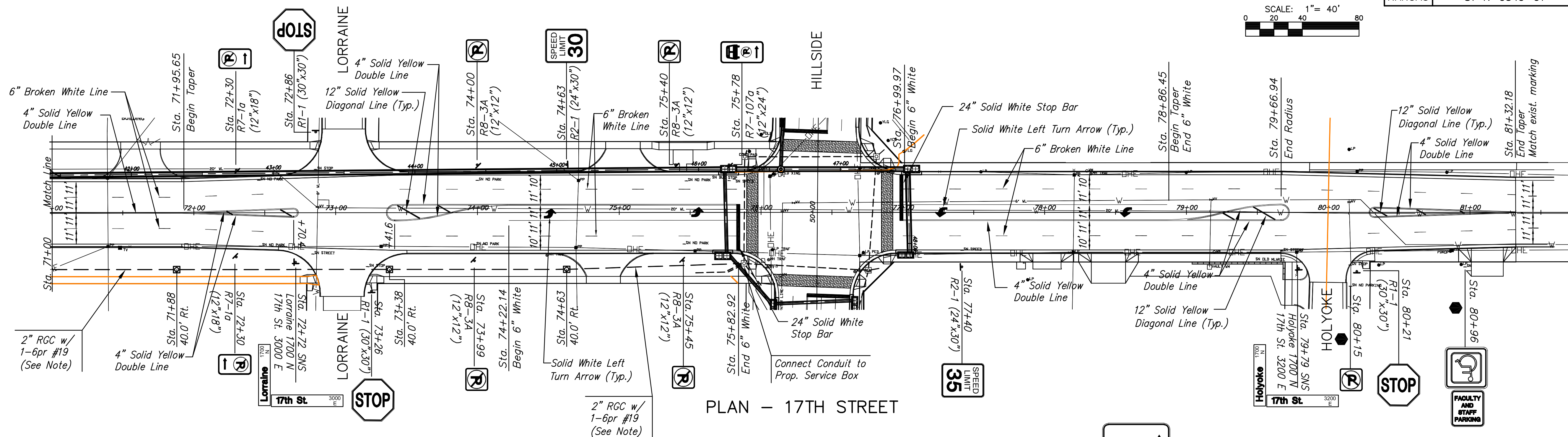

PLAN - 17TH STREET

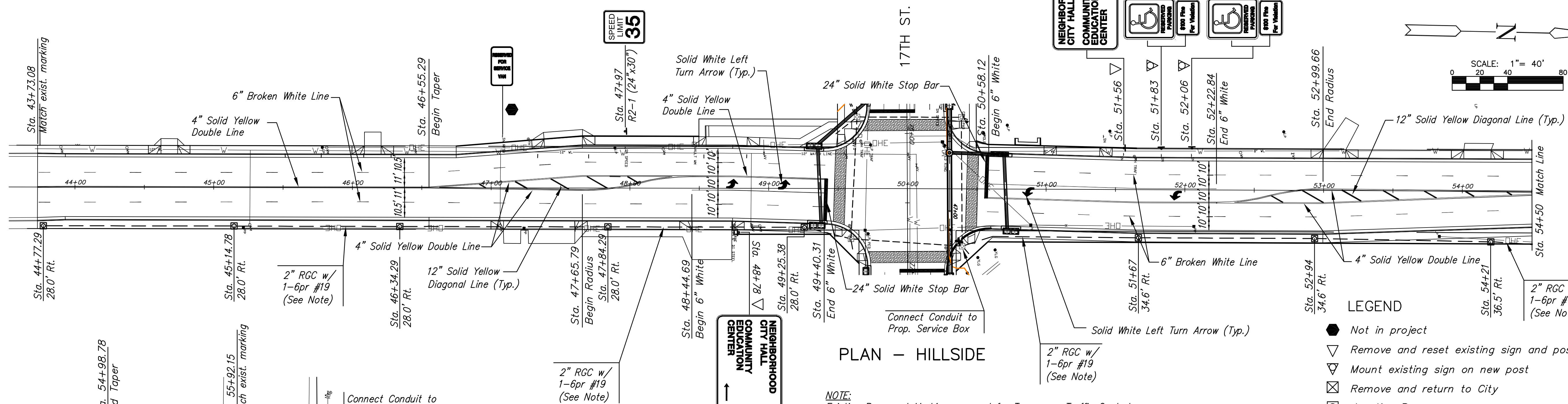

PLAN - HILLSIDE

LEGEND

- Not in project
- ▽ Remove and reset existing sign and post
- ▽ Mount existing sign on new post
- ⊗ Remove and return to City
- ⊠ Junction Box

NOTE:
Existing Pavement Marking removed for Temporary Traffic Control purposes beyond the limits of construction shall be replaced, in-kind on 17th, Grove, and Hillside. Quantities for this are reflected in the Summary of Quantities. 3,020 L.F. of 4\"/>

Pavement Markings - All pavement markings shall be thermoplastic, unless otherwise approved by the Engineer. Pavement markings shall be installed per manufacturer's recommendations and shall meet KDOT's 2007 Edition of the Standard Specification Section 806. Full traffic may not be restored (and substantial project completion achieved) until all pavement markings are in place. Should construction timing be such that restoration of traffic becomes necessary during temperatures prohibiting the installation of thermoplastic markings, the contractor shall install and maintain temporary markings until such time that thermoplastic markings may be properly installed. Except for the material requirement, temporary pavement markings shall be placed equivalent, in every manner (i.e. dimension, frequency, spacing, etc.), to the permanent marking layout. The cost for temporary pavement markings will not be paid for directly, but shall be considered subsidiary to the bid item for "Pavement Markings."

Notes:

- Placement of Junction Boxes and Conduit are typical and may be adjusted as directed by the Engineer to facilitate installation.
- Install 2\"/>

SUMMARY OF QUANTITIES (FOR INFORMATION ONLY)

ITEMS	QUANTITY	UNIT
Pavement Marking (White)(6")	3,540	L.F.
Pavement Marking (White)(24")	170	L.F.
Pavement Marking (Yellow)(4")	13,165	L.F.
Pavement Marking (Yellow)(12")	324	L.F.
Pavement Marking Symbol (Left Turn)	10	Each

RECAPITULATION OF QUANTITIES

BID ITEM	QUANTITY	UNIT
Pavement Marking	Lump Sum	L.S.

PAVEMENT MARKING AND SIGNING PLAN

SHEET TITLE
87 N-0349-01
PROJECT NUMBER

JRA
DESIGN BY
JSB
DRAWN BY
JRA
CHECKED BY

ISSUED
May 28, 2009

REVISED

SHEET NO.
89 of 133