

PHASE	HANDLING OF TRAFFIC	MAJOR CONSTRUCTION ITEMS	REMARKS
I	Maintain two-way, two-lane traffic on 17th Street, Hillside and Grove at all time. Flagger operations will be permitted for day-time street closures where two-lane, two-way traffic can not be maintained. The contractor shall coordinate necessary lane closures and traffic handling with the City.	Construct all water line improvements. Construct storm sewer improvements between Ash and Grove.	Phase 1 may be eliminated if water line improvements are to be completed during other phases of the work.
II	Maintain two-lane, two-way traffic on the south two lanes of 17th Street. Maintain two-lane, two-way traffic on the east two lanes of Hillside. Maintain two-lane, two-way traffic on the east half of Grove. Remove existing curb and construct temporary asphalt pavement to provide a 20 foot minimum pavement width on the east half of Grove.	Construct the north half of street and storm sewer improvements on 17th Street. Construct the west half of Grove and Hillside south of 17th Street. Construct the northwest quadrant of the 17th and Grove intersection and the 17th and Hillside intersection.	See diagram to the right.
III	Continue two-lane, two-way traffic on the south two lanes of 17th Street. Provide two-lane, two-way traffic on the west two lanes of Hillside. Provide two-lane, two-way traffic on the west half of Grove. Remove existing curb north of 17th and construct temporary asphalt pavement to provide a 20 foot minimum pavement width on the west half of Grove.	Continue construction the north half of street and storm sewer improvements on 17th Street. Construct the east half of Grove and Hillside. Construct the northeast quadrant of the 17th and Grove intersection and the 17th and Hillside intersection.	See diagram to the right.
IV	Provide two-lane, two-way traffic on the north two lanes of 17th Street. Continue two-lane, two-way traffic on the west two lanes of Hillside and on the west half of Grove.	Construct the south half of street and storm sewer improvements on 17th Street. Construct the southeast quadrant of the 17th and Grove intersection and the 17th and Hillside intersection.	See diagram to the right. The contractor may combine Phase 3 and Phase 4 upon completion of construction to the north half of 17th Street.
V	Continue two-lane, two-way traffic on the north two lanes of 17th Street. Provide two-lane, two-way traffic on the east two lanes of Grove and on the east two lanes of Hillside.	Continue construction the south half of street and storm sewer improvements on 17th Street. Construct the west half of Grove and Hillside north of 17th Street. Construct the southwest quadrant of the 17th and Grove intersection and the 17th and Hillside intersection.	See diagram to the right. The contractor may combine Phase 4 and Phase 5 upon completion of construction to the southeast quadrants of the two major intersections.
VI	Maintain two-way, two-lane traffic on 17th Street, Hillside and Grove at all time. Flagger operations will be permitted for day-time street closures where two-lane, two-way traffic can not be maintained. The contractor shall coordinate necessary lane closures and traffic handling with the City.	Construct asphalt surface course over all bituminous pavements and install permanent pavement marking throughout the project.	Surface courses and pavement markings may be installed during phased paving operations provided that surface courses do not receive temporary pavement marking or damage from construction operations.

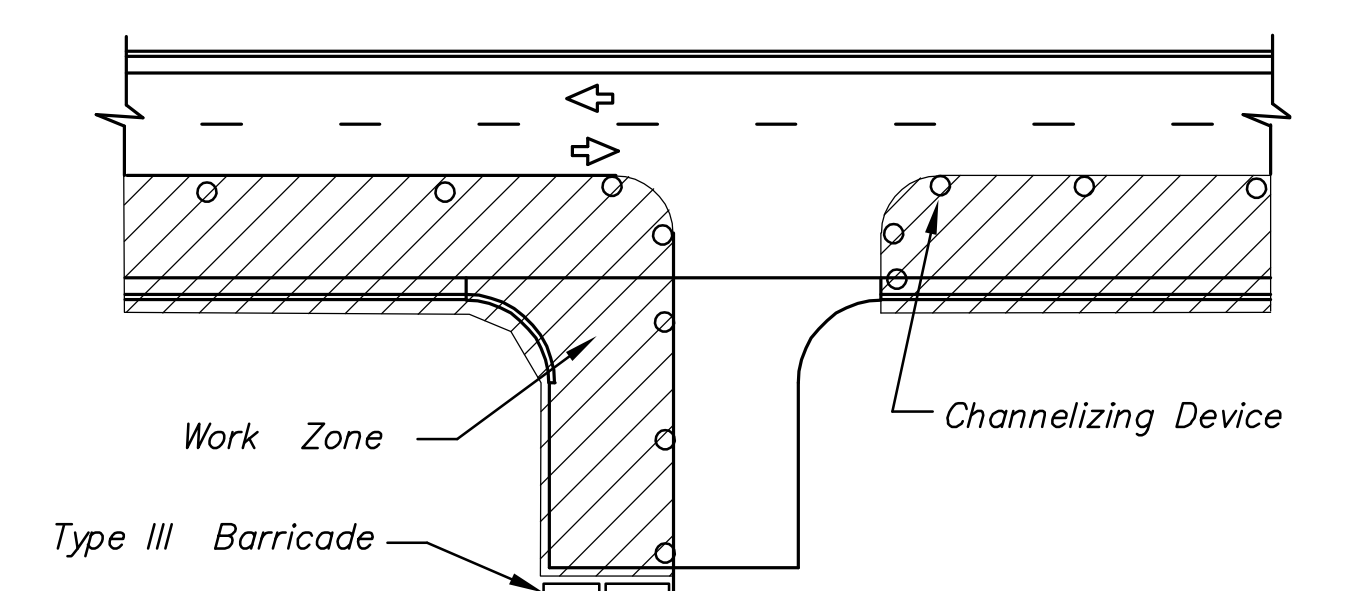
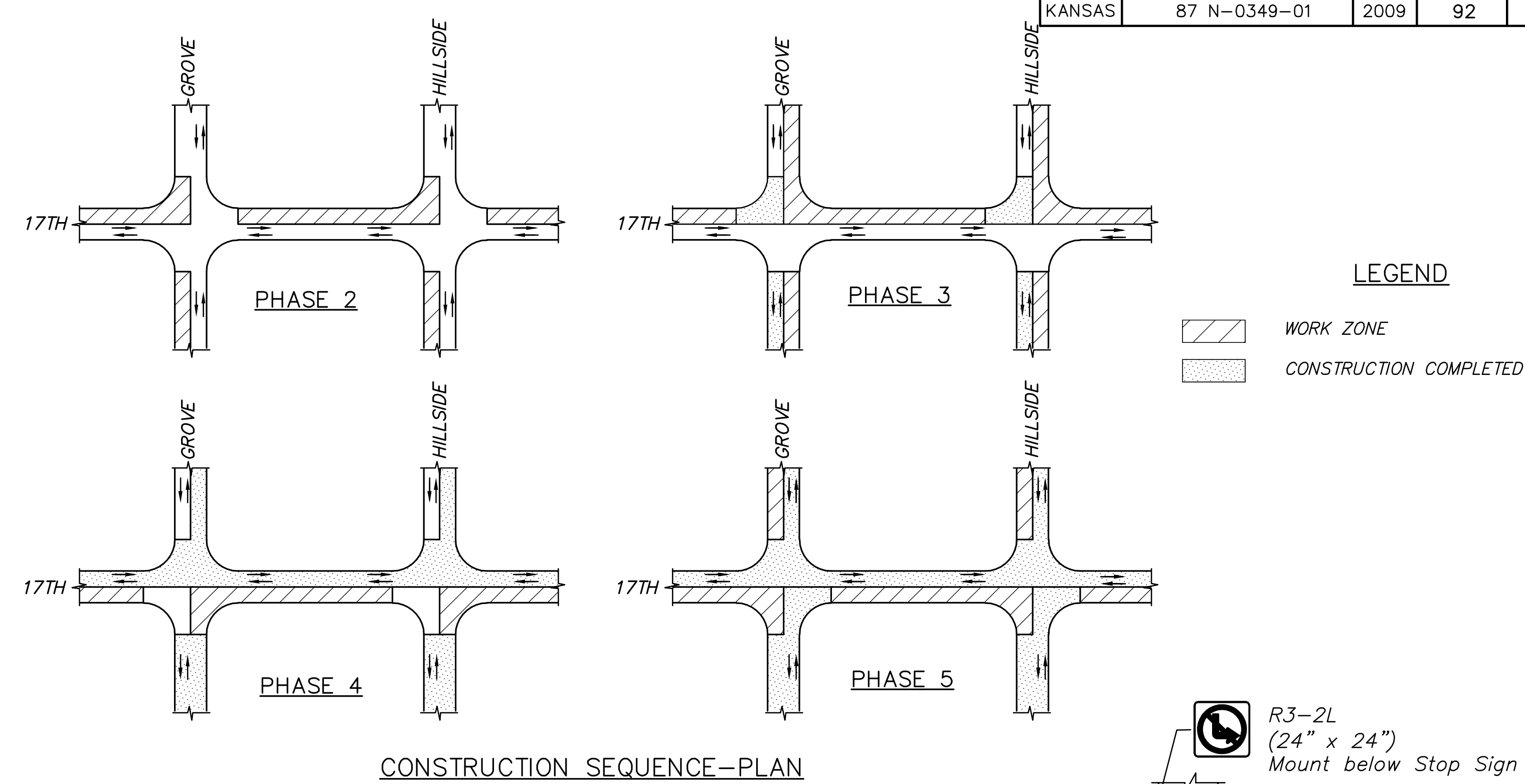

TYPICAL DRIVEWAY ENTRANCE CONSTRUCTION

Maintain access to businesses at all times. If a single property has multiple entrances, one entrance at a time may be closed for construction.

Note:
4" Solid White Edge Lines Are Required Along Existing Curbs.

- LEGEND**
- ▬ Type III Barricades with lights
 - ◊ Mount On Type III Barricade
 - ◻ Type B Warning Light
 - ▼ One Post Sign
 - ▼ Two Post Sign
 - ➔ Traffic Flow
 - ▨ Work Area
 - Reflectorized Drum
 - Tubular Marker
 - Vertical Panel
 - △ Mount Overhead on Signal Cross-arm

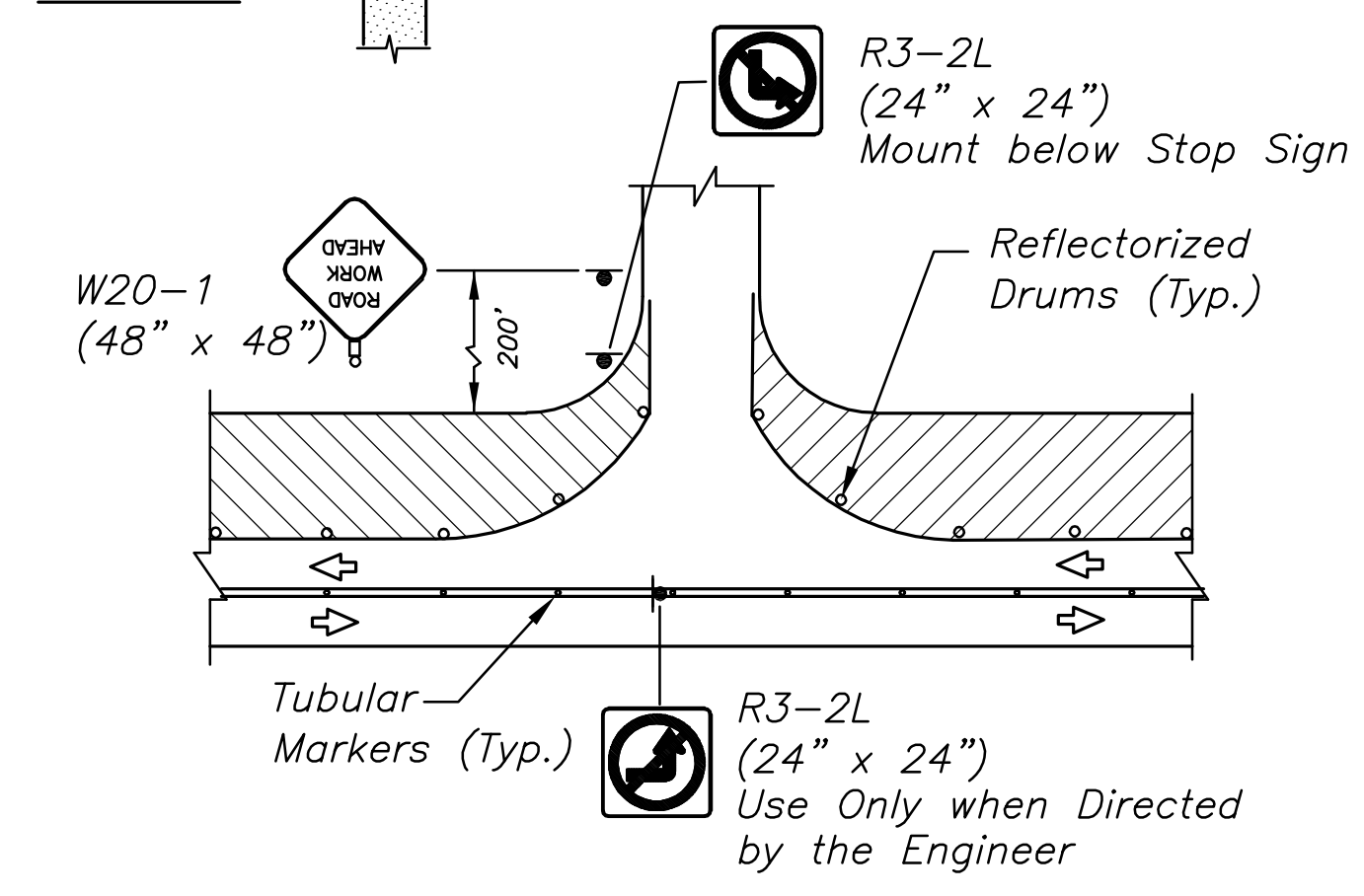

TYPICAL ENTRANCE AND SIDE STREET

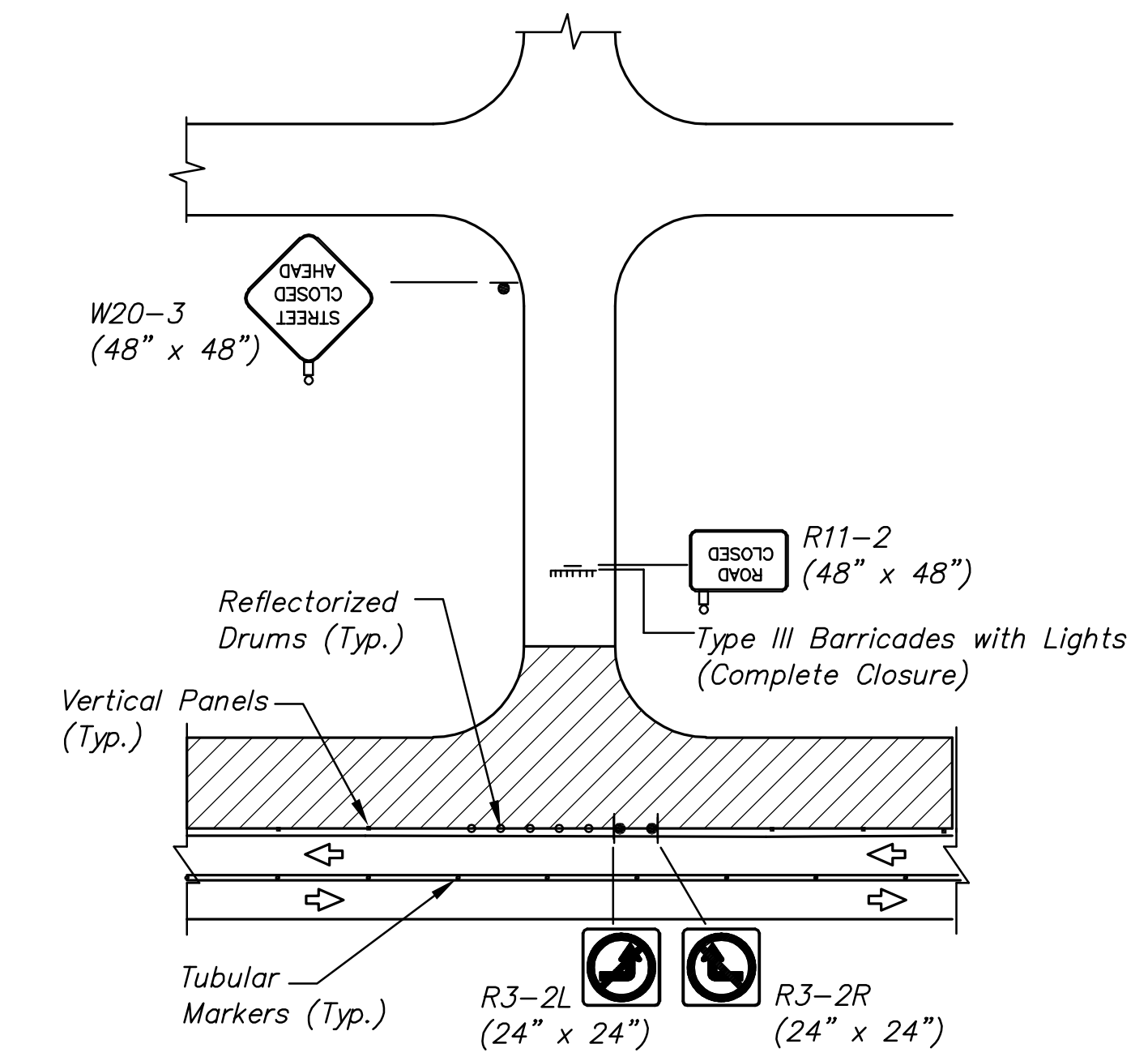

TYPICAL CLOSED SIDE STREET

GENERAL NOTES

1. In General, construction shall begin at the west end of the project and proceed eastwardly in conformance with the above construction sequence summary. Major work not constructed as indicated above shall be subject to written approval by the Engineer.
2. All signs and pavement markings conflicting with construction traffic control shall be covered or removed as directed by the Engineer.
3. As the various construction activities progress, certain situations may arise that will preclude adhering to the original construction sequence or which, in the opinion of the Contractor, would readily adapt themselves to a more efficient phasing operation. Should this occur, the Contractor may submit to the Engineer an alternative plan for approval.
4. Contractor shall maintain existing drainage system during construction and address local drainage issues as necessary during construction. Temporary drainage measures will be subsidiary to other items in the contract. Contractor shall provide for drainage in sump areas opened to traffic. Pondered stormwater in sump areas will not be allowed.
5. Maintain access to all properties within the project limits at all times. Driveways less than 16' wide may be closed completely during re-construction. Wider drives shall be constructed half-at-a-time with the other half remaining open. Properties with two driveways may have one drive closed for re-construction with the other drive remaining open.
6. Contractor shall not close two adjacent side streets at the same time during construction unless authorized by the City.
7. Businesses with access points on 17th Street and Grove or Hillside shall not have street construction occurring on both streets in front of the business at the same time.
8. All traffic control signs and devices shall be in conformance with the latest edition of the Manual on Uniform Traffic Control Devices.
9. Contractor shall provide temporary asphalt pavement where necessary to bridge grade differentials between new and existing pavement and to provide Temporary Widening as shown in the Traffic Control plans. Temporary surfacing to be 5" of Commercial Grade Asphalt. Cost of Temporary Surfacing shall be paid for as "Temporary Asphalt Pavement". Temporary pavement shall be approved by the Engineer. Approximately 1400 S.Y. of Temporary Asphalt Pavement is anticipated.

17th STREET FROM GROVE TO HILLSIDE

CONSTRUCTION SEQUENCE

SHEET TITLE
87 N-0349-01
PROJECT NUMBER

DESIGN BY: JRA
DRAWN BY: JSB
CHECKED BY: JRA

ISSUED: May 28, 2009
REVISED:

SHEET NO.
92 of 133