

STATE	PROJECT NO.	YEAR	SHEET NO.	TOTAL SHEETS
KANSAS	87 N-0349-01	2009	106	133

REFER TO STD. TE710 FOR ADDITIONAL INFORMATION ON TEMPORARY TRAFFIC CONTROL SIGNS AND SIGN SPACING.  
REFER TO STD. TE710 FOR TYPE III BARRICADES.  
REFER TO STD. TE702 FOR INFORMATION ON TAPERS AND CHANNELIZING DEVICES.  
REFER TO STD. TE700 FOR LENGTH OF BUFFER SPACE.

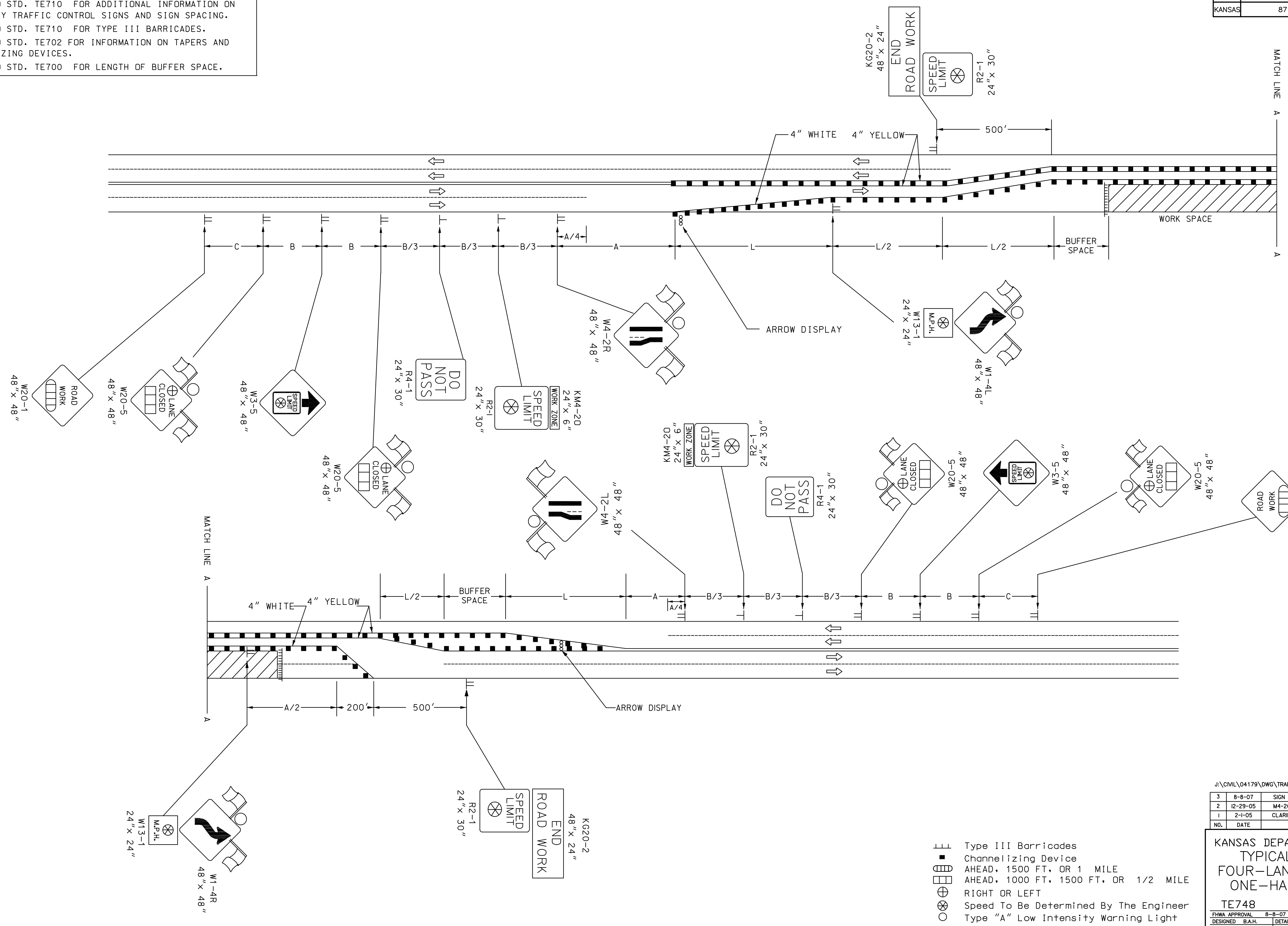

- ⊥ Type III Barricades
- Channelizing Device
- ⊕ AHEAD, 1500 FT. OR 1 MILE
- ⊖ AHEAD, 1000 FT, 1500 FT, OR 1/2 MILE
- ⊕ RIGHT OR LEFT
- ⊗ Speed To Be Determined By The Engineer
- Type "A" Low Intensity Warning Light

J:\CIVIL\04179\DWG\TRAF\TE748.DWG

3	8-8-07	SIGN SPACING CHANGE	M.B.	A.A.A.
2	12-29-05	M4-20 CHANGED TO K4-20	M.B.	A.A.A.
1	2-1-05	CLARIFIED NOTES, UPDATED WARNING SIGNS	B.H.	A.A.A.
NO.	DATE	REVISIONS	BY	APP'D

KANSAS DEPARTMENT OF TRANSPORTATION  
TYPICAL TRAFFIC CONTROL  
FOUR-LANE UNDIVIDED HIGHWAY  
ONE-HALF ROADWAY CLOSED  
TE748 9/1/00

FHWA APPROVAL	8-8-07	APP'D	Anthony A. Alrobairé
DESIGNED	B.A.H.	DETAILED	B.A.H.
QUANTITIES	QUAN. CK.	TRACED	TRACE CK.

106