

DEETER #2433 GRATE

24" x 24" Frame and Grate Detail

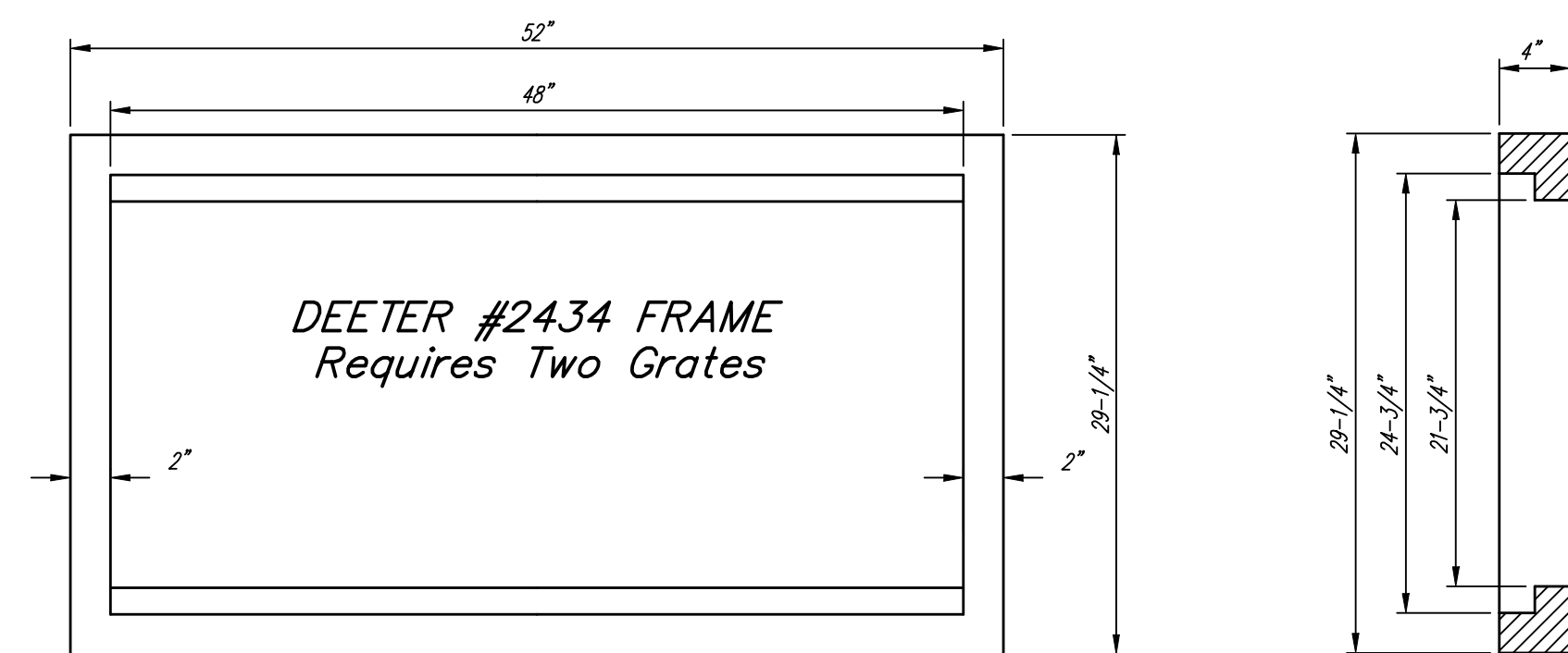

Double 24" x 24" Frame Detail

NOTE: Grates shall be imprinted on the top surface with "CITY OF WICHITA" using letters at least 1" in height. Other marking methods may be approved by the engineer.

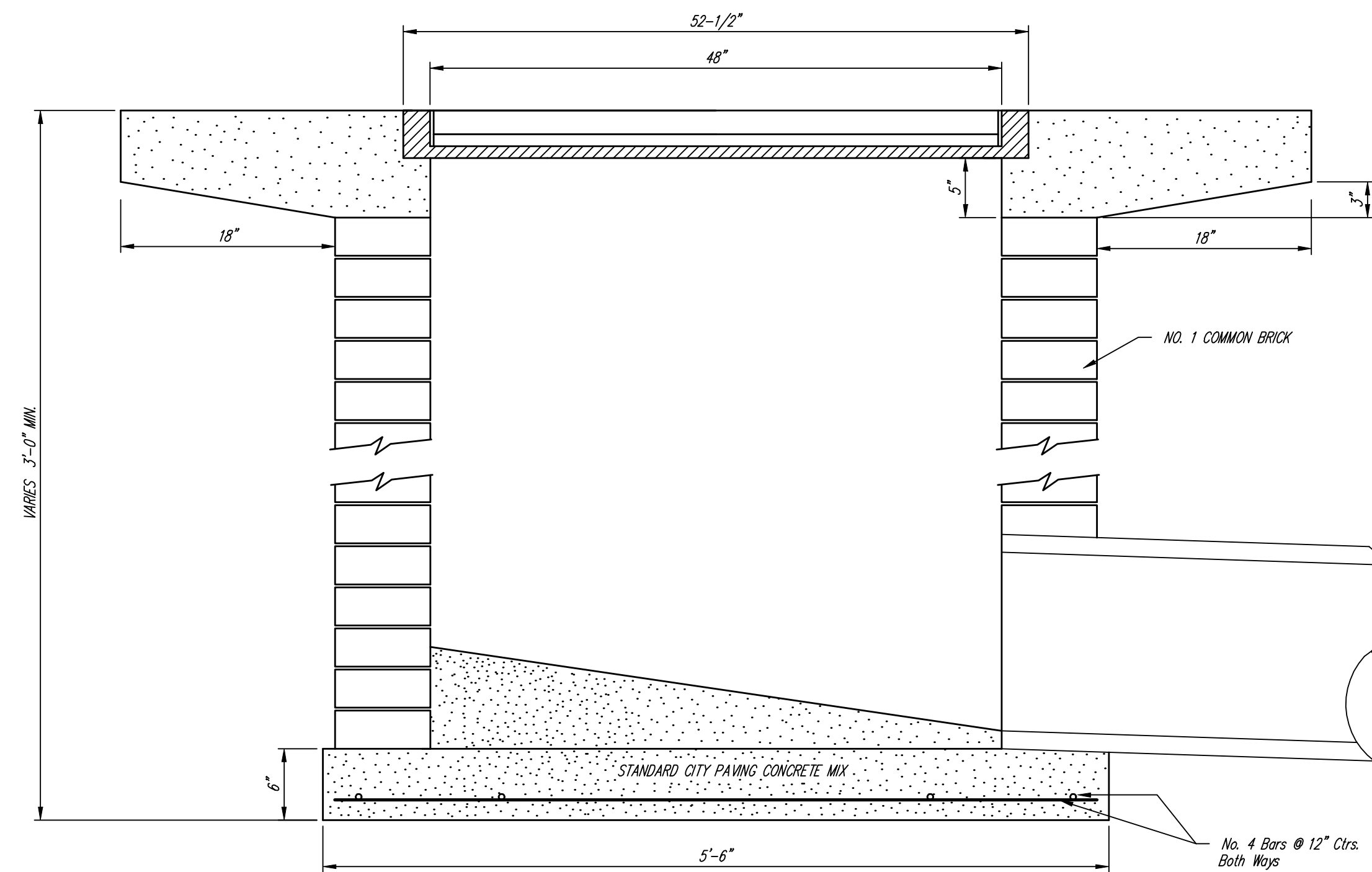
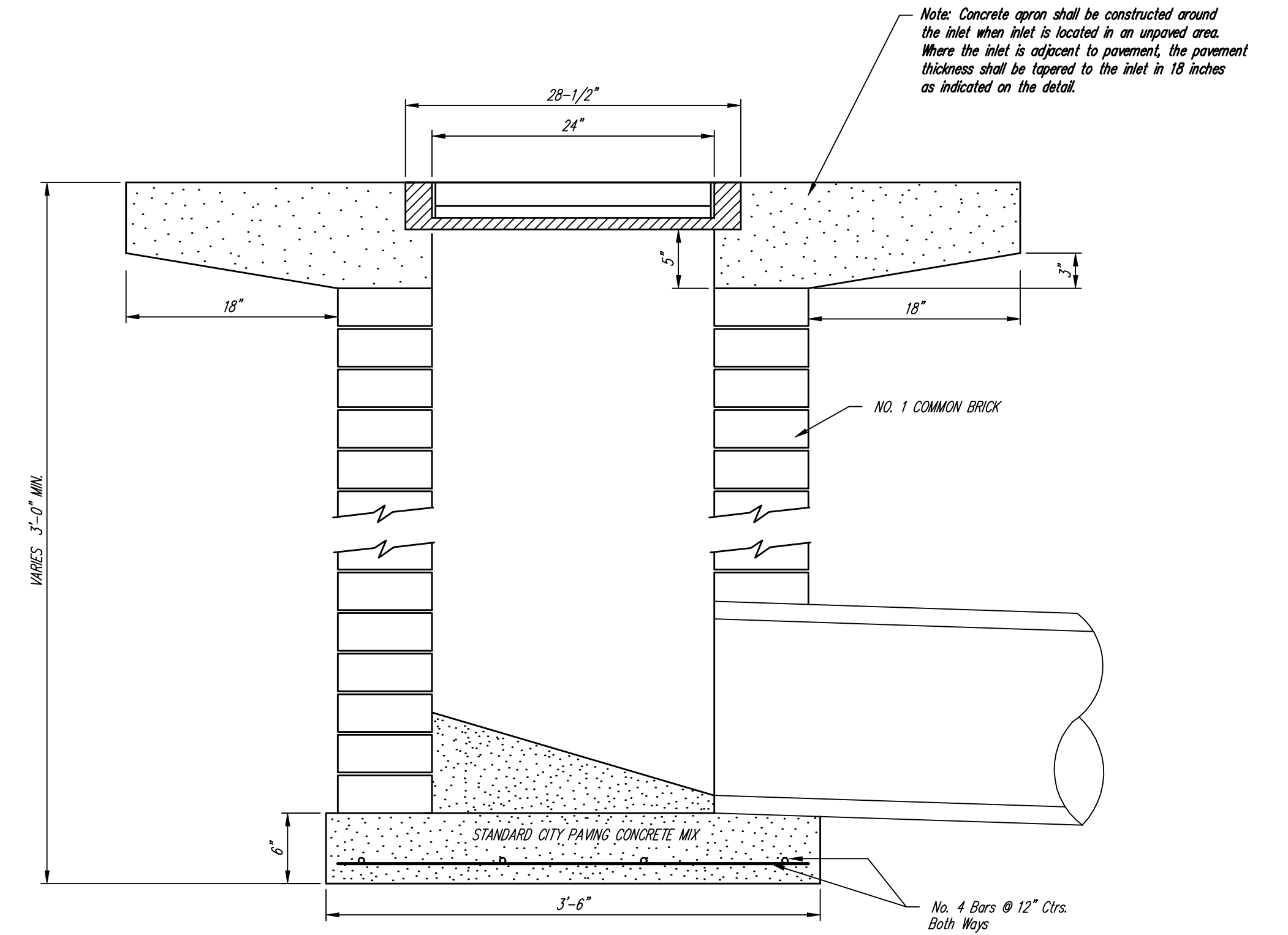
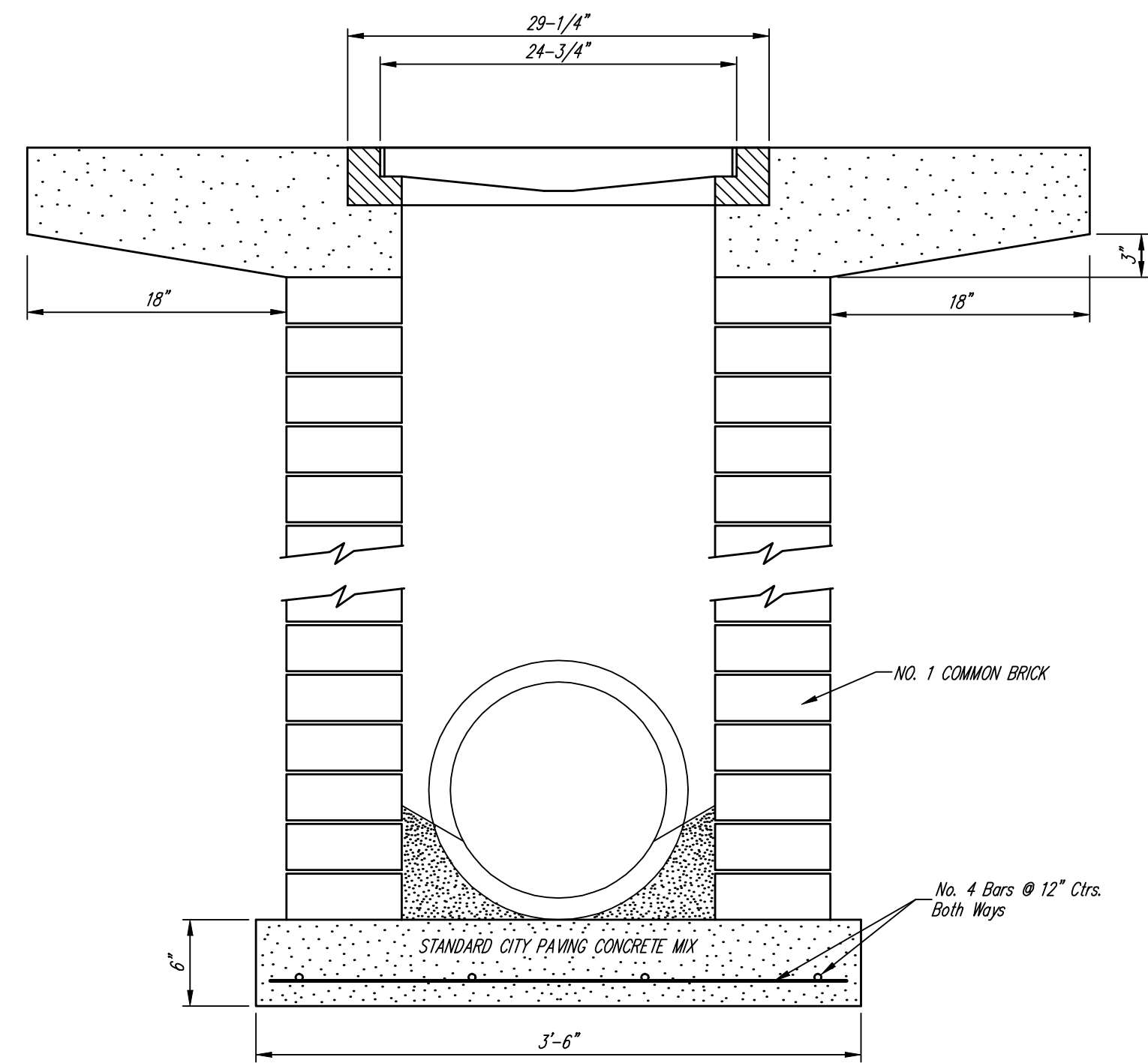

Note: Concrete apron shall be constructed around the inlet when inlet is located in an unpaved area. Where the inlet is adjacent to pavement, the pavement thickness shall be tapered to the inlet in 18 inches as indicated on the detail.

	City of Wichita Standard	
	Drop Inlet Detail	
<small>Baughman Company, P.A. 315 Ellis St. Wichita, KS 67211 P 316-262-7271 F 316-262-0149 ENGINEERING SURVEYING PLANNING LANDSCAPE ARCHITECTURE</small>		
PROJECT NUMBER 472-84820	DESIGN C.O.W.	DRAWN Staff
REVISIONS:	APPROVED	DATE
SCALE None		SHEET 15 OF 32
<small>\\Denits\Sewers\DROPINT2.rwg</small>		<small>08-10-E206</small>