

Reseed 440 L.F. According to General Note 19 as Measured Along the Sewer Line from Sta. 39+00 to Sta. 43+40.

SCALE:
1" = 40' Horizontal
1" = 5' Vertical

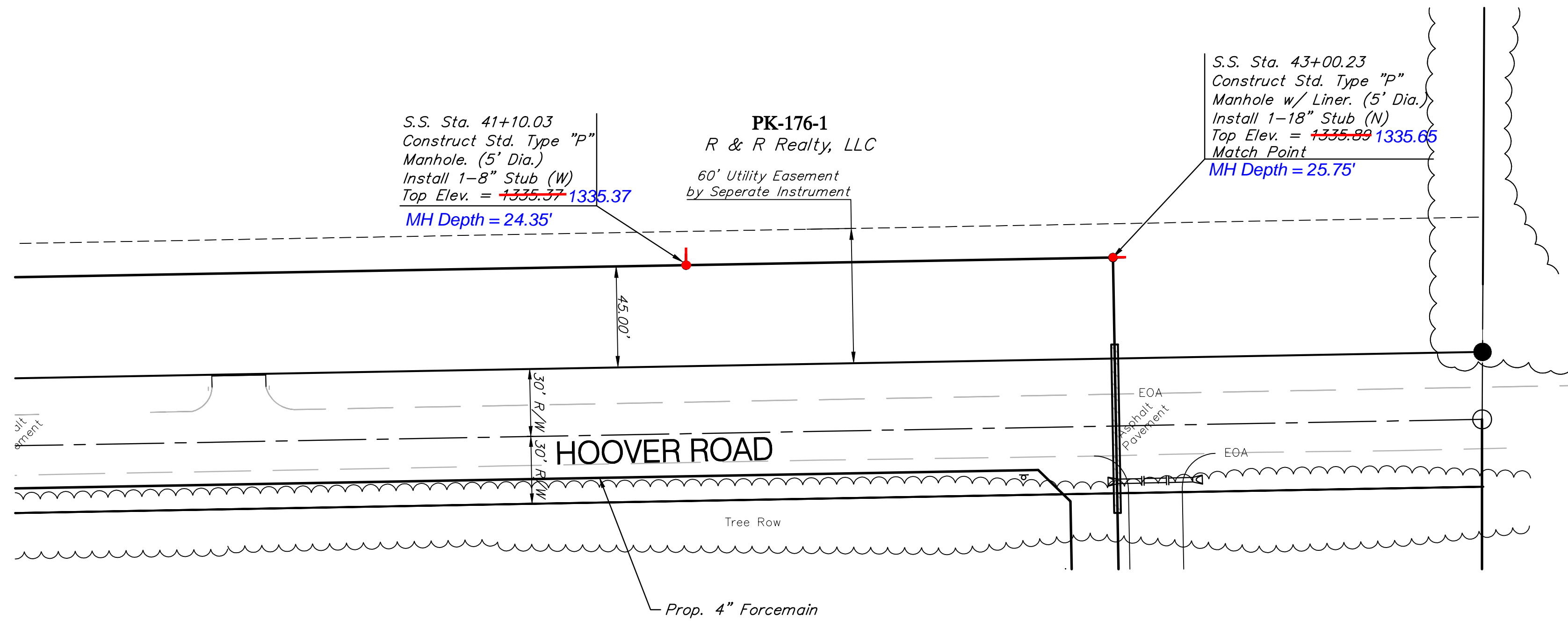

Reseed 240 L.F. According to General Note 19 as Measured Along the Sewer Line from Sta. 44+15 to Sta. 46+55.

CAUTION! Southern Star 16" Pipeline Crossing. Contractor to Contact Terry Blanding at 529-6622 at least 2 weeks prior to Construction.

SCALE:
1" = 40' Horizontal
1" = 5' Vertical

