

P.I. Southwest Corner Sec. 13, T27S, R1E
 1. Found Iron Pipe in Thimble
 2. 0.00' Rt., @ Sta. 9+99.93
 3. N -0.382, E 999.928
 4. No references set

P.I. South Quarter Corner, Sec. 13, T27S, R1E
 1. Found Iron Pipe in Thimble
 2. 0.00' Rt., @ Sta. 36+53.21
 3. N 0.00, E 3653.21
 4. No references set

STATE	PROJECT NO.	YEAR	SHEET NO.	SHEETS
KANSAS	87N-0135-01	2005	12	137

Sta. 27+08.06 Install
 Curb Inlet (Type 1A), 33.67' Lt.
 L=6'-4", W=4'-4"
 Inlet Top = 193.71
 Install 18" x 18.67'
 Storm Sewer (RCP)(S)
 See Sh. No. 13

Sta. 29+83.74, 199.06' Lt.
 Grub stump

Sta. 30+34.80 to Sta. 32+18.78
 Const. Conc. Pavement Widening, Lt. & Rt.
 See Sh. No. 32

Sta. 29+89.85 Install
 Conc. Valley Gutter, 28' Rt.
 See Sh. No. 32

Sta. 29+89.85 (Parkwood)
 Saw cut and match existing

Remove & Replace a portion
 of concrete driveway
 pavement as shown.

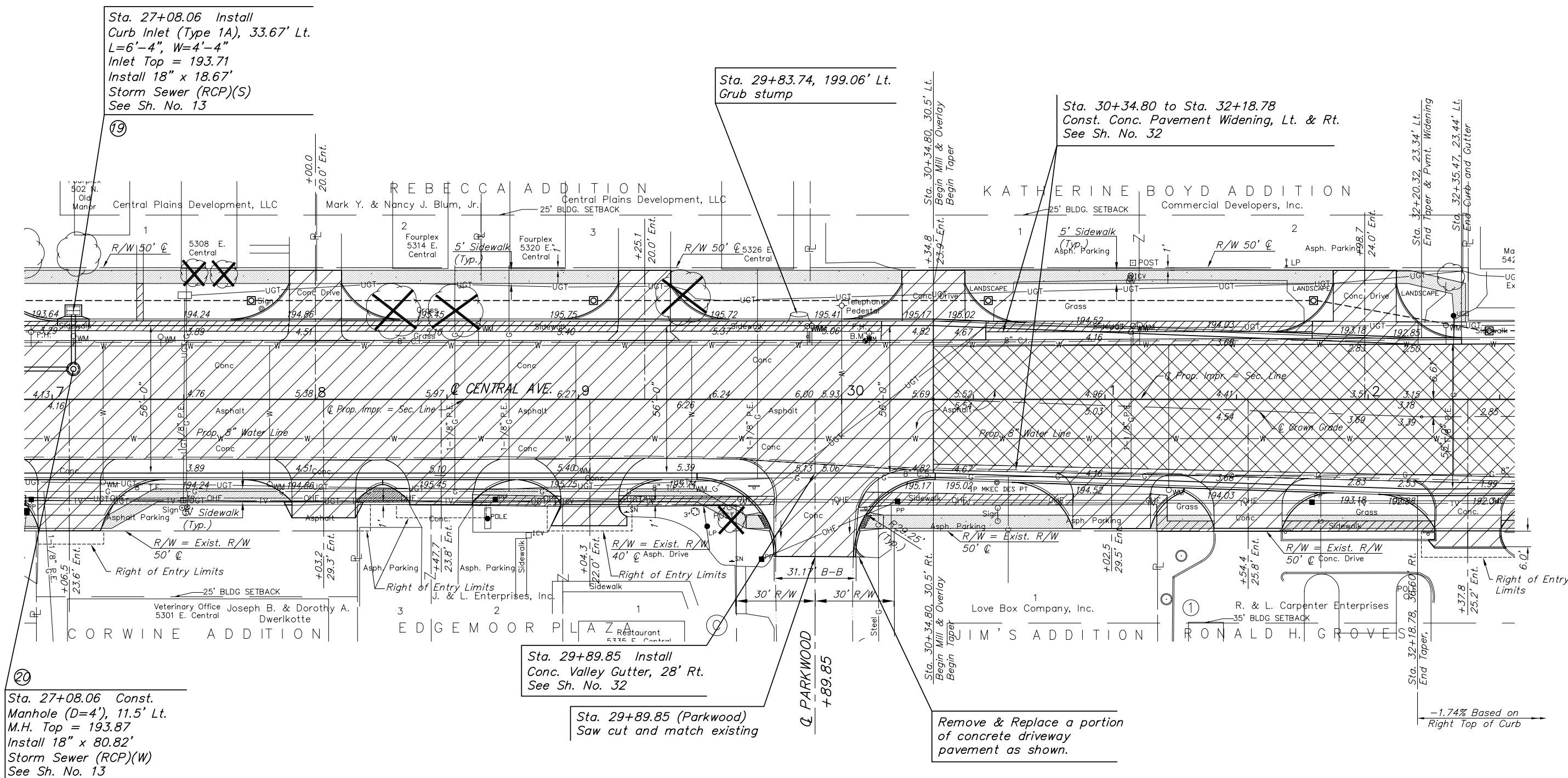

Sta. 27+08.06 Const.
 Manhole (D=4'), 11.5' Lt.
 M.H. Top = 193.87
 Install 18" x 80.82'
 Storm Sewer (RCP)(W)
 See Sh. No. 13

LEGEND

	Mill and Overlay
	Pavement Removal
	Trees to be Removed

UTILITIES

COX COMMUNICATIONS (CABLE)	262-0661
WESTAR (ELECTRIC)	261-6512
KANSAS GAS SERVICE (GAS)	832-3101
SBC (TELEPHONE)	800-870-8390
CITY OF WICHITA WATER & SEWER	262-6000
AQUILA (GAS)	946-0096

H:\CIVIL\03149\dwg\pave\03149PL4.dwg 02/28/2006 02:22:10 PM CST
 KANSAS DEPARTMENT OF TRANSPORTATION
STREET IMPROVEMENT PLAN
STA. 27+00 TO STA. 32+50
 PROJECT NO. 87N-0135-01 SEDGWICK CO.
 M K E C ENGINEERING CONSULTANTS, INC.
 WICHITA, KANSAS

DESIGNED BY: JRA	CHECKED BY: JRA
DRAWN BY: JSB, DPG	DATE: DEC. 2005 SHEET 12 OF 137