

P.I. Southwest Corner Sec. 13, T27S, R1E
 1. Found Iron Pipe in Thimble
 2. 0.00' Rt., @ Sta. 9+99.93
 3. N -0.382, E 999.928
 4. No references set

P.I. South Quarter Corner, Sec. 13, T27S, R1E
 1. Found Iron Pipe in Thimble
 2. 0.00' Rt., @ Sta. 36+53.21
 3. N 0.00, E 3653.21
 4. No references set

P.I. Southeast Corner, Sec. 13, T27S, R1E
 1. Found Thimble
 2. 0.00' Rt., @ Sta. 63+14.99
 3. N -1.43, E 6314.99
 4. No references set

STATE	PROJECT NO.	YEAR	SHEET NO.	SHEETS
KANSAS	87N-0135-01	2005	14	137

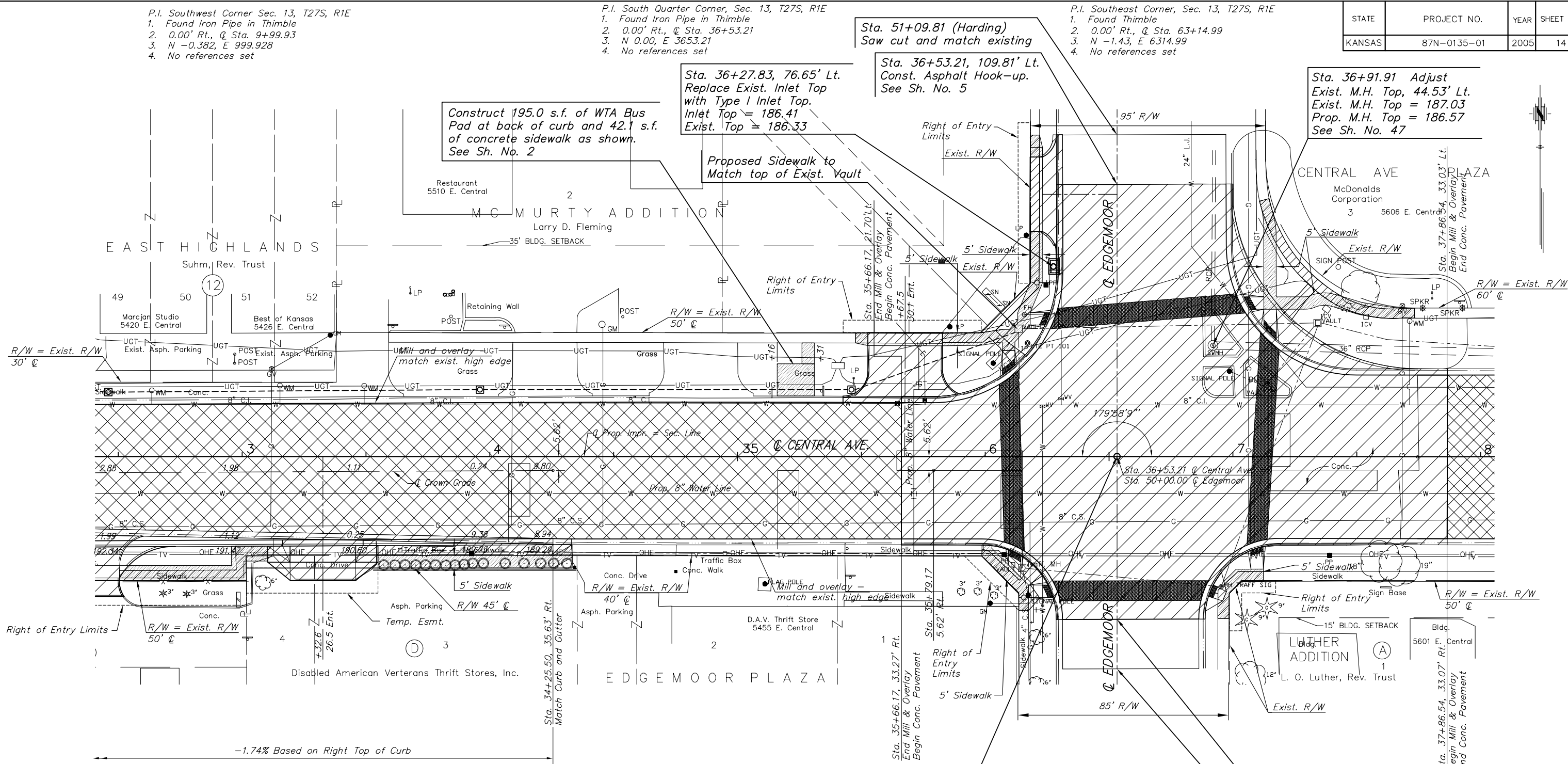

Construct 195.0 s.f. of WTA Bus Pad at back of curb and 42.1 s.f. of concrete sidewalk as shown. See Sh. No. 2

Sta. 36+27.83, 76.65' Lt. Replace Exist. Inlet Top with Type I Inlet Top. Inlet Top = 186.41 Exist. Top = 186.33

Sta. 51+09.81 (Harding) Saw cut and match existing

Sta. 36+53.21, 109.81' Lt. Const. Asphalt Hook-up. See Sh. No. 5

Sta. 36+91.91 Adjust Exist. M.H. Top, 44.53' Lt. Exist. M.H. Top = 187.03 Prop. M.H. Top = 186.57 See Sh. No. 47

Sta. 35+66.17 to Sta. 37+74.54 Const. 9" Conc. Pavement. See Sh. No. 26

Sta. 49+14.33 (Harding) Saw cut and match existing

Sta. 36+53.21, 65.67' Rt. Const. Asphalt Hook-up. See Sh. No. 5

NOTE: Contractor shall remove all existing signal poles and traffic manholes unless otherwise specified to remain. See Sht. 88 for proposed traffic signal plan

UTILITIES		LEGEND	
COX COMMUNICATIONS (CABLE)	262-0661		Mill and Overlay
WESTAR (ELECTRIC)	261-6512		Pavement Removal
KANSAS GAS SERVICE (GAS)	832-3101		Trees to be Removed
SBC (TELEPHONE)	800-870-8390		
CITY OF WICHITA WATER & SEWER	262-6000		
AQUILA (GAS)	946-0096		

H:\CIVIL\03149\dwg\pave\03149PL5.DWG 02/28/2006 02:18:08 PM CST
 KANSAS DEPARTMENT OF TRANSPORTATION
STREET IMPROVEMENT PLAN
STA. 32+50 TO STA. 38+00
 PROJECT NO. 87N-0135-01 SEDGWICK CO.
 M K E C ENGINEERING CONSULTANTS, INC.
 WICHITA, KANSAS

DESIGNED BY: JRA	CHECKED BY: JRA
DRAWN BY: JSB, DPG	DATE: DEC. 2005 SHEET 14 OF 137