

P.I. South Quarter Corner, Sec. 13, T27S, R1E  
 1. Found Iron Pipe in Thimble  
 2. 0.00' Rt., @ Sta. 36+53.21  
 3. N 0.00, E 3653.21  
 4. No references set

P.I. Southeast Corner, Sec. 13, T27S, R1E  
 1. Found Thimble  
 2. 0.00' Rt., @ Sta. 63+14.99  
 3. N -1.43, E 6314.99  
 4. No references set

STATE	PROJECT NO.	YEAR	SHEET NO.	SHEETS
KANSAS	87N-0135-01	2005	20	137

Sta. 50+62.13 Adjust  
 Exist. Inlet Top, Lt.  
 Exist. Top = 179.82  
 Prop. Top = 180.22

Sta. 50+54.91 Adjust  
 Exist. Inlet Top, Lt.  
 Exist. Top = 179.72  
 Prop. Top = 180.09

Sta. 50+60.51 Adjust  
 Exist. M.H. Top, 15.41' Lt.  
 Exist. M.H. Top = 180.15  
 Prop. M.H. Top = 180.73  
 See Sh. No. 47

Sta. 54+21.70 Adjust  
 Exist. M.H. Top, 15.90' Lt.  
 Exist. M.H. Top = 186.97  
 Prop. M.H. Top = 187.87  
 See Sh. No. 47

Sta. 54+22.22 Adjust  
 Exist. Inlet Top, Lt.  
 Exist. Top = 186.83  
 Prop. Top = 187.36

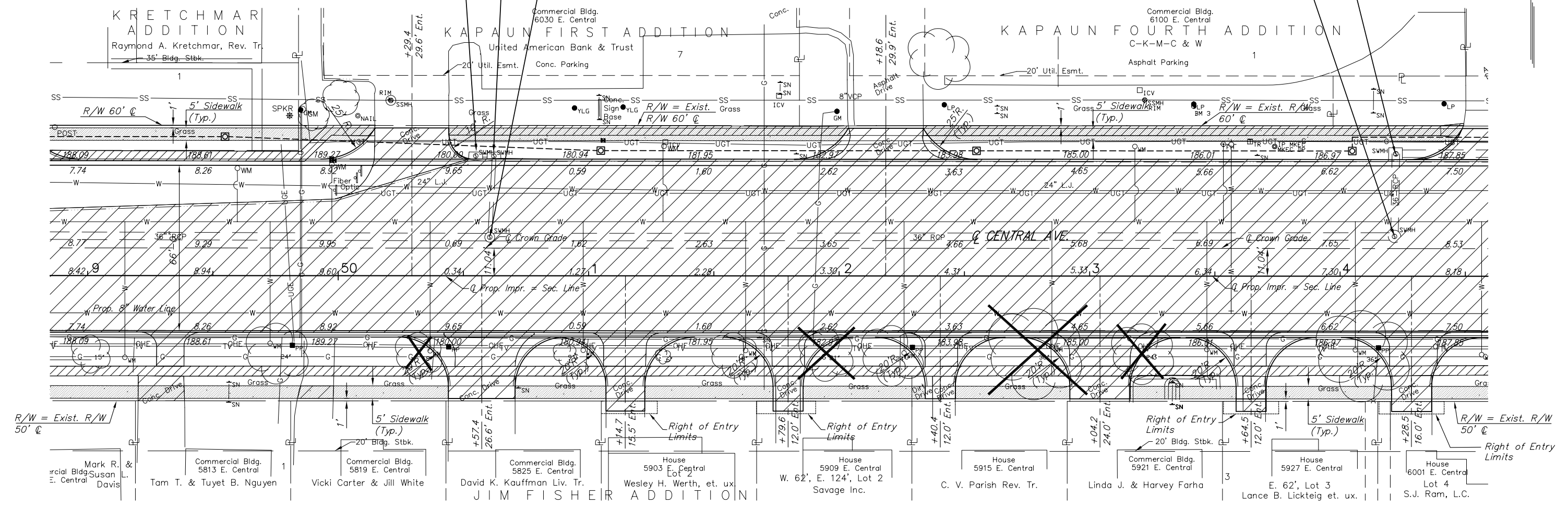

**LEGEND**

	Mill and Overlay
	Pavement Removal
	Trees to be Removed

**UTILITIES**

COX COMMUNICATIONS (CABLE)	262-0661
WESTAR (ELECTRIC)	261-6512
KANSAS GAS SERVICE (GAS)	832-3101
SBC (TELEPHONE)	800-870-8390
CITY OF WICHITA WATER & SEWER	262-6000
AQUILA (GAS)	946-0096

BM #3: "□" in lightpole  
 Sta. 53+41.55, 67.87' Lt. Elev. = 187.08

H:\CIVIL\03149\dwg\pave\03149PL8.DWG 5/30/2006 8:58:07 AM CST  
 KANSAS DEPARTMENT OF TRANSPORTATION  
**STREET IMPROVEMENT PLAN**  
**STA. 49+00 TO STA. 54+50**  
 PROJECT NO. 87N-0135-01 SEDGWICK CO.  
 M K E C ENGINEERING CONSULTANTS, INC.  
 WICHITA, KANSAS

DESIGNED BY: JRA	CHECKED BY: JRA
DRAWN BY: JSB, DPG	DATE: DEC. 2005 SHEET 20 OF 137