

P.I. South Quarter Corner, Sec. 13, T27S, R1E  
 1. Found Iron Pipe in Thimble  
 2. 0.00' Rt., @ Sta. 36+53.21  
 3. N 0.00, E 3653.21  
 4. No references set

P.I. Southeast Corner, Sec. 13, T27S, R1E  
 1. Found Thimble  
 2. 0.00' Rt., @ Sta. 63+14.99  
 3. N -1.43, E 6314.99  
 4. No references set

STATE	PROJECT NO.	YEAR	SHEET NO.	SHEETS
KANSAS	87N-0135-01	2005	24	137

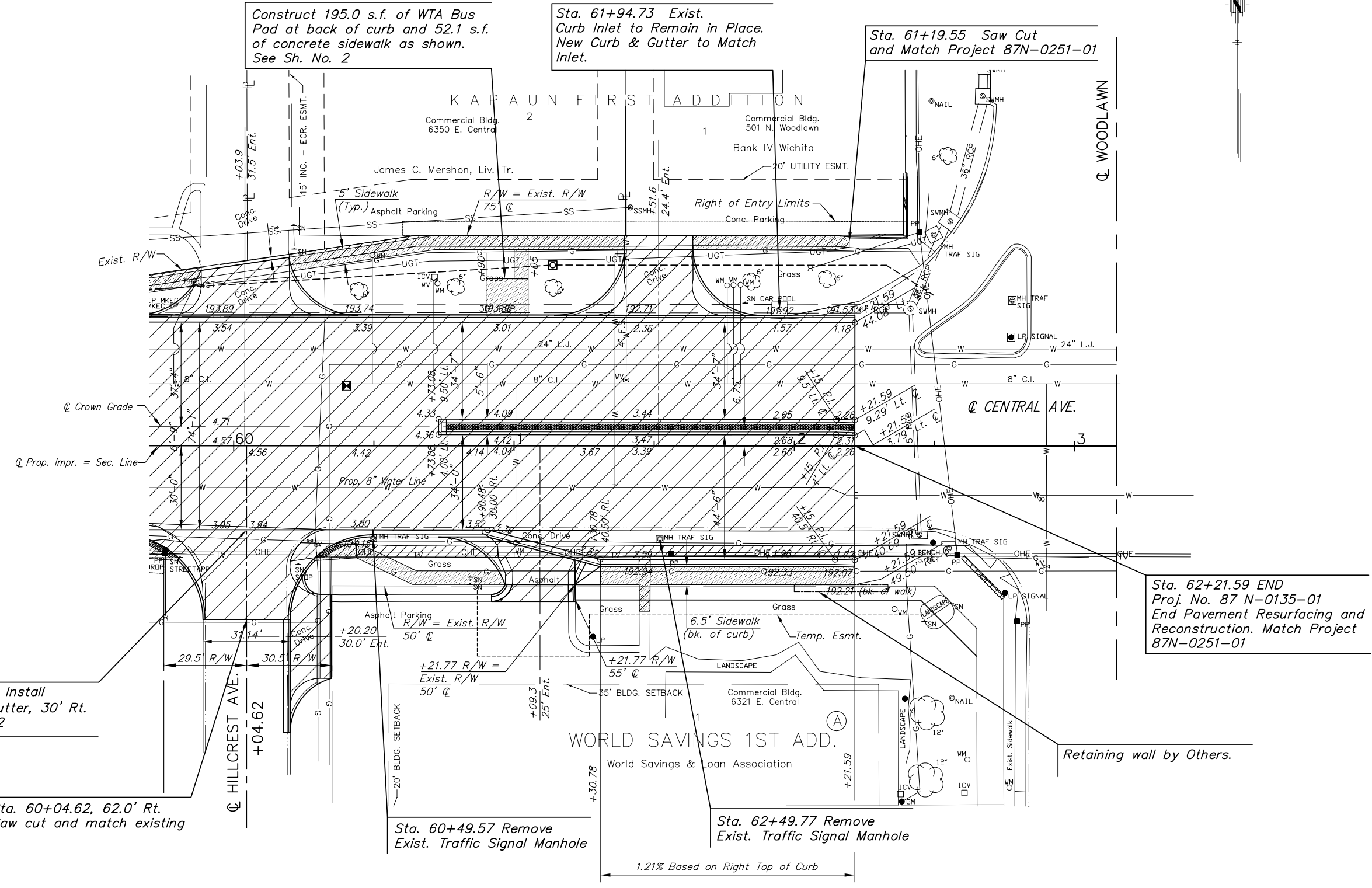

Construct 195.0 s.f. of WTA Bus Pad at back of curb and 52.1 s.f. of concrete sidewalk as shown. See Sh. No. 2

Sta. 61+94.73 Exist. Curb Inlet to Remain in Place. New Curb & Gutter to Match Inlet.

Sta. 61+19.55 Saw Cut and Match Project 87N-0251-01

Sta. 60+04.62 Install Conc. Valley Gutter, 30' Rt. See Sh. No. 32

Sta. 60+04.62, 62.0' Rt. Saw cut and match existing

Sta. 60+49.57 Remove Exist. Traffic Signal Manhole

Sta. 62+49.77 Remove Exist. Traffic Signal Manhole

Sta. 62+21.59 END Proj. No. 87 N-0135-01 End Pavement Resurfacing and Reconstruction. Match Project 87N-0251-01

LEGEND

UTILITIES

COX COMMUNICATIONS (CABLE)	262-0661
WESTAR (ELECTRIC)	261-6512
KANSAS GAS SERVICE (GAS)	832-3101
SBC (TELEPHONE)	800-870-8390
CITY OF WICHITA WATER & SEWER	262-6000
AQUILA (GAS)	946-0096

- Mill and Overlay
- Pavement Removal
- Trees to be Removed

H:\CIVIL\03149\dwg\pave\03149PL10.DWG 02/28/2006 02:33:34 PM CST  
 KANSAS DEPARTMENT OF TRANSPORTATION  
**STREET IMPROVEMENT PLAN**  
**STA. 60+00 TO STA. 65+00**  
 PROJECT NO. 87N-0135-01 SEDGWICK CO.  
 M K E C ENGINEERING CONSULTANTS, INC.  
 WICHITA, KANSAS

DESIGNED BY: JRA	CHECKED BY: JRA
DRAWN BY: JSB, DPG	DATE: DEC. 2005 SHEET 24 OF 137