

INTRUST BANK ARENA PARKING LOT B BROADWAY AND WILLIAM

LOT 'B' NOTES

1. The Bid item for "DMS Foundation" shall include the items on sheet B9 of these plans and any additional work required due to existing utilities. Conduit installation shall be coordinated with the electrical contractor.
2. All pavement markings shall be thermoplastic. Pavement markings shall be installed per manufacturer's recommendations and shall meet KDOT 2007 Standard Specifications for State Road and Bridge Construction.
3. All Disturbed areas are to be resodded to match existing sod, except in medians called out to be mulched. All landscaping, sodding and mulch shall be subsidiary to the bid item for "Landscaping".

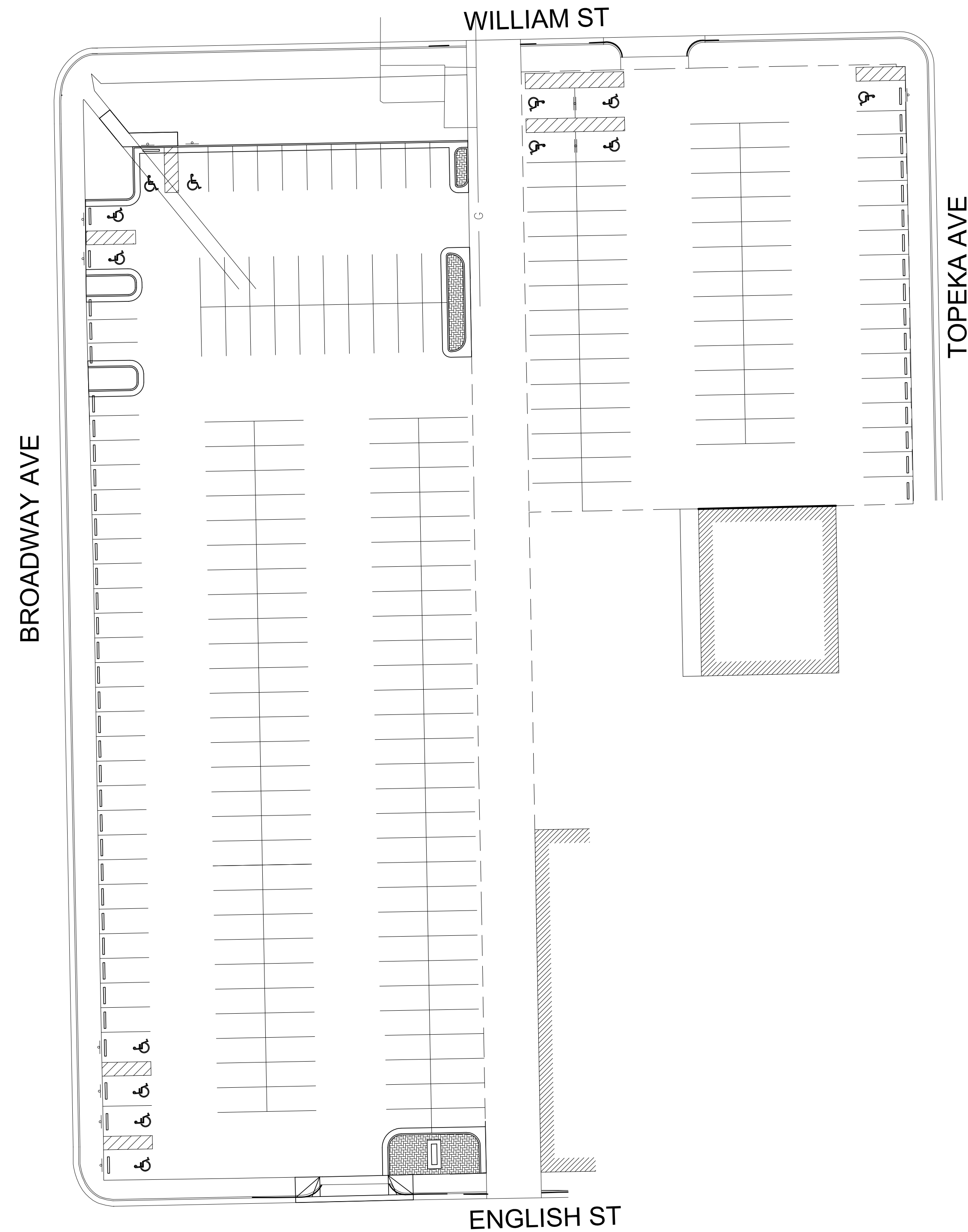

Scale: 1" = 100'

INDEX OF SHEETS

- | | |
|-------|---------------------------|
| B1. | TITLE SHEET |
| B2. | GRADING PLANS |
| B3. | STRIPING PLANS |
| B4. | PATCHING PLAN |
| B5. | DRIVEWAY DETAIL |
| B6-8. | ELECTRICAL DETAILS |
| B9. | D.M.S. FOUNDATION DETAILS |

BENCHMARKS

NGS DISC #A237 10.4' S. OF N.W. CORNER OF UNION STATION.
ELEVATION = 1317.08 (NAVD88)

□ CUT IN CURB AT EAST END OF SOUTHEAST RETURN OF BROADWAY AND WILLIAMS.
ELEVATION =

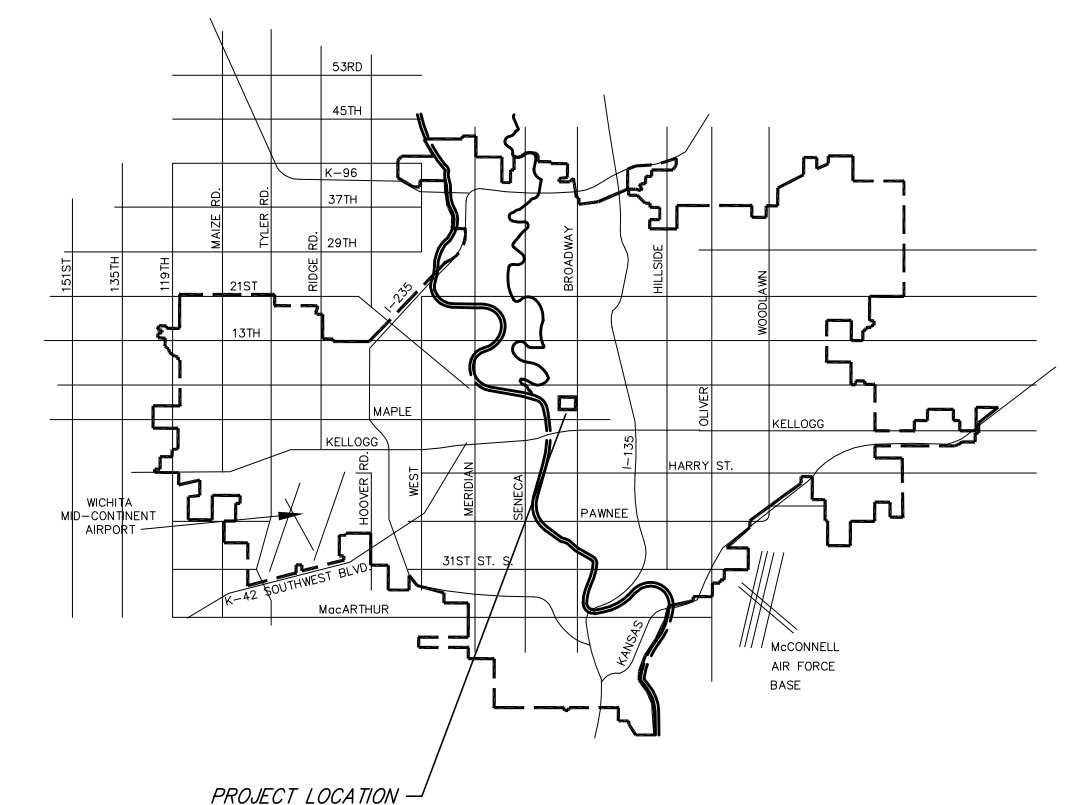

VICINITY MAP

CITY OF WICHITA, KANSAS
JAMES ARMOUR, P.E. - CITY ENGINEER

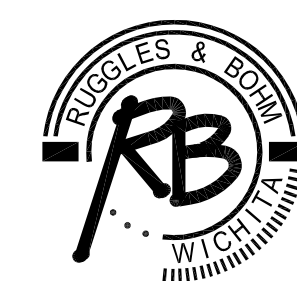

Ruggles & Bohm, P.A.
Engineering, Surveying, Land Planning
924 North Main (316) 264-8008
Wichita, Kansas 67203 (316) 264-4621 fax
www.rbkansas.com E-mail: info@rbkansas.com