

WILLIAM ST.

NOTE: Contractor to grade away from back of proposed curb @ 4:1 Slope.

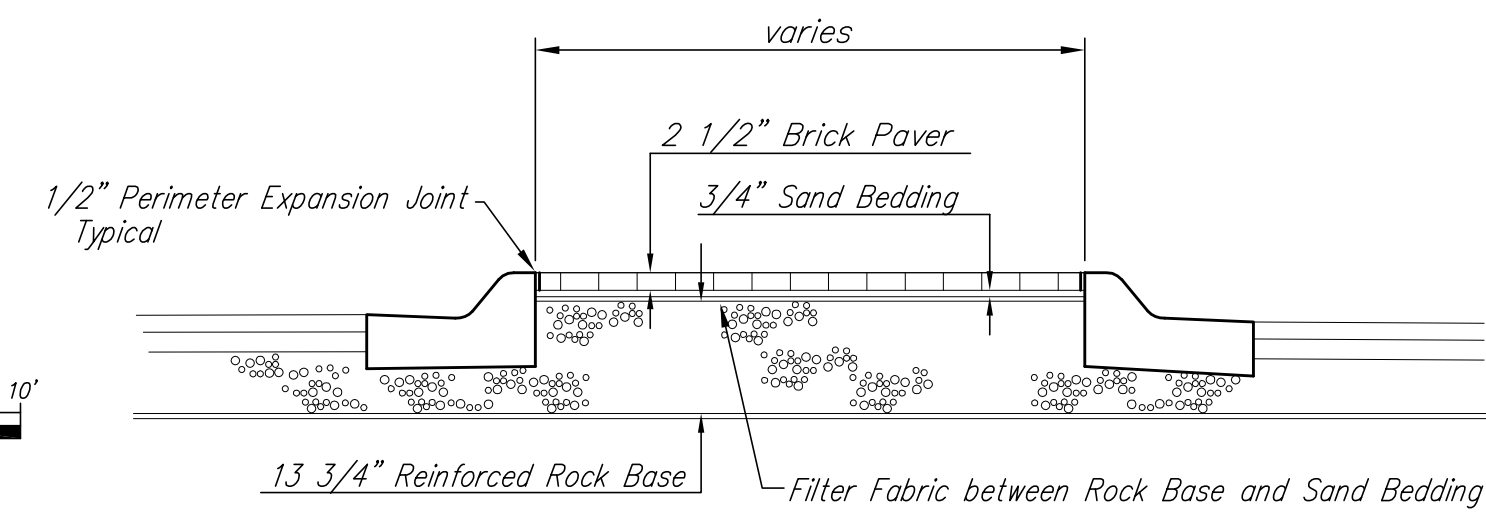
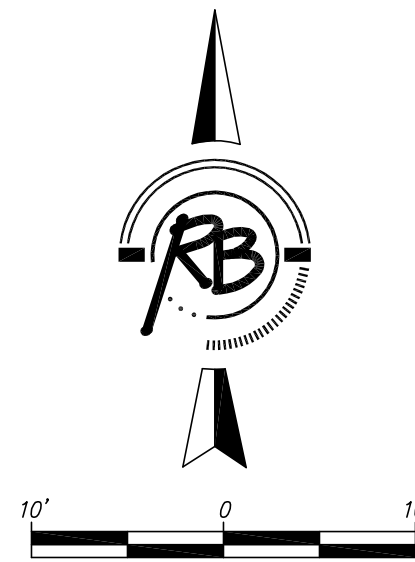

**BRICK PAVER SURFACE DETAIL**

NOTE: Construction of the interlocking precast concrete paving stones shall conform to special provision 90P-3956.

**BRICK PAVER NOTES**

PAVERS TO BE USED IN ALL AREAS SHALL BE NEW BRICK PAVERS AND SHALL HAVE A MINIMUM COMPRESSIVE STRENGTH OF 8000 PSI. A WATER ABSORPTION MAXIMUM OF 5% AND MEET OR EXCEED ASTM C-936-82 AND FREEZE-THAW TESTING PER SECTION 8 OF ASTM C-67-73.

BRICK PAVERS SHALL BE "TERRA-COTTA" COLOR IN "90" HERRINGBONE" PATTERN AS MANUFACTURED BY BARBOUR CONCRETE PAVERS OR APPROVED EQUAL.

A 3/4" BEDDING COURSE OF SAND SHALL BE PLACED ON THE COMPACTED ROCK BASE. THE SAND SHALL BE LOOSELY SCREENED, NOT COMPACTED, BEFORE PLACEMENT OF THE PAVERS. THE PAVERS SHALL BE LAID WITH 1/8" JOINTS, THEN LEVELED AND BEDDED USING A PLATE VIBRATOR. EXCESS SAND SHALL BE SWEEPED OFF AFTER VIBRATING. SAND SHALL BE AS SPECIFIED IN SUPPLEMENTAL SPECIFICATIONS.

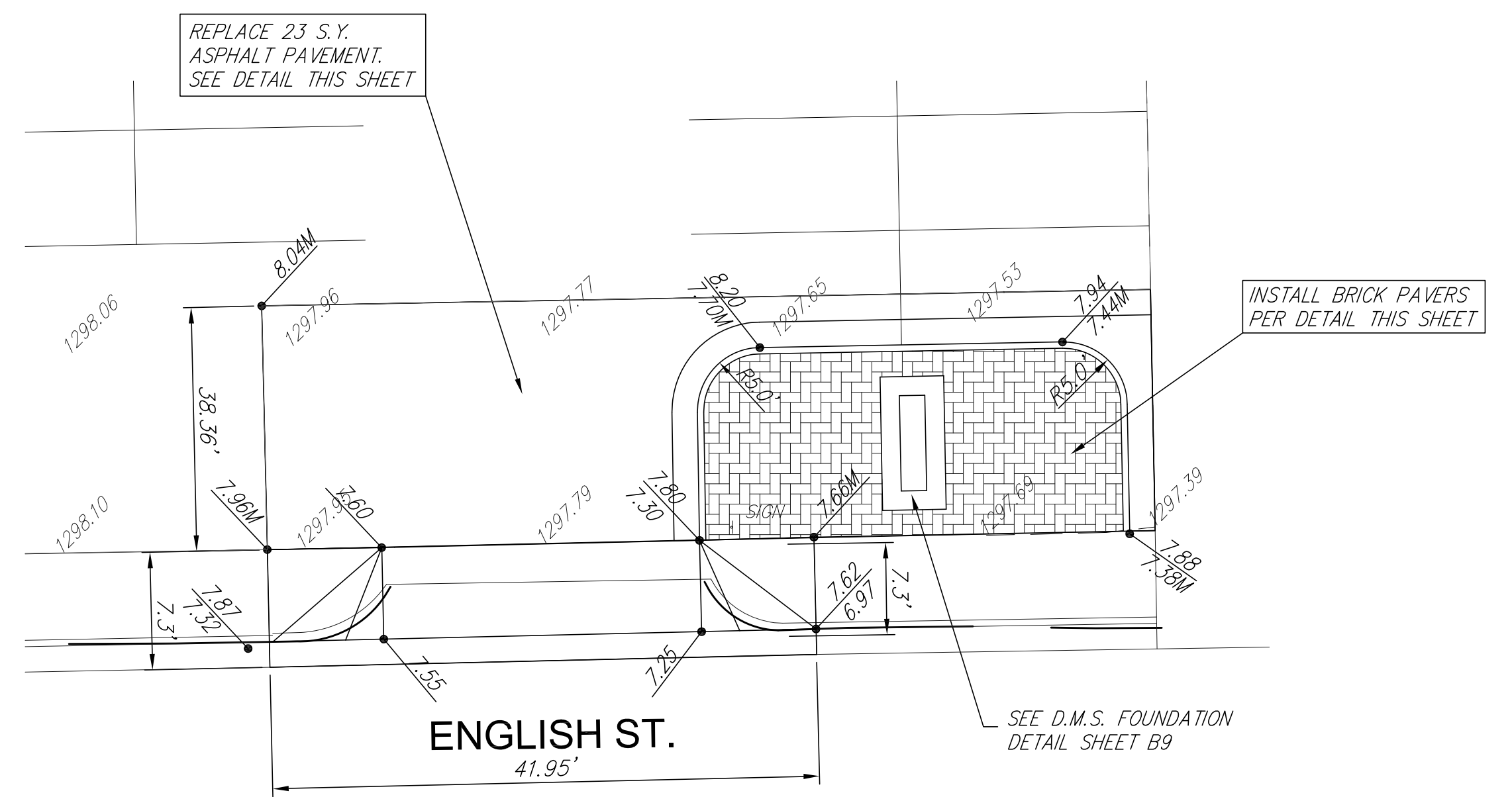

**DRIVEWAY DETAIL**

(See Sheet \_\_ for Details)

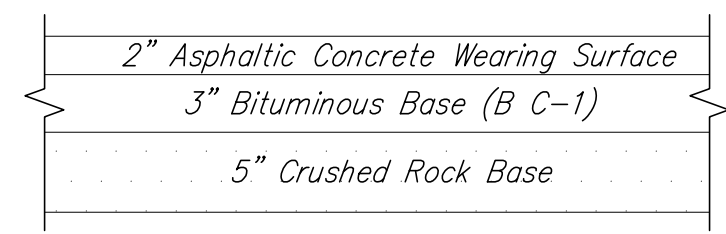
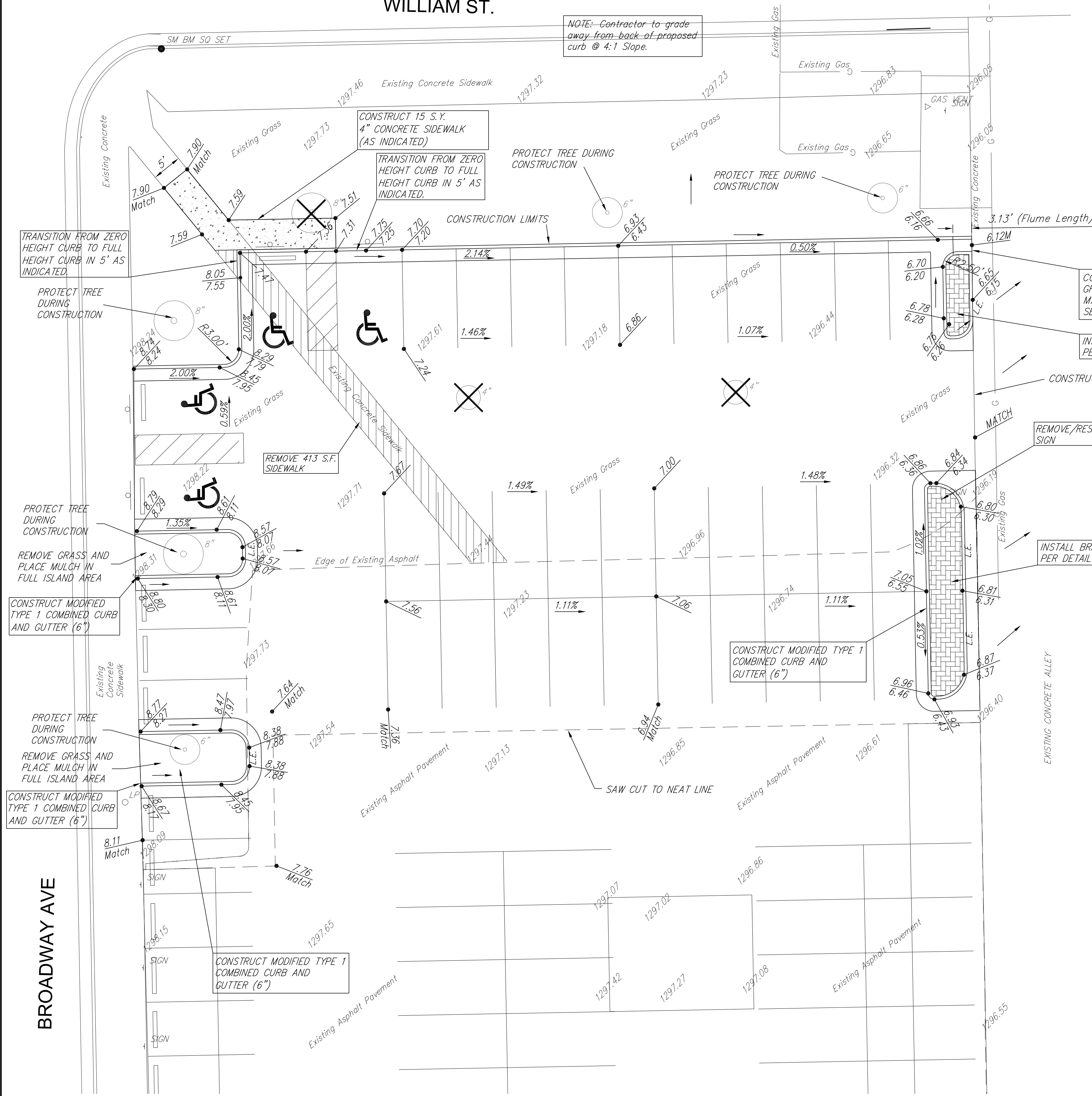

NEW ASPHALT CROSS SECTION (TYP.)

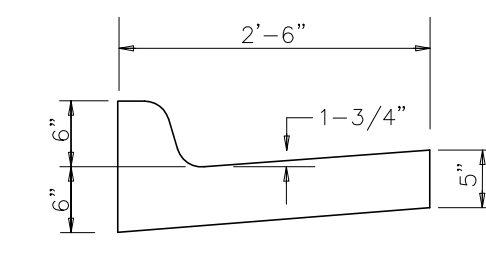

STATE CURB MODIFIED TYPE 1 COMBINED CURB & GUTTER

NOTE: ALL CURB IS TO BE MODIFIED TYPE 1 COMBINED CURB AND GUTTER (6")

REMOVE TREE  
L.E. = Low Edge of Gutter

**GRADING PLAN  
BROADWAY PARKING LOT  
WICHITA, KANSAS**

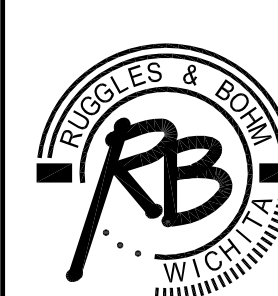

Ruggles & Bohm, P.A.  
Engineering, Surveying, Land Planning  
924 North Main  
Wichita, Kansas 67203  
(316) 264-8008  
www.rbkansas.com  
(316) 264-4621 fax  
E-mail: info@rbkansas.com

DESIGN	KWL	ROW	3420T
DRAWN	RLS	SHEET	B2
REVIEW		OF	B9
UTILITY		DATE	

DRAWING FILE: Eng Base b1 { }