

NOTE: TREES SHALL BE REMOVED AS INDICATED. TREES ALONG WEST PROPERTY LINE SHALL BE TRIMMED AS NECESSARY FOR CONSTRUCTION.

BRICK PAVER NOTES

PAVERS TO BE USED IN ALL AREAS SHALL BE NEW BRICK PAVERS AND SHALL HAVE A MINIMUM COMPRESSIVE STRENGTH OF 8000 PSI, A WATER ABSORPTION MAXIMUM OF 5% AND MEET OR EXCEED ASTM C-936-82 AND FREEZE-THAW TESTING PER SECTION 8 OF ASTM C-67-73.

BRICK PAVERS SHALL BE "TERRA-COTTA" COLOR IN A "RUNNING BOND" PATTERN AS MANUFACTURED BY BARBOUR CONCRETE PAVERS OR APPROVED EQUAL.

A 1" BEDDING COURSE OF SAND SHALL BE PLACED ON THE REINFORCED CONCRETE PAVEMENT. THE SAND SHALL BE LOOSELY SCREENED, NOT COMPACTED, BEFORE PLACEMENT OF THE PAVERS. THE PAVERS SHALL BE LAID WITH 1/8" JOINTS, THEN LEVELED AND BEDDED USING A PLATE VIBRATOR. EXCESS SAND SHALL BE SWEEPED OFF AFTER VIBRATING. SAND SHALL BE AS SPECIFIED IN SUPPLEMENTAL SPECIFICATIONS.

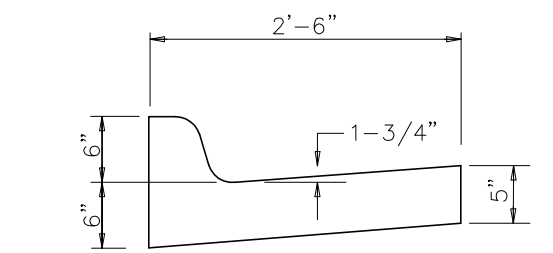

STATE CURB MODIFIED TYPE 1 COMBINED CURB & GUTTER

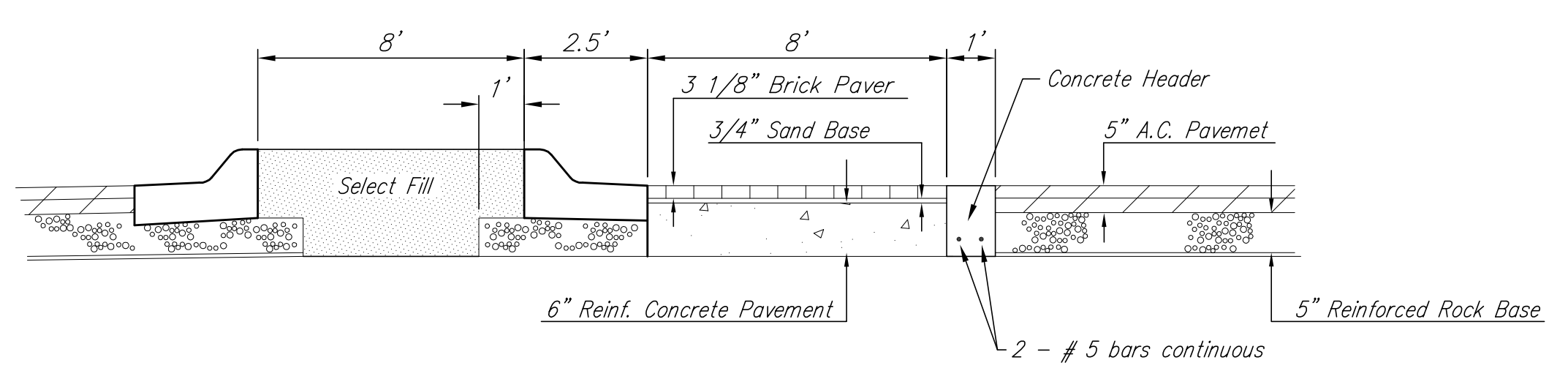

BRICK PAVER SURFACE DETAIL



TREE TO BE REMOVED

**INTRUST ARENA PARKING LOT D
PAVING PLAN
WICHITA, KANSAS**

	Ruggles & Bohm, P.A. Engineering, Surveying, Land Planning		DESIGN KWL DRAWN RA REVIEW RA
	924 North Main Wichita, Kansas 67203 www.rbkansas.com	(316) 264-8008 (316) 264-4621 fax E-mail: info@rbkansas.com	PROJECT NUMBER DATE
DRAWING FILE			SHEET D3 OF D15