

LEGEND:

- 1300.0 = Proposed Grade (See "Site Grading Plan", Sht. 2)
- 1300 = Existing Contours (1'-ft. Interval)

BENCHMARKS & SURVEY NOTES:

- Bench Mark: "□" on S.E. corner of concrete pad of main building pad on south side of building. Elev. 1301.56 (NGVD 29)
- Bench Mark: Cross cut in concrete 6.8'S and 0.8'W of the S.E. corner of Lot 12, Hinton's Subdivision of a Part of East Wichita, Kansas. Elev. 1298.96 (NGVD 29)

As-Built Drawing
7/27/09

UNLESS OTHERWISE NOTED, ELEVATIONS SHOWN ARE TO FLOWLINE OF PIPE

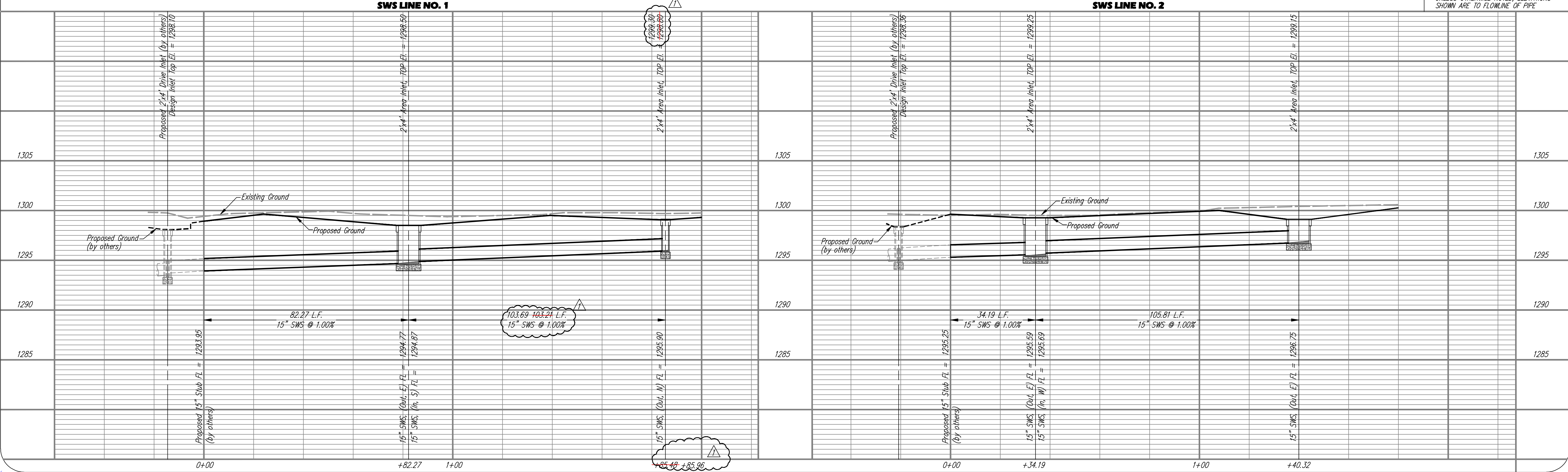

**15" STORM SEWER LINE NO. 1 AND LINE NO. 2
PLAN & PROFILE**

scale: as noted
 drawn by: els
 checked by: cry
 date: 3/30/09
 P/N: 08-258
 revisions:
 As-Built, 7/27/09
 As-Built, 8/17/09

Sheet No.
3 of 5

YOUNG & ASSOCIATES, P.A.
 Professional Civil Engineering Consultants
 100 S. Georgia, Derby, KS 67037
 Tel: (316)788-2552, fax: (316)788-4408
 email: engineering@yngpa.com

Copyright 2009, by Young & Associates, P.A., all rights reserved. Prepared in the United States of America. This document, or parts thereof, or design concepts contained herein, are deemed confidential and proprietary information of Young & Associates, P.A., and may not be reproduced, stored in a retrieval system, or transmitted in any form or by any means, electronic, mechanical, photocopying, recording, or by any information storage and retrieval system, without the prior written permission of Young & Associates, P.A. The delivery of the original or copies thereof does not constitute publication thereof.