

PAVING & INCIDENTAL DRAINAGE PLANS
MONARCH LANDING SECOND ADDITION
PHASE 2 PART B

LINES 1 & 2
SHEET TITLE
472-84613
PROJECT NUMBER

DFL
DESIGN BY
DM
DRAWN BY
GJA
CHECKED BY

ISSUED
August 2009
REVISED

SHEET NO.
13 of 27

RESERVE "A"
NORMAL POOL
= 1365.0
INSTALL 10.0 S.Y. OF LIGHT
STONE RIP-RAP W/GROUTED
STONE TOEWALL (6'x4'x2')

STA. 10+00.0, LINE 1
INSTALL 24" END SECTION

STA. 10+32.0, LINE 1
CONST. (4.5'x4.5'x1')
CONC. COLLAR

STA. 10+52.9, LINE 1
CONST. SHALLOW TYPE "A"
MANHOLE (5' DIA.)
MANHOLE TOP=1368.3

EXISTING SSMH
MH TOP=1367.4
FL IN=1359.47
FL OUT=1359.37

STA. 11+79.7, LINE 1
INSTALL TYPE 1A CURB INLET
(5'x3')
INLET TOP=1370.46
PROVIDE SEDIMENT BARRIER

STA. 10+00.0, LINE 2=
MANHOLE (6' DIA.)
MANHOLE TOP=1368.9

EXISTING SSMH
MH TOP=1367.7
FL IN=1359.81
FL OUT=1359.48

STA. 10+63.7, LINE 2
CONST. SPECIAL SHALLOW
TYPE "A" MANHOLE (4' DIA.)
WITH DEETER FRAME &
GRATE NO. 1927 OR
APPROVED EQUAL
MANHOLE TOP=1367.8
PROVIDE SEDIMENT BARRIER

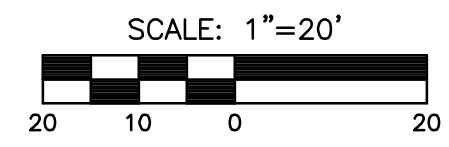

PLAN LINE 1

PLAN LINE 2

PROFILE LINE 1

PROFILE LINE 2

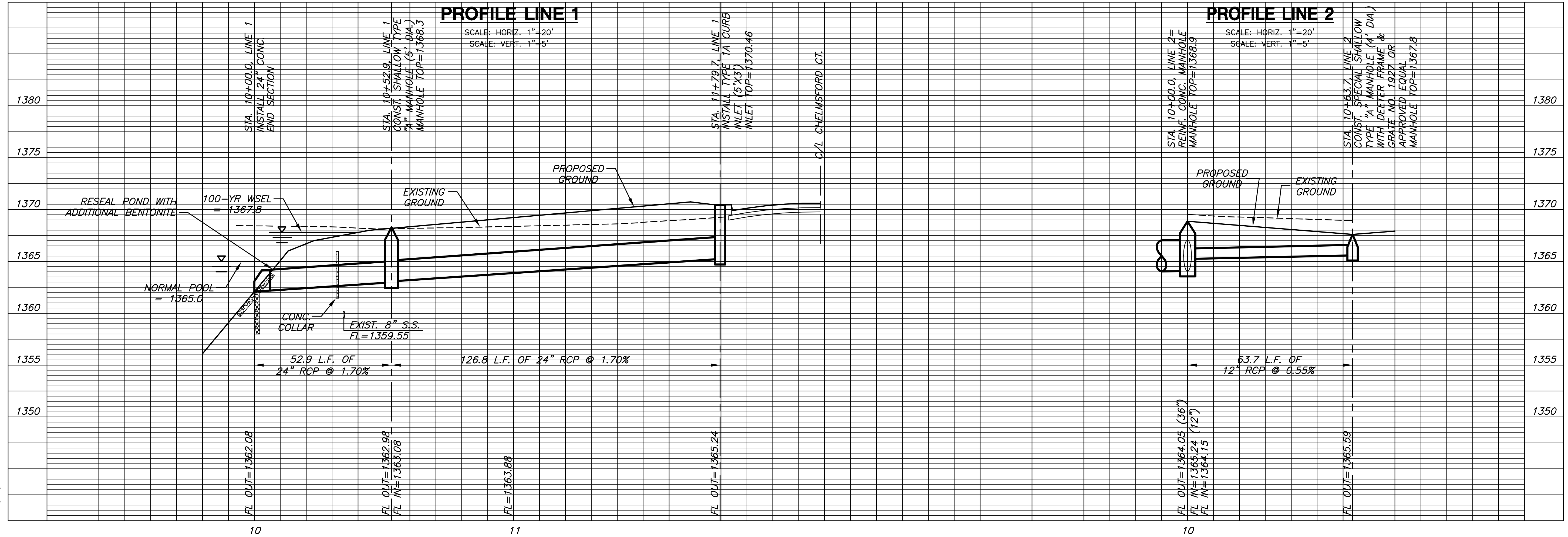

PLOTED: Tuesday, August 25, 2009 @ 01:26PM

J:\CIVIL\06201\07165\SWS\PHASE 2\PHASE2B\07165-D1.DWG