

Benchmark:
Sta. 36+60.62 (13th St. N.) 33' Lt.
City Disc on base of R/R signal at the
NE Corner of Washington and 13th N,
32' N. of 13th and 26.25' E. of E. rail
of tracks.
Elev. = 1304.22

Iron Pipe
Sta. 36+01.07 No Offset

STATE	PROJECT NO.	YEAR	SHEET NO.	TOTAL SHEETS
KANSAS	87N-0238-01	2009	5	59

DATE	BY

REFERENCES NOTED
REFERENCES CHECKED

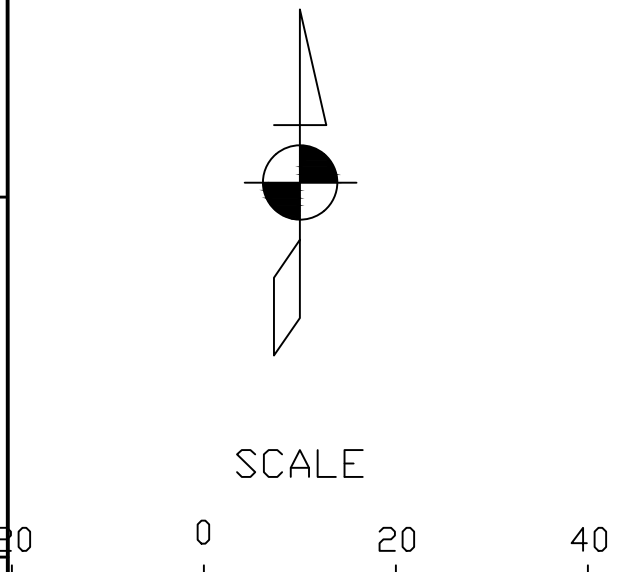
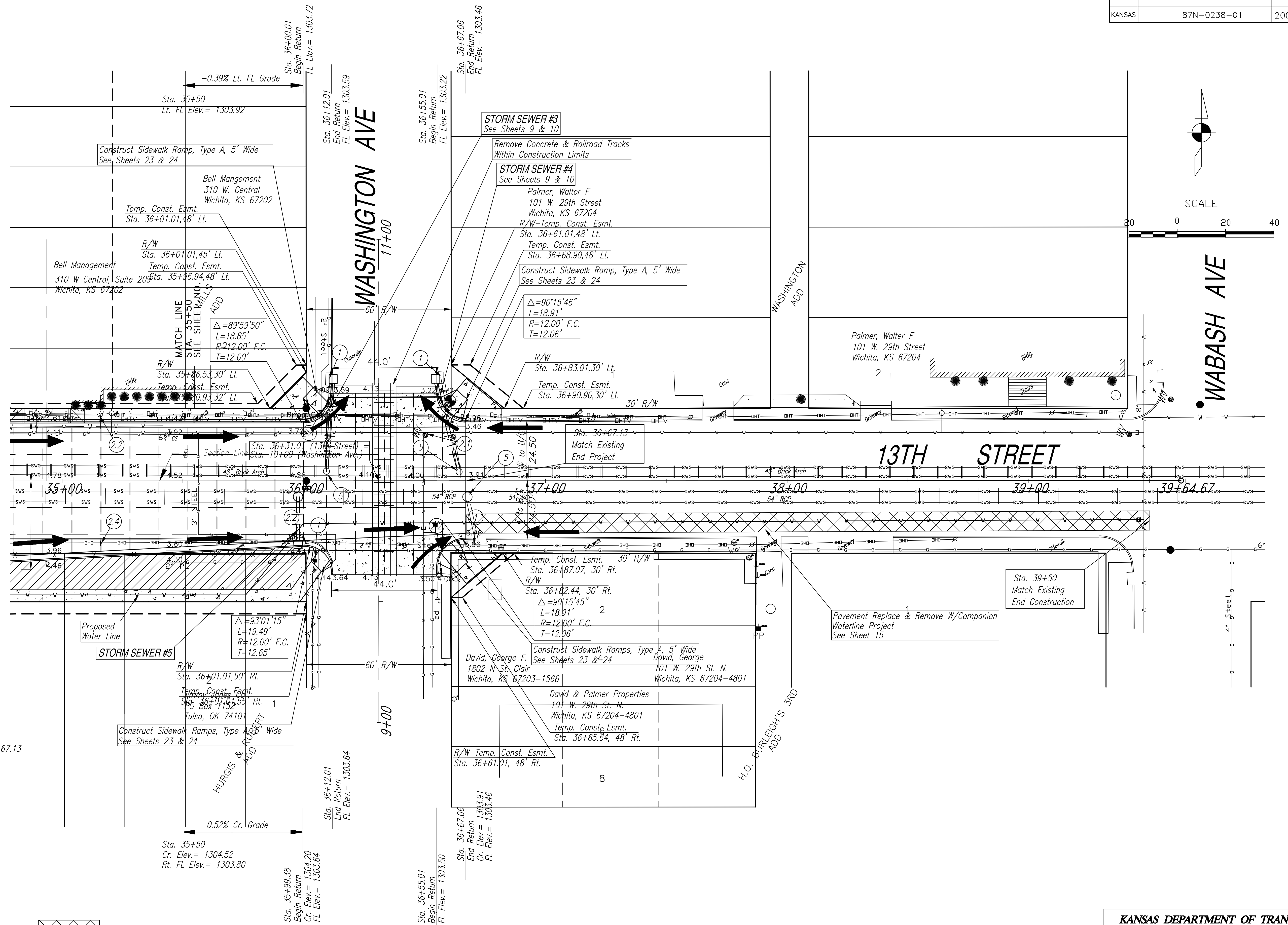

Remove Existing Pavement From Sta. 27+07.15 to Sta. 36+67.13

- ① Remove
- ② To Be Adjusted or Relocated by Others
 - ②.1 Water Valve
 - ②.2 Power Pole
 - ②.3 Gas Valve
 - ②.4 Sign
 - ②.5 RR Arm
 - ②.6 FH
- ③ Water Service Line to be adjusted by Wichita Water Department during construction.
- ④ To be adjusted during construction by Kansas Gas Service.
- ⑤ Adjust Manhole/Replace Lid & Ring
- ⑥ Adjust Manhole

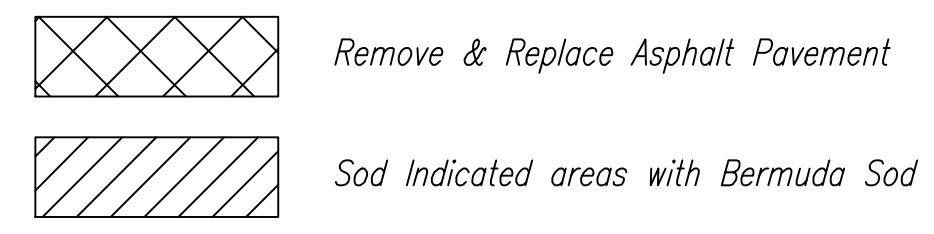

KANSAS DEPARTMENT OF TRANSPORTATION
PLAN SHEET
13TH STREET NORTH
STA. 35+50 TO STA. 36+67.13