

STATE	PROJECT NO.	YEAR	SHEET NO.	TOTAL SHEETS
KANSAS	87N-0238-01	2009	7	59

DATE	
BY	
REFERENCES NOTED	
REFERENCES CHECKED	

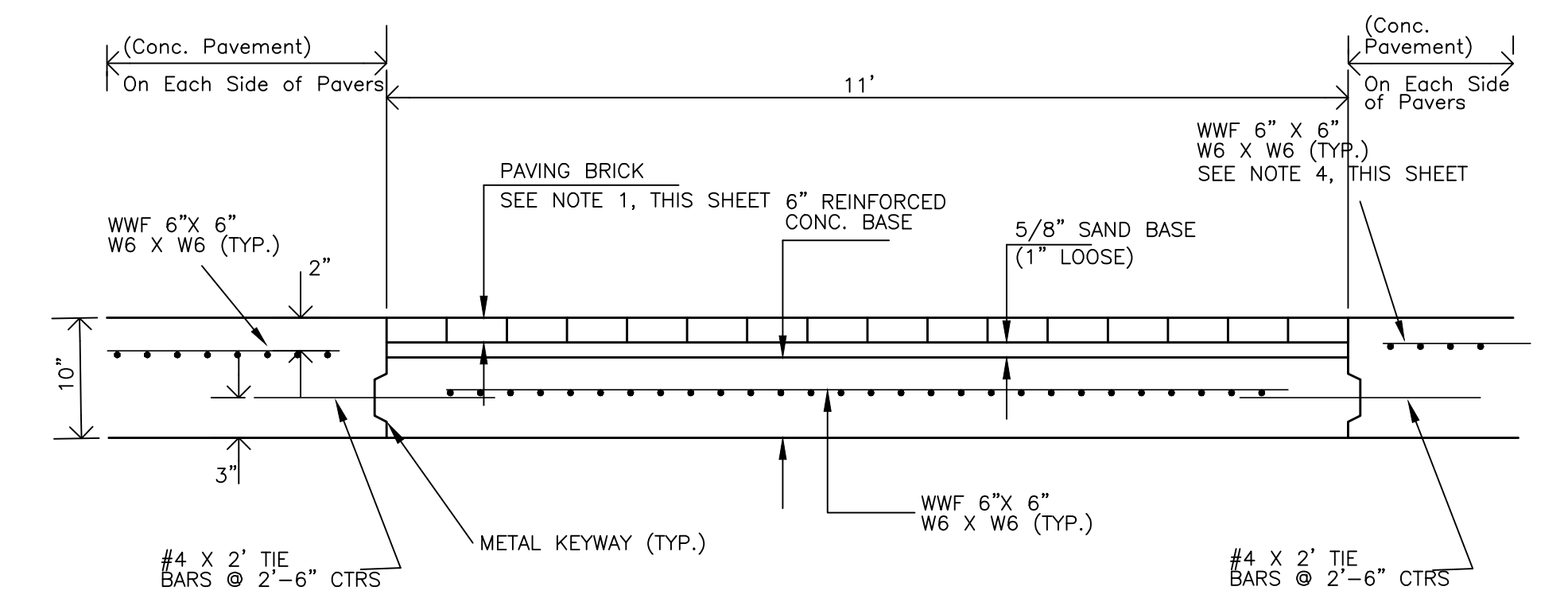
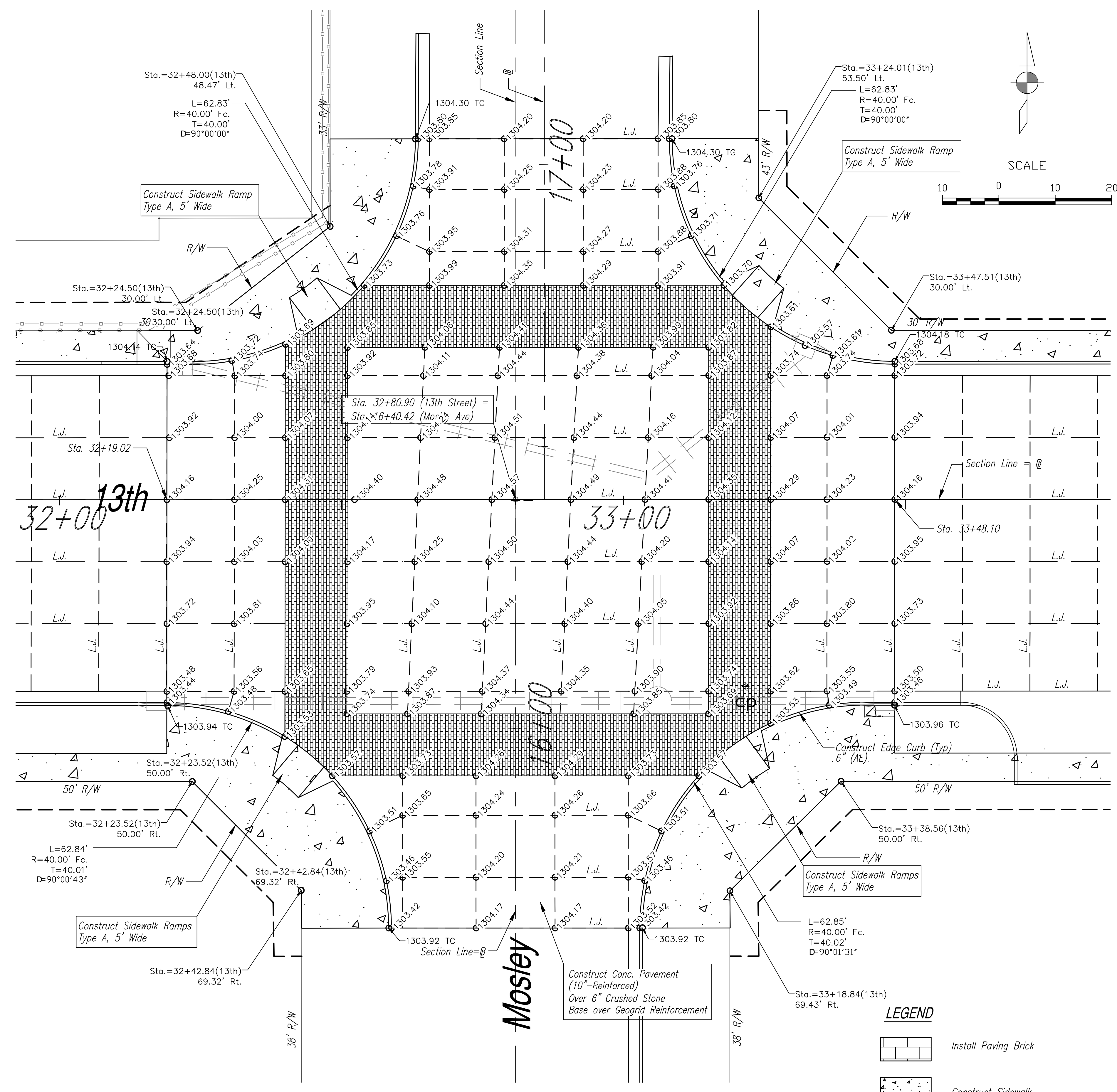

PAVING BRICK

GENERAL NOTES

- Interlocking Concrete Paving Stones (ASTM C936-82) used shall be Holland Stone Style consisting of full stones (8" X 4" X 3 1/8"). Color of the Paving Stones shall be Charcoal-Red (natural, brown, sandstone, charcoal, red/black blend).
- 5/8" sand base shall be *Subsidiary* to "Paving Brick".
- 6" Reinforced Concrete Base shall be paid for under Bid Item 10"-Conc. Pavement (AE)
- This reinforcement to be placed in concrete panels adjacent to brick crosswalk and is *Subsidiary* to PAVING BRICK.
- Additional work involved in forming pavement for Paving Brick will be *Subsidiary* to PAVING BRICK.

LEGEND

- Install Paving Brick
- Construct Sidewalk

KANSAS DEPARTMENT OF TRANSPORTATION
 INTERSECTION DETAILS
 13TH STREET NORTH/MOSLEY AVE.