

3/4 IP  
NW COR SW 1/4 SEC 1-28S-R1E  
N 22645.22  
E 20000.00

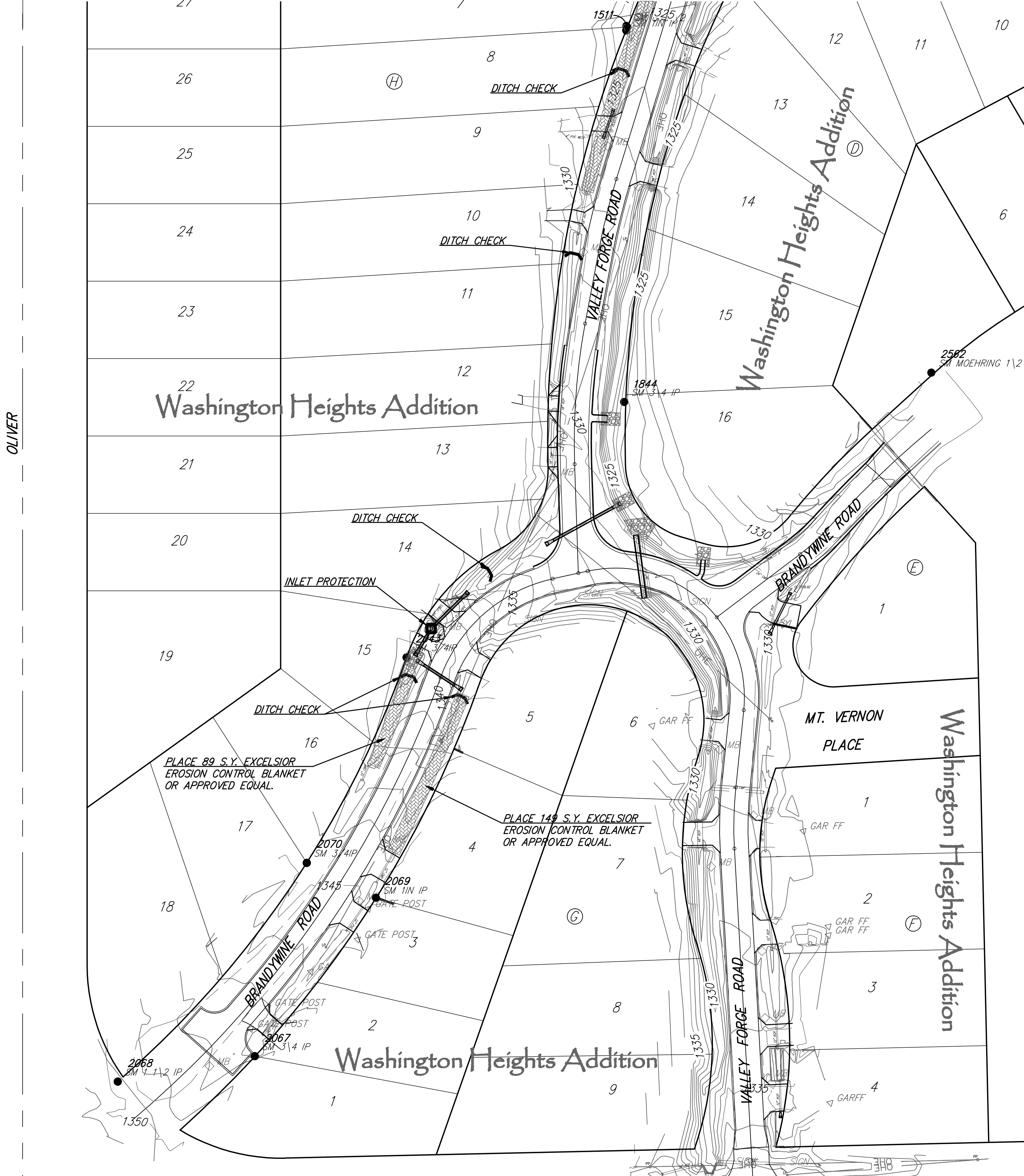

5/8 BAR  
SW COR SEC 1-28S-R1E  
N 20000.00  
E 20000.00

EAST 31ST ST SOUTH



**Point Table**

Point #	Northing	Easting	Description
2068	20113.78	20073.70	SM 1 1/2 IP
2069	20256.29	20273.79	SM 1 1/2 IP
2070	20283.35	20220.16	SM 3/4 IP
1511	20931.01	20468.64	SM SRB 1/2
1844	20640.49	20466.14	SM 3/4 IP
1001	21214.16	20049.89	SM SRB 1/2
1002	21362.43	20049.94	SM SRB 1/2
1003	21442.84	20195.71	SM 1/2 IP
2043	20442.58	20297.59	SM 3/4 IP
2562	20663.26	20704.29	SM MOEHRING 1/2
2067	20133.52	20179.90	SM 3/4 IP

- LEGEND**
- DITCH CHECK
  - CURB INLET PROTECTION
  - STRAW BALE BARRIER
  - SILT FENCE
  - RIP RAP
  - EROSION CONTROL BLANKET



Scale: 1" = 50'

**Washington Heights  
Erosion Control / Horizontal Control Plan  
SEDGWICK COUNTY, KANSAS**

**Ruggles & Bohm, P.A.**  
Engineering, Surveying, Land Planning

624 North Main  
Wichita, Kansas 67203  
www.rblaw.com

(316) 264-6888  
(316) 264-6821 fax  
E-mail: info@rblaw.com

DATE: 11  
SCALE: 11  
OF: 33

PROJECT FILE: Details {Typical Section}

PROJECT NUMBER: 472-84718

DATE: Dec. 30, 2008