

PLAN	CHECKED	BY	DATE
	CHECKED		

PROFILE	CHECKED	BY	DATE
	CHECKED		

Saved 09-17-2008 8:44:54 AM by TLS
 Plot Scale 1:20 09-17-2008 8:49:46 AM
 Q:\2007\07172\003\RECORD DRAWINGS\PS\S\S\07172-c2-2-SWS Line 2

.5193 .4473
 N-20,158.5151, E-19,944.4002
 Sta. 10+00.0, SWS Line No. 2=
 Sta. 10+96.4, SWS Line No. 1
 Type 'P' Manhole
 Top Elev.= **1315.50-1315.57**
 Install 245.5 L.F. 12" RCP (S)

.1974 .9833
 N-19,913.2419, E-19,954.9054
 Sta. 12+45.5, SWS Line No. 2=
 Const. 12" RCP End Section (S)
 In= **1311.1 (S) 1311.01**

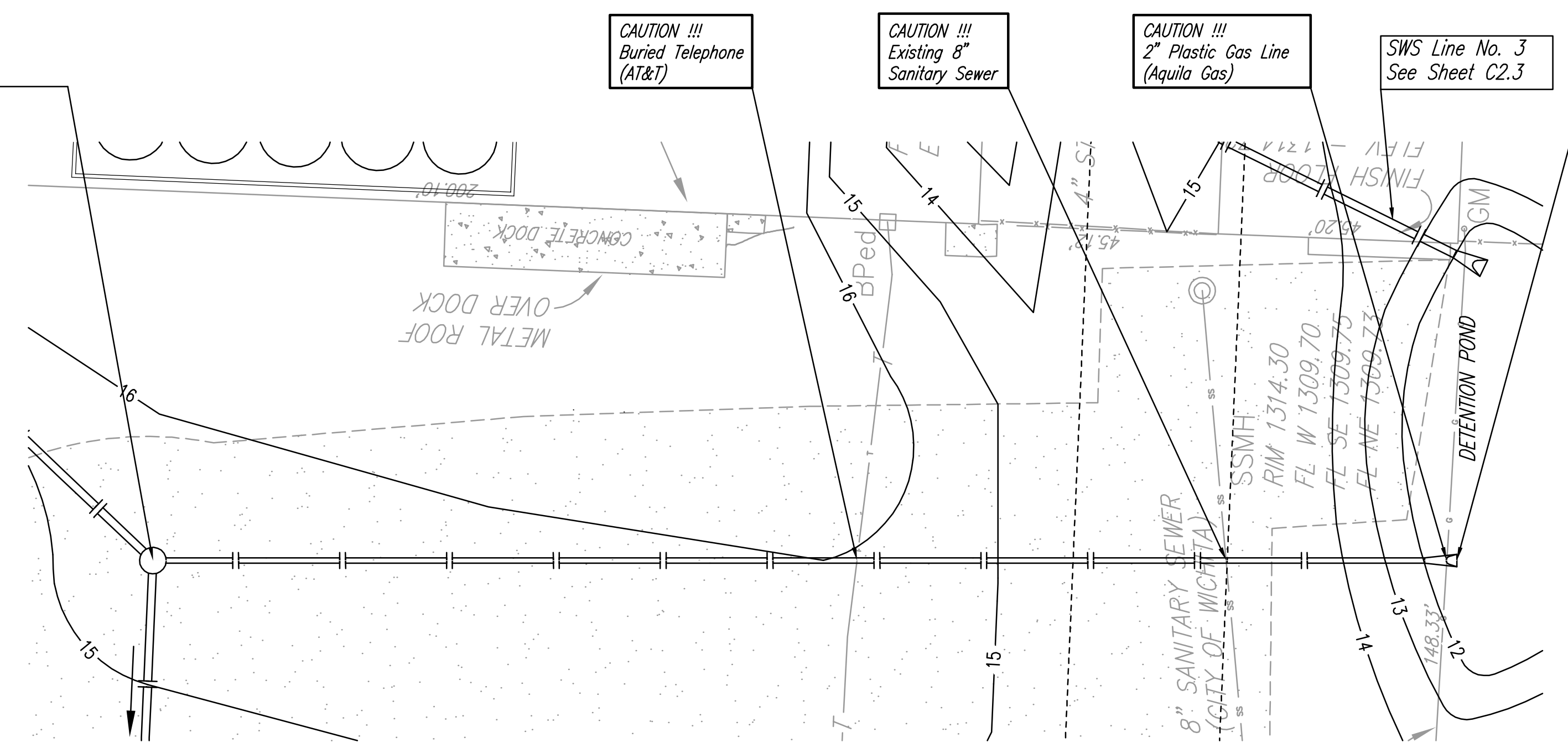

Proposed SWS is privately owned and maintained.

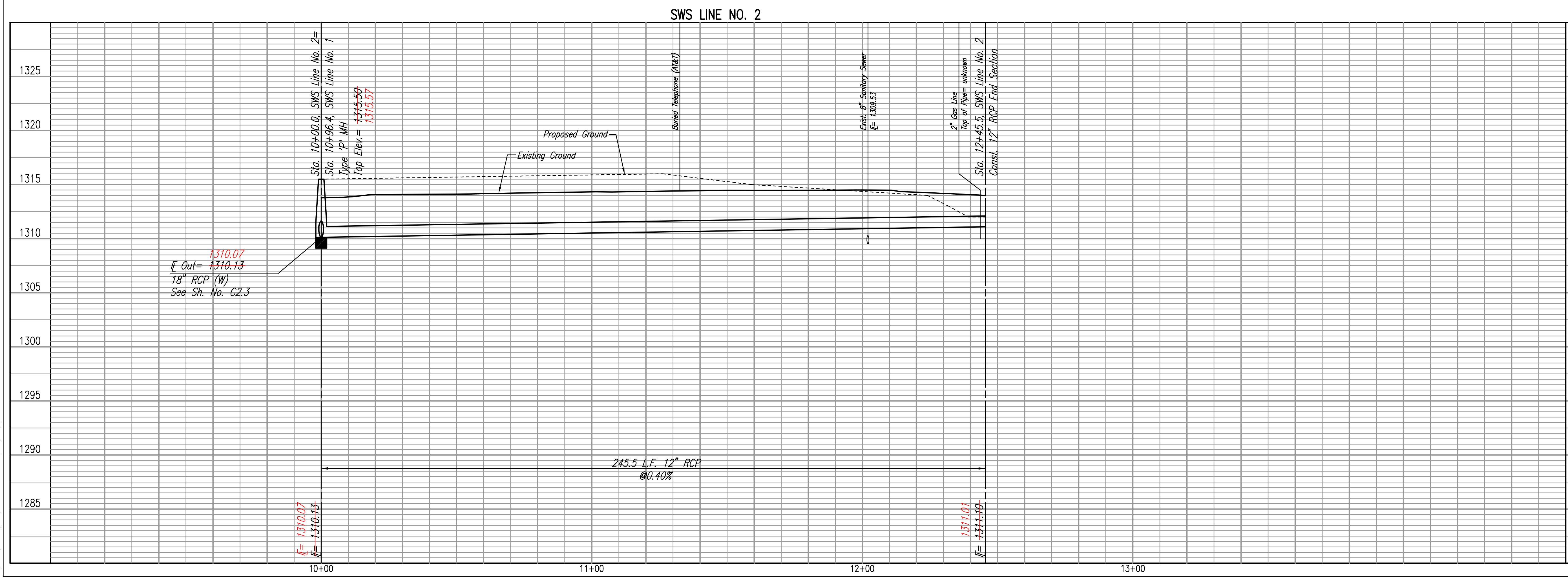
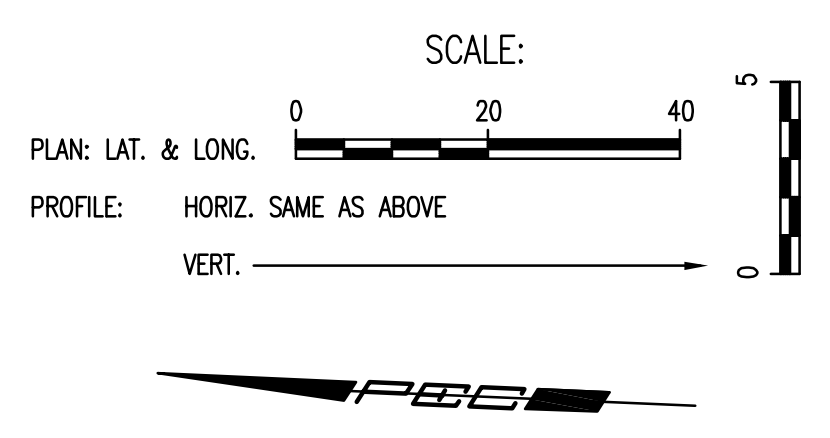

1325	1325
1320	1320
1315	1315
1310	1310
1305	1305
1300	1300
1295	1295
1290	1290
1285	1285

Professional Engineering Consultants, P.A.
 303 S. TOPEKA • WICHITA, KANSAS 67202
 316-262-2691 • FAX 316-262-3003

PRIVATE STORM WATER SEWER
 LUBRICANT RECYCLING FACILITY
 UNIVERSAL LUBRICANT, LLC
SWS LINE NO. 2

JAMES L. ARMOUR, P.E. - CITY ENGINEER
 CITY OF WICHITA PRIVATE PROJECT NO. 1882 PPS (607861)

Designed By RRY Job No. 35-07172-003-3088
 Drawn By NCL Date MAY 2008

Professional Engineering Consultants
 303 S. TOPEKA • WICHITA, KANSAS 67202
 316-262-2691 • FAX 316-262-3003
 www.pec1.com • designers@pec1.com

**LUBRICANT RECYCLING FACILITY
 UNIVERSAL LUBRICANTS, LLC
 WICHITA, KS**

SWS LINE NO. 2
 PLAN/PROFILE

JOB NO. 07172-003
 DATE JUNE 2008
 DRAWN NCL
 CHECKED RRY

C2.2
14