

NOTE: 5" ASPHALT TO BE USED IN ALL "REMOVE/REPLACE ASPHALT" AREAS

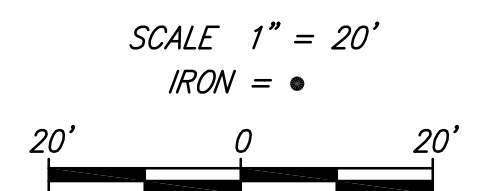

N 19574.25, E 19938.40
STA. 0+11.84 STORM SEWER
YUCCA STA. 0+57.84, 17.7' LT.
CENTER OF STRUCTURE
CONSTRUCT TYPE 1 INLET (5'X5')
TOP ELEV = 1317.60

CAUTION!! EXISTING GAS LINE

SAND BACKFILL
SEE PROFILE

EXISTING POWERPOLE
CONTRACTOR TO COORDINATE
WITH WESTAR TO SUPPORT POLE
DURING CONSTRUCTION.

REMOVE/REPLACE
ASPHALT (21 S.Y.)

REMOVE & RESET
EXISTING MAILBOX

N 19816.47, E 19934.00
STA. 2+54.08 STORM SEWER
YUCCA STA. 3+00, 11.2' LT.
CENTER OF STRUCTURE
CONSTRUCT TYPE 2 SPECIAL INLET (10'X5')
CONSTRUCT WITH SLAB TOP
TOP ELEV = 1317.85 (FUTURE)
TOP ELEV = 1318.30 (SLAB)

REMOVE/RESET
EXISTING 15" RCP (26 L.F.)

REMOVE/REPLACE
ASPHALT (13 S.Y.)

REMOVE/REPLACE
ASPHALT (23 S.Y.)

STA 4+50.62, LINE 1
YUCCA STA 4+88.63, 17.57' RT F.I.F.
CONSTRUCT TYPE 1A INLET
10'x4'
TOP ELEV = 1318.17
*TOP OF INLET WILL BE BENEATH EXIST. GROUND.
INSTALL TOP BACKWARDS AND MATCH EXISTING GROUND.

ALL SEWER SHALL BE BACKFILLED WITH
NATIVE SOILS EXCEPT WHERE INDICATED
DIFFERENTLY. STREET CROSSINGS SHALL BE
BACKFILLED WITH SAND AND FLUSHED AND
VIBRATED PER CITY SPECIFICATIONS.
SUITABILITY OF EXCAVATED SAND FOR USE
AS BACKFILL WILL BE DETERMINED BY THE
ENGINEER.

CRUSHED ROCK TO BE USED AS TEMPORARY SURFACE
IN ALL CASES WHERE PAVEMENT OR GRAVEL IS REMOVED
AND TO FILL THE VOID LEFT BY EXISTING CULVERT REMOVAL
AS NECESSARY FOR STORM SEWER CONSTRUCTION. BID ITEM
IS SUBSIDIARY TO THE BID ITEM FOR THE STORM SEWER PIPE
BEING INSTALLED.

CRUSHED ROCK IS TO BE UNIFORMLY GRADED FROM 1-1/2"
MAXIMUM SIZE TO NOT MORE THAN 10% PASSING A NO. 200
SIEVE.

REMOVE 7 LF 15" RCP
AND EXISTING INLET

0+00

EXISTING MH

EXISTING RCP

EXISTING INLET

N 19574.01, E 19950.24
STA. 0+00.00 STORM SEWER
CONNECT TO EXISTING MH

REMOVE/REPLACE
ASPHALT (10 S.Y.)

N 19817.39, E 19968.66
STA. 2+84.95 STORM SEWER (BACK)=
STA 2+61.99 SWS LINE 2 (AHEAD)
YUCCA STA 3+00.45, 17.57' RT F.I.F.
CONSTRUCT TYPE 1A INLET (10'x4')
TOP ELEV (FUTURE) = 1317.85
*TOP OF INLET WILL BE BENEATH EXIST. GROUND.
INSTALL TOP BACKWARDS AND MATCH EXISTING GROUND.

CAUTION!! IRRIGATION VALVE

CAUTION!! EXISTING GAS LINE

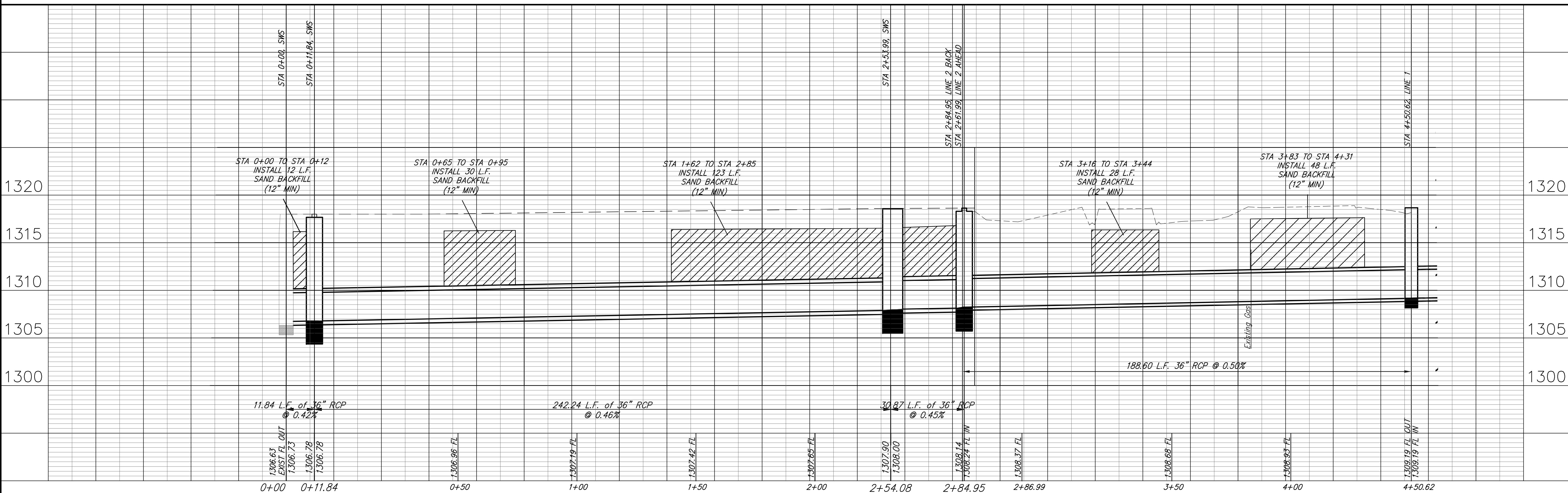

REVISIONS
DRAWN: EUG
DESIGN: KWL
PROJECT NUMBER: 482-84648
DRAWING FILE: Engineering Base (Revised SWS P-R)



REVIEW: [blank]
DATE: Aug. 6, 2009
UTILITY

Aug. 6, 2009

Pueblo, Mariposa & Sierra
Storm Drain Line 1
WICHITA, KANSAS

RB JOB: 32481
SHEET: 11A OF 33