

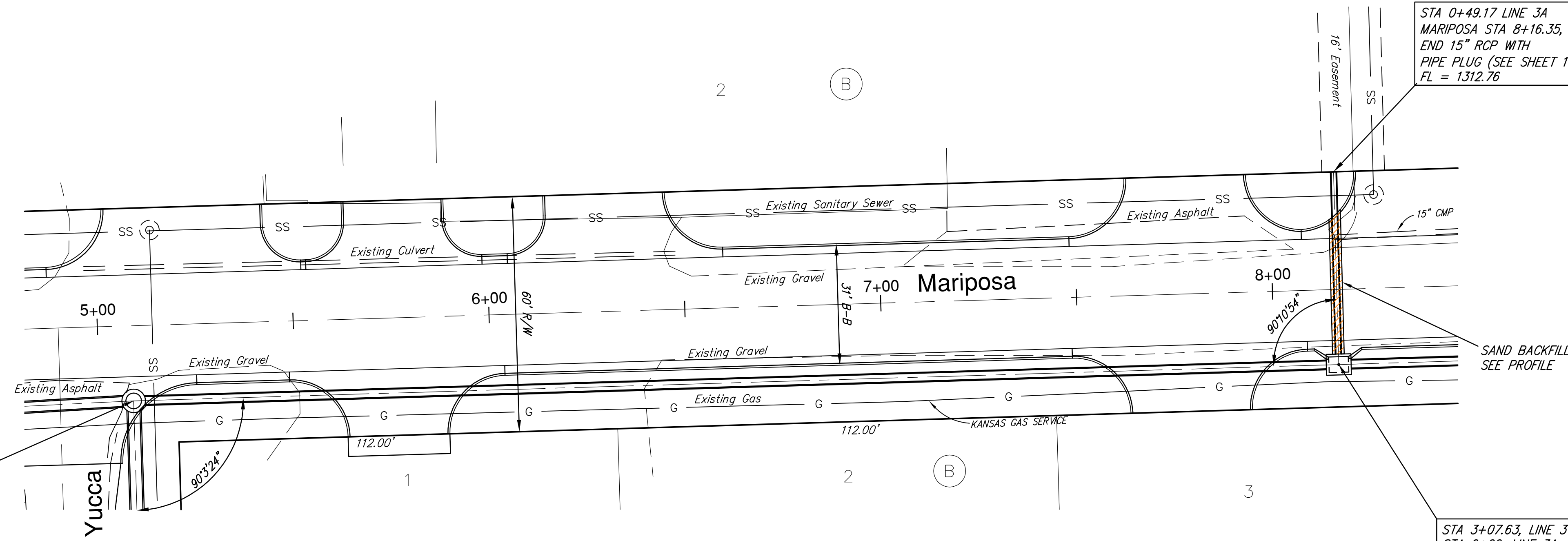

SCALE 1" = 20'
IRON = ●



STA 0+00, LINE 3 =
STA 0+00, LINE 2 =
STA 8+07.34, LINE 1
CONSTRUCT STD TYPE 'P' MH
SEE SHEET 12

STA 0+49.17 LINE 3A
MARIPOSA STA 8+16.35, 30.0' LT F.I.F.
END 15" RCP WITH
PIPE PLUG (SEE SHEET 13)
FL = 1312.76

STA 3+07.63, LINE 3 =
STA 0+00, LINE 3A
MARIPOSA STA 8+16.35, 17.17' RT F.I.F.
CONSTRUCT TYPE 1A INLET
5'x4'
TOP ELEV = 1319.03
1 - 15" STUB N (49.17 L.F.)

ALL SEWER SHALL BE BACKFILLED WITH NATIVE SOILS EXCEPT WHERE INDICATED DIFFERENTLY. STREET CROSSINGS SHALL BE BACKFILLED WITH SAND AND FLUSHED AND VIBRATED PER CITY SPECIFICATIONS. SUITABILITY OF EXCAVATED SAND FOR USE AS BACKFILL WILL BE DETERMINED BY THE ENGINEER.

CRUSHED ROCK TO BE USED AS TEMPORARY SURFACE IN ALL CASES WHERE PAVEMENT OR GRAVEL IS REMOVED AND TO FILL THE VOID LEFT BY EXISTING CULVERT REMOVAL AS NECESSARY FOR STORM SEWER CONSTRUCTION. BID ITEM IS SUBSIDIARY TO THE BID ITEM FOR THE STORM SEWER PIPE BEING INSTALLED.

CRUSHED ROCK IS TO BE UNIFORMLY GRADED FROM 1-1/2" MAXIMUM SIZE TO NOT MORE THAN 10% PASSING A NO. 200 SIEVE.

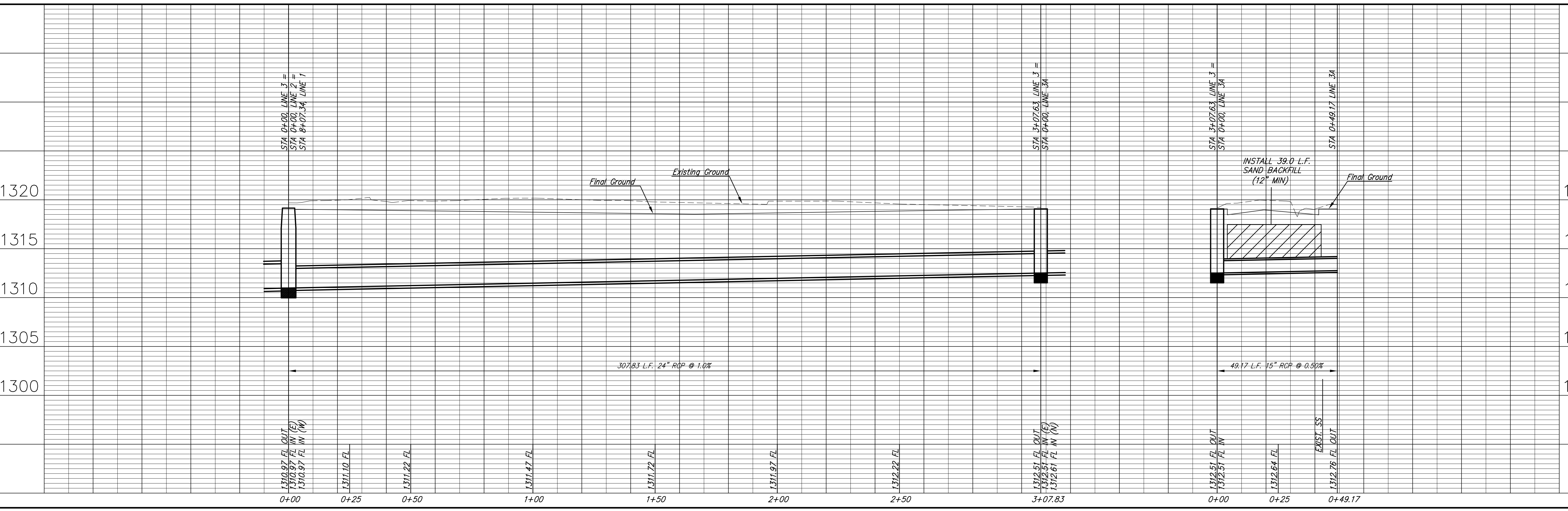

Ruggles & Bohm, P.A.
Engineering, Surveying, Land Planning
3000 Main Street, Suite 2000
Lawrence, KS 66044
www.ruggles.com
E-mail: info@ruggles.com

DESIGN: KWL
DRAWN: RLS
DATE: Sept 24, 2008
REVIEW: [Signature]

PROJECT NUMBER: 482-84648
DRAWING FILE: Engineering Base

Pueblo, Mariposa & Sierra
Storm Drain Line 3 & 3A
WICHITA, KANSAS

RB JOB: 3248T
SHEET: 16
OF: 33