

SIERRA STA 4+04.28, 18.76' LT
END CONSTRUCTION OF EXISTING FLUME.
PLACE 3.0 S.Y. LIGHT STONE RIP-RAP.

EXIST. SIGN,
SEE DEMO PLAN

CONSTRUCT 7" ASPHALT
CONCRETE PAVEMENT W/ 6"
CRUSHED ROCK BASE

Sta. 12+30.52 Pueblo St.
Sta. 9+67.45 Sierra Drive

EXIST. SIGN,
SEE DEMO PLAN

STA 4+12.97
BEGIN TYPICAL 31'
PAVEMENT SECTION

STA 4+12.97
CONSTRUCT CONCRETE FLUME.
(BOTH SIDES)
SEE DETAIL THIS SHEET

SIERRA STA 3+93.21, 21.41' RT
END CONSTRUCTION OF EXISTING FLUME.
PLACE 3.0 S.Y. LIGHT STONE RIP-RAP.

CONSTRUCT COMBINED CURB
AND GUTTER (6 5/8" & 1 1/2")
BOTH SIDES

CONSTRUCT VALLEY GUTTER PAVEMENT.
7" REINFORCED CONCRETE W/ 6"
CRUSHED ROCK BASE AND MONOLITHIC
EDGE CURB (3 5/8")

CONCRETE FLUME DETAIL

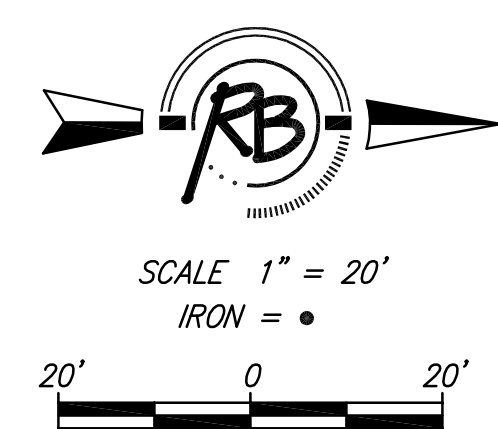
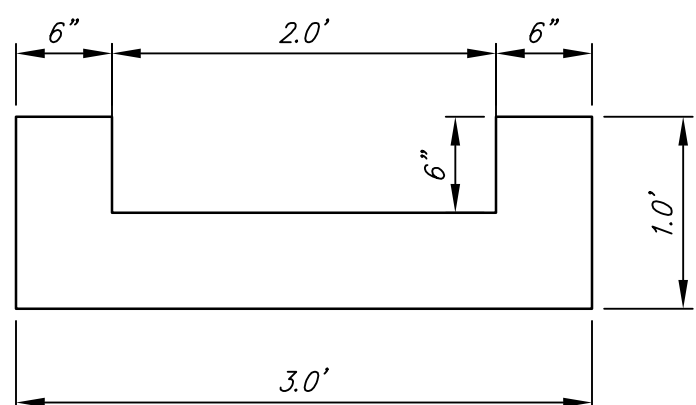

NOTE: EXISTING SANITARY SEWER
MANHOLE TOP ADJUSTMENTS AND
GRAVEL/ASPHALT/CONCRETE REMOVAL
QUANTITY DETAILS ON DEMO PLAN SHEET
SEE SHEET 23.

Airport Industrial Addition SIERRA WICHITA, KANSAS			
	Ruggles & Bohm, P.A. Engineering, Surveying, Land Planning		
	924 North Main Wichita, Kansas 67203 www.rbkansas.com		
(316) 264-8008 (316) 264-4621 fax E-mail: info@rbkansas.com		DESIGN: KWL DRAWN: RLS REVIEW: UTILITY: DATE: Sept 24, 2008	
DRAWING FILE paving {SIERRA-1}	PROJECT NUMBER 472-84648	SHEET 9 OF 33	REF. NO. 3246T