

GENERAL NOTES

- The Contractor shall provide a minimum advance notice of 48 hours to utility companies prior to starting construction as follows:
KANSAS ONE CALL 1-800-344-7233 or 687-2470 (LOCAL WICHITA)
- Pavement grades shown are to the top of pavement.
- Existing elevations were provided by others. Contractor shall verify existing grades and notify Engineer of any discrepancies. Elevations are based on Mean Sea Level Datum.
- Contractor shall be responsible for establishing and protecting Benchmark throughout construction.
- Contractor shall strip site of topsoil (6" min.) and stockpile this material to be used in grassed areas.
- All curb shall be Combined Curb & Gutter unless otherwise noted. Curb & Gutter shall be constructed to City of Wichita Standard Specifications.
- Compaction of fill material and subgrade stabilization shall comply with Geotechnical Engineering Report.
- Pavement type shall be A.C. Pavement. Pavement thickness and base stabilization shall be as specified in the Soils Engineer's Report.
- All soil used for overexcavation and for backfilling of excavations for basement, tank removal etc. shall be tested for compaction as required by an independent Soils Engineer's recommendations.
- The Contractor shall examine the construction site before bidding and be satisfied as to the work shown for completion. After bids have been received, the Contractor shall not assert that there was a misunderstanding of the quantities of work or of the nature of work to be completed.
- All proposed slopes and grades shall be in accordance with ADA Sec. 4.1.3(8)(a)(ii).

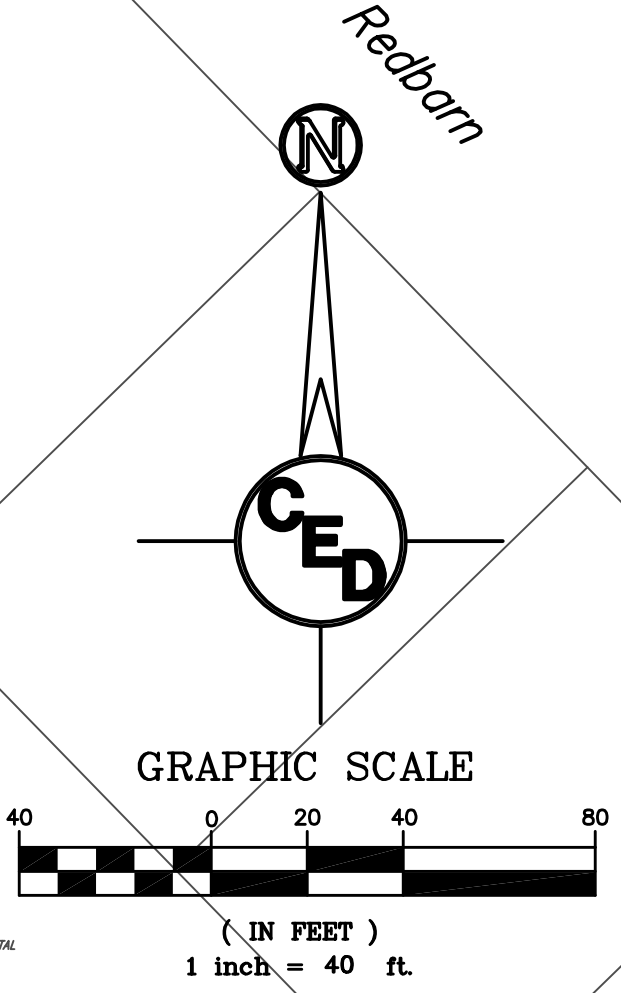

Typical Asphalt Pavement Section
(No Scale)

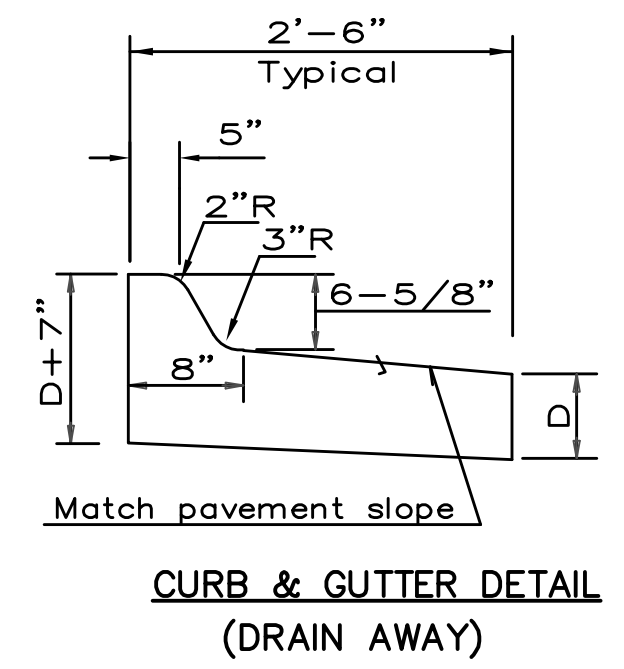
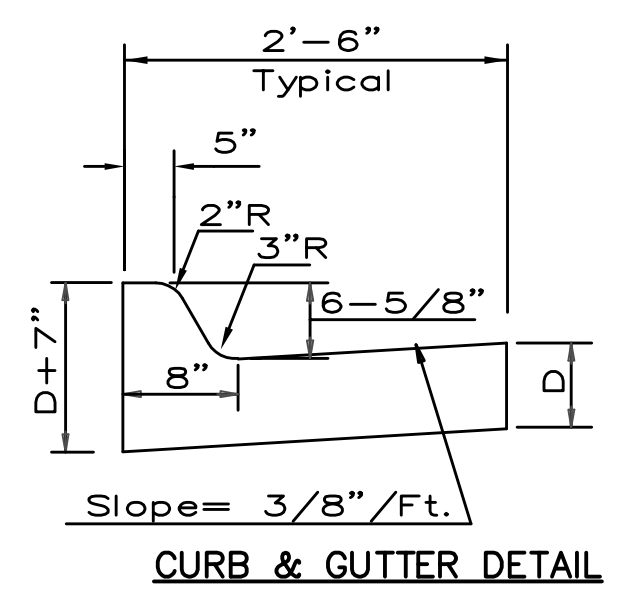
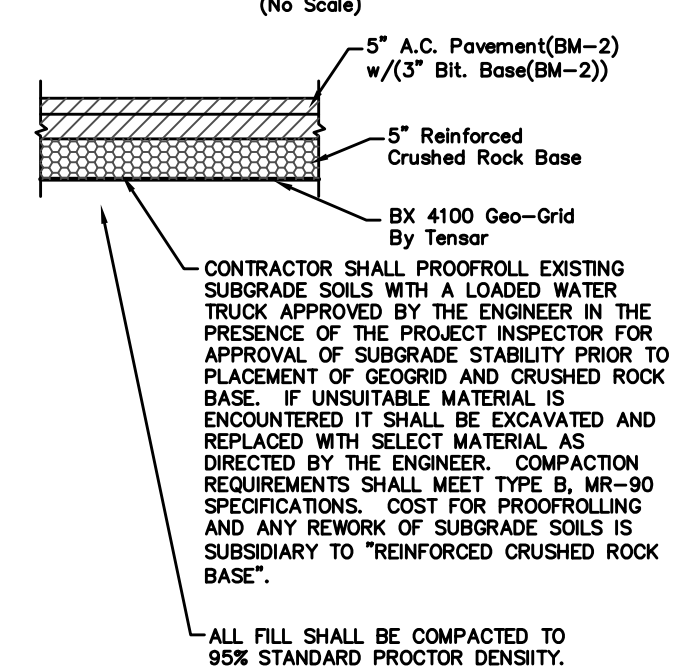

Subgrade and Pavement Notes
FABRIC BASE REINFORCEMENT SHALL BE B X 4100 GEOTRID AS MANUFACTURED BY TENSAR CORPORATION OR APPROVED EQUAL. FABRIC BASE REINFORCEMENT SHALL BE INSTALLED IN ACCORDANCE WITH MANUFACTURER'S RECOMMENDATIONS. CRUSHED ROCK SHALL BE UNIFORMLY GRADED FROM 1-1/2" MAXIMUM SIZE TO NOT MORE THAN 10% PASSING A NO. 200 SIEVE. ROCK QUALITY SHALL BE THE SAME AS SPECIFIED FOR COARSE AGGREGATE FOR CONCRETE MIXES.
ROCK BASE IS TO BE COMPACTED AND SMOOTHED WITH A STEEL FACED ROLLER PRIOR TO PLACEMENT OF ASPHALT. TACK COAT WILL NOT BE APPLIED TO ROCK BASE.
A TACK COAT OF EMULSIFIED ASPHALT (SC-1H OR CSS-1H) SHALL BE APPLIED AT AN APPROXIMATE RATE OF 0.05 GALLONS PER SQUARE YARD BETWEEN EACH LIFT OF ASPHALTIC MATERIAL.
BITUMINOUS BASE AND ASPHALTIC CONCRETE WEARING SURFACE SHALL BE PLACED WITH A LAYDOWN MACHINE HAVING AUTOMATIC CONTROLS FOR LINE AND GRADE.
CONSTRUCTION JOINTS IN EACH LIFT SHALL BE STAGGERED A MINIMUM DISTANCE OF ONE (1) FOOT FROM JOINTS IN PRECEDING LIFTS AND PLACED SO THAT A JOINT WILL BE CONSTRUCTED ON THE CENTERLINE OF THE TOP LIFT.
THE ASPHALTIC CONCRETE PAVEMENT BETWEEN THE COMBINED CURB AND GUTTER SHALL BE PAID AS SQUARE YARDS OF 2" ASPHALTIC CONCRETE (1" BITUMINOUS BASE).

UTILITIES SHOWN REPRESENT THE BEST INFORMATION AVAILABLE FOR DESIGN. ADDITIONAL UTILITIES MAY BE PRESENT ON THIS PROJECT. THE CONTRACTOR SHALL BE RESPONSIBLE FOR DETERMINING THE EXACT LOCATION, DEPTH AND SIZE OF ALL UNDERGROUND UTILITIES PRIOR TO CONSTRUCTION. THE CONTRACTOR SHALL BE LIABLE FOR ANY DAMAGE CAUSED BY THE FAILURE TO DO SO.

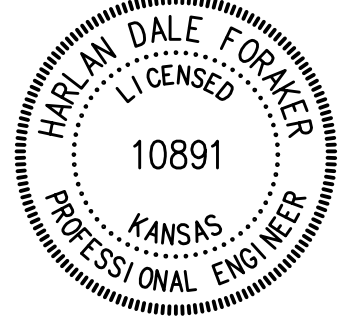

REV 9.14.09 LOWERED FIN. FLOOR ELEVATION TO 1343.50 AND ADJUSTED SITE GRADING PLAN

WEST CENTRAL GENESIS INDOOR TENNIS FACILITY
SITE GRADING PLAN
854 N. SOCORA ST., WICHITA, KS
CED PROJ. NO.: 20091809
CERTIFIED ENGINEERING DESIGN, P.A.
810 WEST DOUGLAS, SUITE C
WICHITA, KANSAS 67203
PH. (316) 262-8808 FAX. (316) 262-1669

DESIGNED: HDF	SCALE: 1"=40'	SHEET
DRAWN: HDF	DATE: 8-20-09	C1.1
CHECKED: HDF	CED FILE: CED-1XXX	TOTAL 3

- D = DESCRIBED
- M = MEASURED
- 1/2 IP = 1/2" IRON PIPE (FOUND)
- 3/4 IP = 3/4" IRON PIPE (FOUND)
- CROSS = CHISELED CROSS IN CONCRETE (FOUND)
- N&W = NAIL & BRASS WASHER (FOUND)
- SAV = 1/2" REBAR W/SAVOY CAP (FOUND)

NOTE: Existing Parking Lot Islands as depicted on Architectural Site Plan do not align with islands as located by Topographic Site Survey. Use Islands as shown on Topographic Site Survey for Construction.

Benchmark: Square Cut on Top of Curb
38.9'W & 22.6'S of N.W. Corner of Building.
Elevation = 1343.02 NAVD 88

- TC 100.50
FL 100.00 - Proposed Top Curb/Flowline Elevation
- ↘ - Proposed Drainage Flow Direction
- 1342 - Existing Contour (Elevation as shown)
- 1342 - Proposed Contour Line (Elevation as shown)