

**MERIDIAN AVENUE TYPICAL SECTION**

Sta. 173+00.02 to Sta. 174+54.00  
Sta. 176+03.50 to Sta. 177+57.15

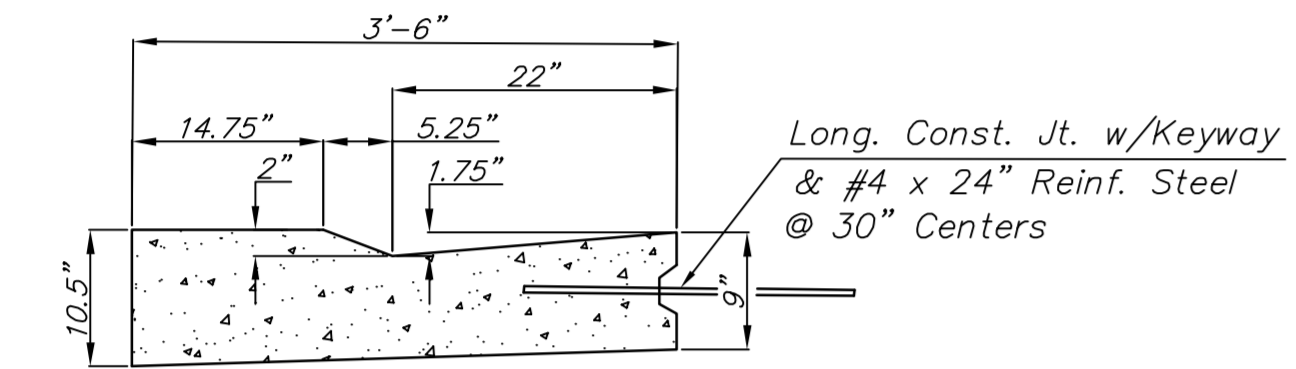

**SPECIAL GUTTER SECTION  
(3.5' WIDTH)  
Concrete Pavement Section**

Cost to be SUBSIDIARY to Type II Concrete Safety Barrier.

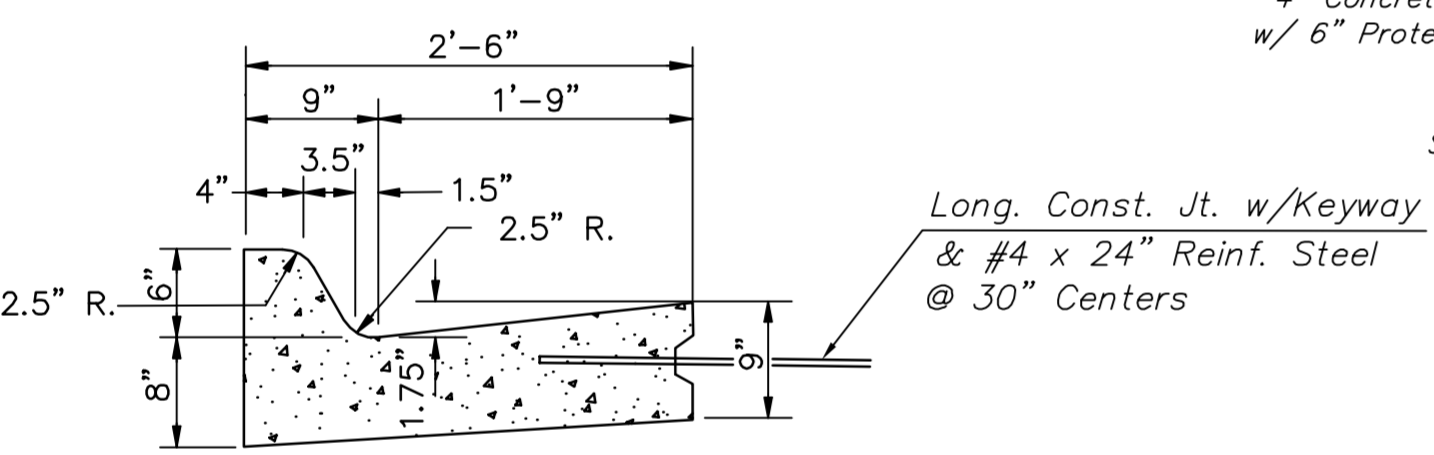

**COMBINED CURB & GUTTER  
TYPE I (6\"/>**

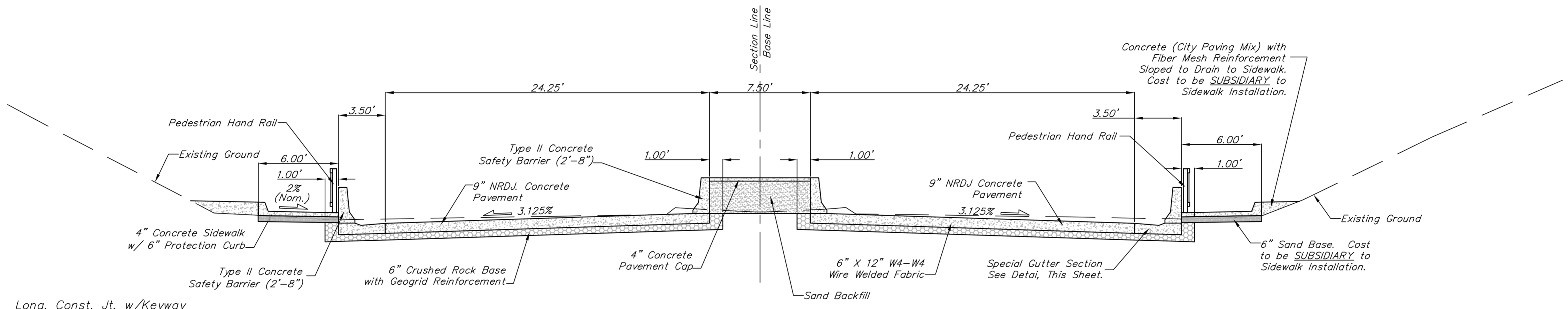

**MERIDIAN AVENUE TYPICAL SECTION**

Sta. 174+60.00 to Sta. 175+97.50

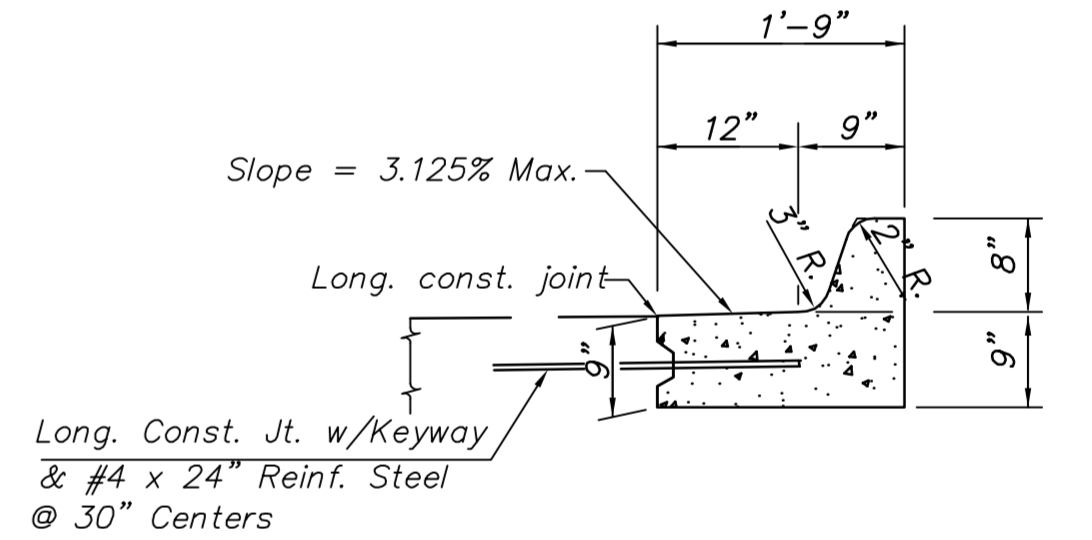

**COMBINED CURB & GUTTER  
TYPE III (1.75' WIDTH)  
Concrete Pavement Section**

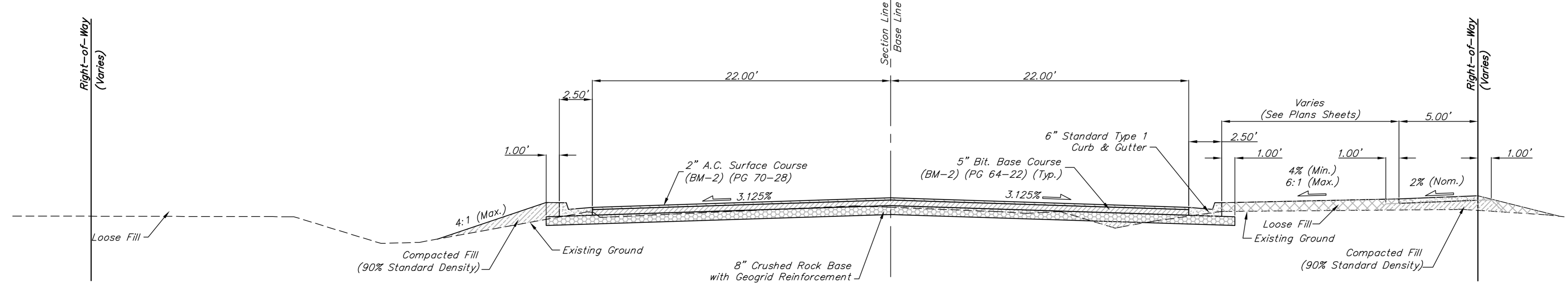

**MERIDIAN AVENUE TYPICAL SECTION**

Sta. 193+04.99 to Sta. 195+60.52  
Sta. 196+50.73 to Sta. 199+21.35

Drawing File: E:\eng\Meridian\_47th to 31st\TypSec1.dwg

Design: TPV  
Drawn: TPV  
Approved: TPV  
Scale: None

Project No. 0510E396 CAPITAL IMPROVEMENT PROJECT

**TYPICAL SECTIONS**

MERIDIAN AVENUE - 47TH STREET SOUTH TO 31ST STREET SOUTH

**Baughman Company, P.A.**  
315 Ellis St., Wichita, KS 67211 P 316-262-7171 F 316-262-0149  
Baughman ENGINEERING | SURVEYING | PLANNING | LANDSCAPE ARCHITECTURE

September 2009  
SHEET 6 OF 187