

BENCHMARK:
 BM #15 - "Chiseled in the Northeast Corner of the RCBC Under the YMCA Entrance. Sta. 190+61, 68' Lt. Elev. = 1282.23 MSL"

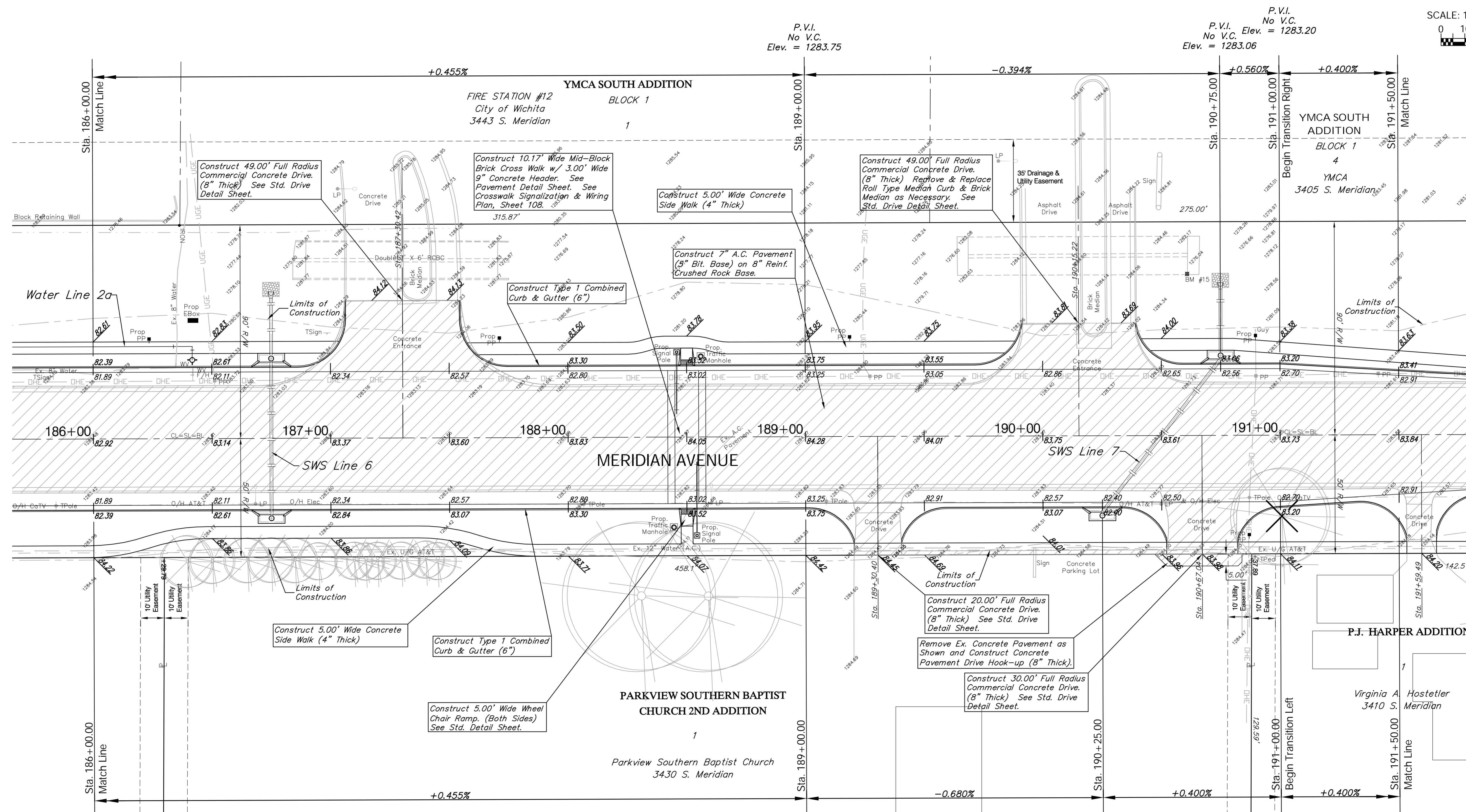
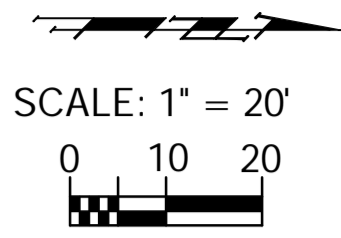

P.V.I.
No V.C.
Elev. = 1283.75

P.V.I.
No V.C.
Elev. = 1283.06

P.V.I.
80.00' V.C.
Elev. = 1283.75

P.V.I.
No V.C.
Elev. = 1282.90

P.V.I.
No V.C.
Elev. = 1283.20

Note:
Trees/Shrubs to be removed are marked thus:

Note:
Pavement, Sidewalks, and Etc. To Be Removed Are Indicated By:

Drawing File: E:\eng\Meridian_47th to 31st\Land\dwg\Base.dwg (Pav16)
 Project No. 0510E396 CAPITAL IMPROVEMENT PROJECT
 Design: TPV
 Drawn: STAFF
 Approved: TPV
 Scale: NOTED

Baughman Company, P.A.
 315 Ellis St., Wichita, KS 67211 P 316-262-0149 F 316-262-0149
 ENGINEERING | SURVEYING | PLANNING | LANDSCAPE ARCHITECTURE

September 2009
 SHEET
 OF 33
 187