

BENCHMARK:  
 BM #17 - City of Wichita Disc on the North Hubguard of the  
 RCBC in the Northwest Corner of the Intersection of  
 Meridian and 31st Street North  
 Sta. 206+50, 40' Lt.  
 Elev. = 1284.28 MSL

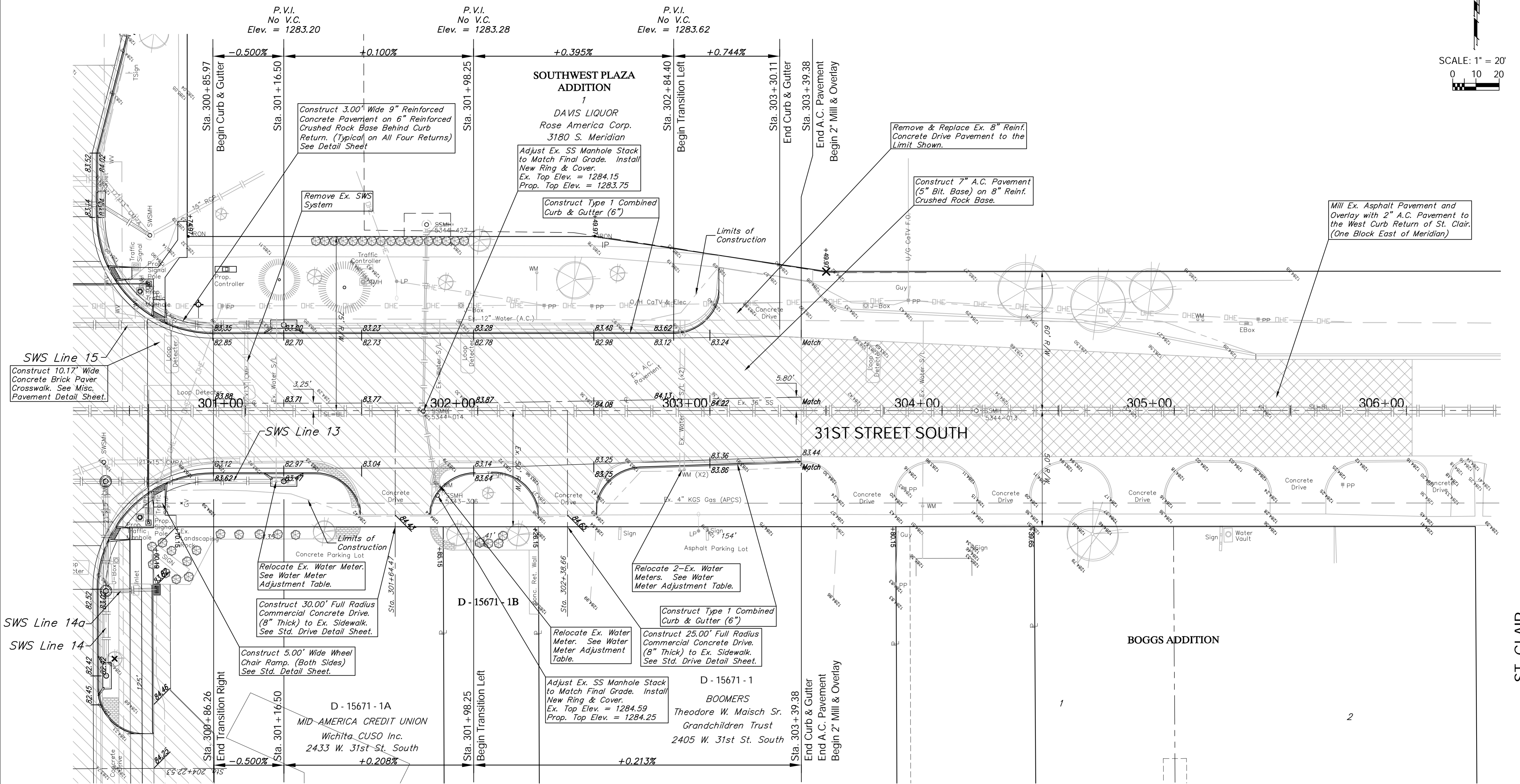
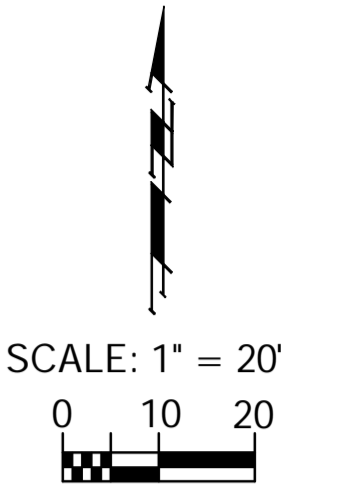

SWS Line 15  
 Construct 10.17' Wide  
 Concrete Brick Paver  
 Crosswalk. See Misc.  
 Pavement Detail Sheet.

SWS Line 14a  
 SWS Line 14

Note:  
 Ex. Asphalt Pavement to  
 be Milled and Overlayed is  
 Indicated by:

Note:  
 Pavement, Sidewalks, and  
 Etc. To Be Removed Are  
 Indicated by:

Drawing File: E:\eng\Meridian\_47th to 31st\Land\dwg\Base.dwg (Pav21)  
 Project No. 0510E396 CAPITAL IMPROVEMENT PROJECT  
 31ST STREET SOUTH PAVNG  
 Sta. 301+00.00 to Sta. 306+00.00  
 Scale: NOTED

**Baughman Company, P.A.**  
 315 Ellis St., Wichita, KS 67211 P 316-262-7271 F 316-262-0149  
 ENDSERVING | SURVEYING | PLANNING | LANDSCAPE ARCHITECTURE

September 2009  
 SHEET  
 38  
 OF  
 187