

Construct 9" Reinforced Concrete Pavement on 6" Reinforced Crushed Rock Base

Sta. 299+26.51

Install #4 Bars 24" Long at 30" on Center

31ST STREET SOUTH

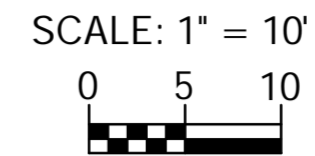

Construct 10.17' Wide Concrete Brick Paver Crosswalk. See Misc. Pavement Detail Sheet.

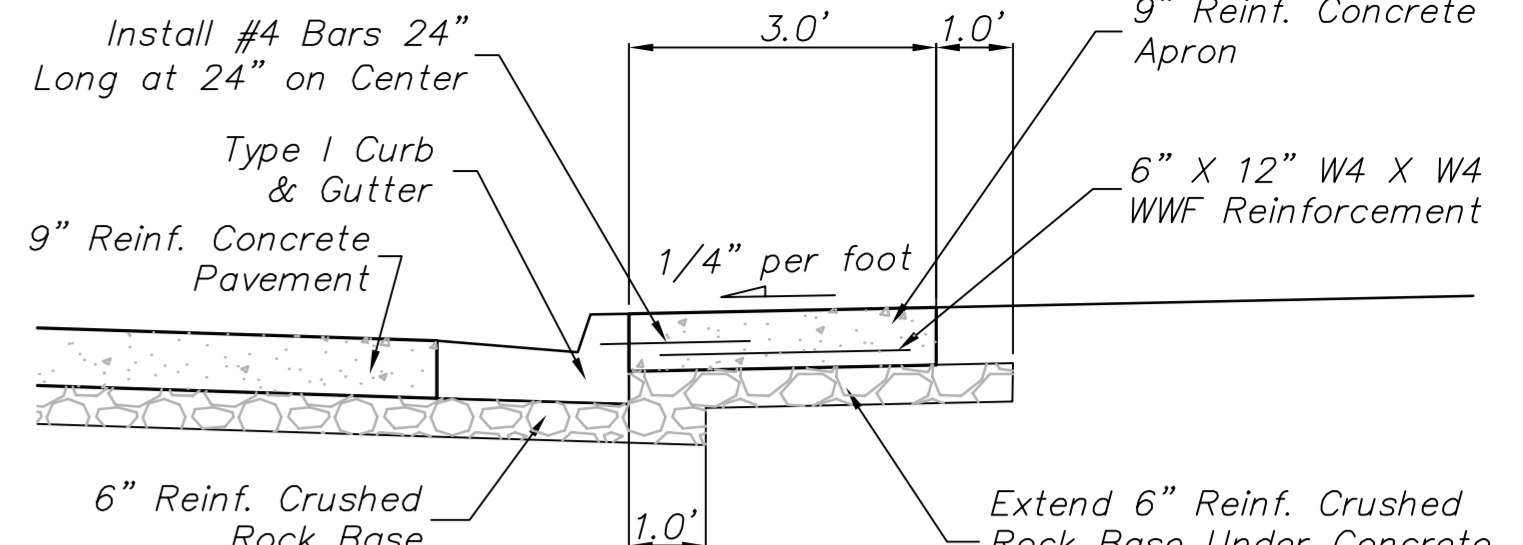

SECTION A-A

Saw & Seal Joints to Match Joints in the Type 1 Curb & Gutter

Construct 9" Reinforced Concrete Pavement on 6" Reinforced Crushed Rock Base Behind Curb Return. (Typical on All Four Returns.) See Detail, This Sheet.

* The Contractor shall Adjust the Joint Dimensions as Necessary to Match the Existing Concrete Pavement.

MERIDIAN AVENUE

MERIDIAN AVENUE

Construct 9" NRDJ Concrete Pavement on 6" Reinf. Crushed Rock Base

Construct 10.17' Wide Concrete Brick Paver Crosswalk. See Misc. Pavement Detail Sheet.

Sta. 204+99.78

Install 6" X 12" W4-W4 Welded Wire Fabric

31ST STREET SOUTH

Construct 9" Reinforced Concrete Pavement on 6" Reinforced Crushed Rock Base

Drawing File: E:\eng\Meridian\47th to 31st\Land\dwg\Base.dwg (joint)

Design: TPV
Drawn: TPV
Approved: TPV
Scale: NOTED

Project No. 0510E396 CAPITAL IMPROVEMENT PROJECT
MERIDIAN AVENUE & 31ST STREET SOUTH INTERSECTION JOINT PLAN
MERIDIAN AVENUE - 47TH STREET SOUTH TO 31ST STREET SOUTH

Baughman Company, P.A.
315 Ellis St., Wichita, KS 67211 P 316-262-7171 F 316-262-0149
Baughman ENGINEERING | SURVEYING | PLANNING | LANDSCAPE ARCHITECTURE

September 2009
SHEET 39 OF 187