

SCALE: 1" = 20'

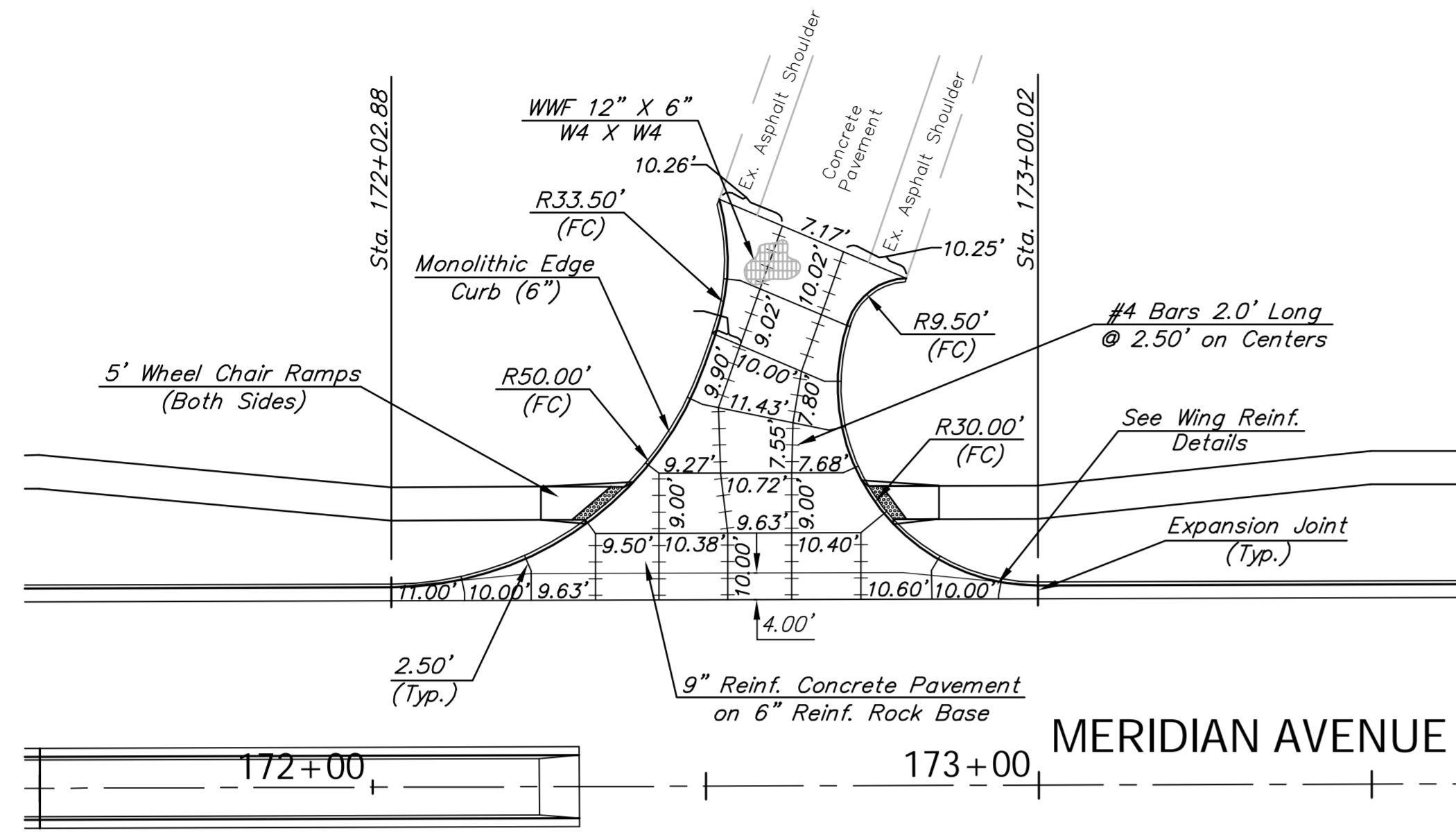

East Bound  
I-235 Exit Ramp

SCALE: 1" = 20'

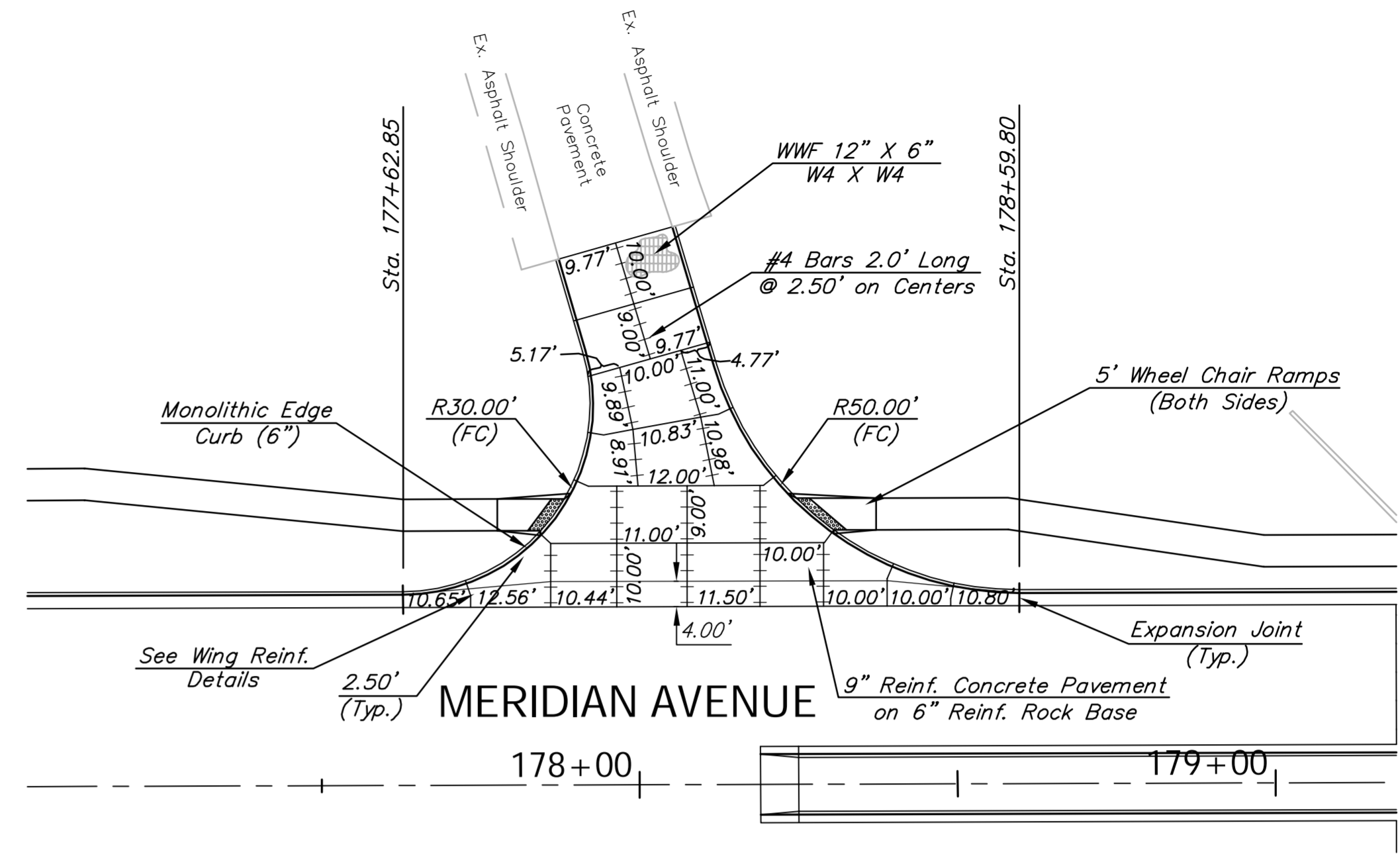

West Bound  
I-235 Entrance Ramp

When Beginning or Ending Full Height Curb, the Height of the Curb shall Transition between 1.5" to 6" in a minimum of 5.00'.

SCALE: 1" = 20'

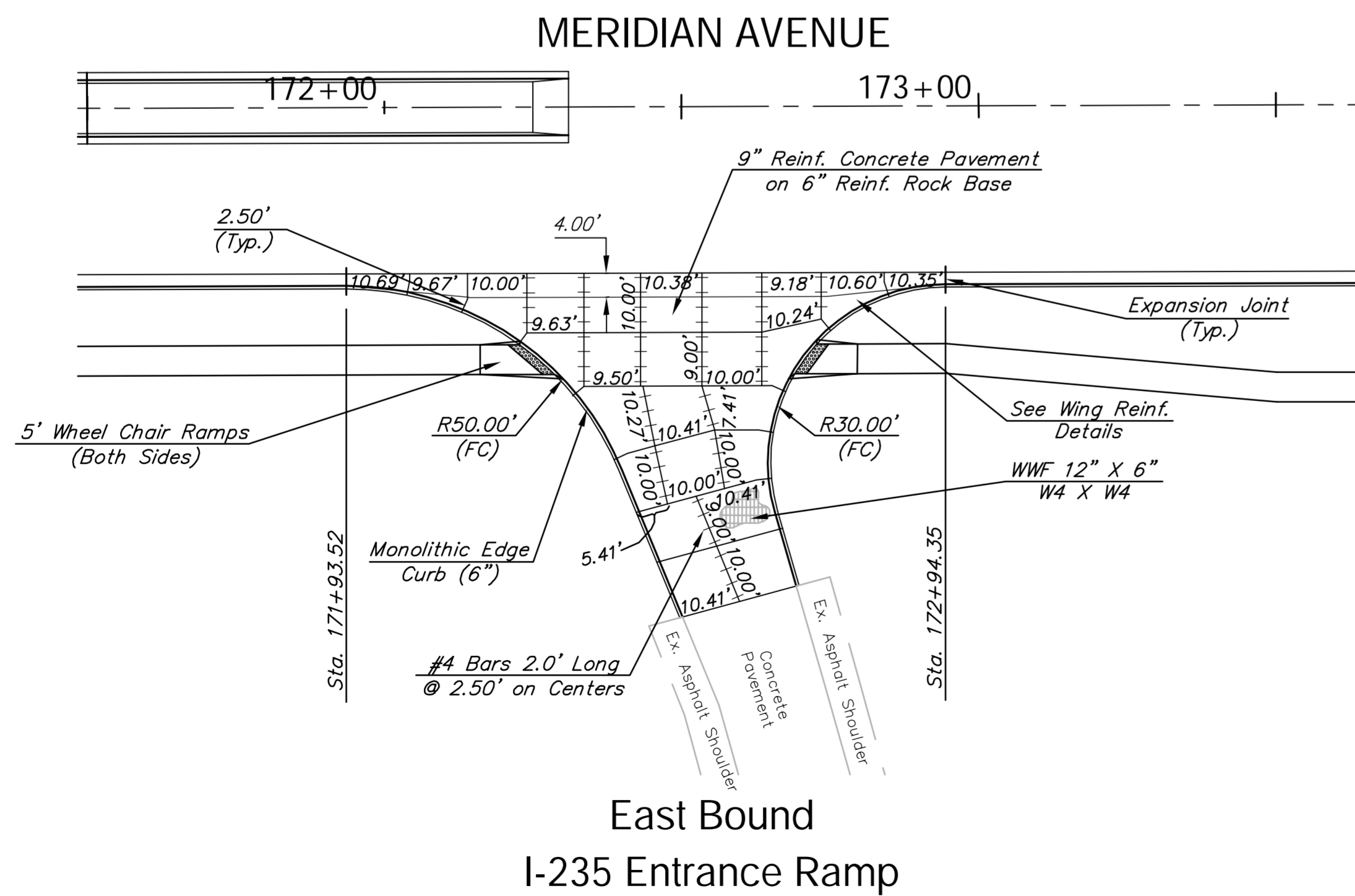

East Bound  
I-235 Entrance Ramp

SCALE: 1" = 20'

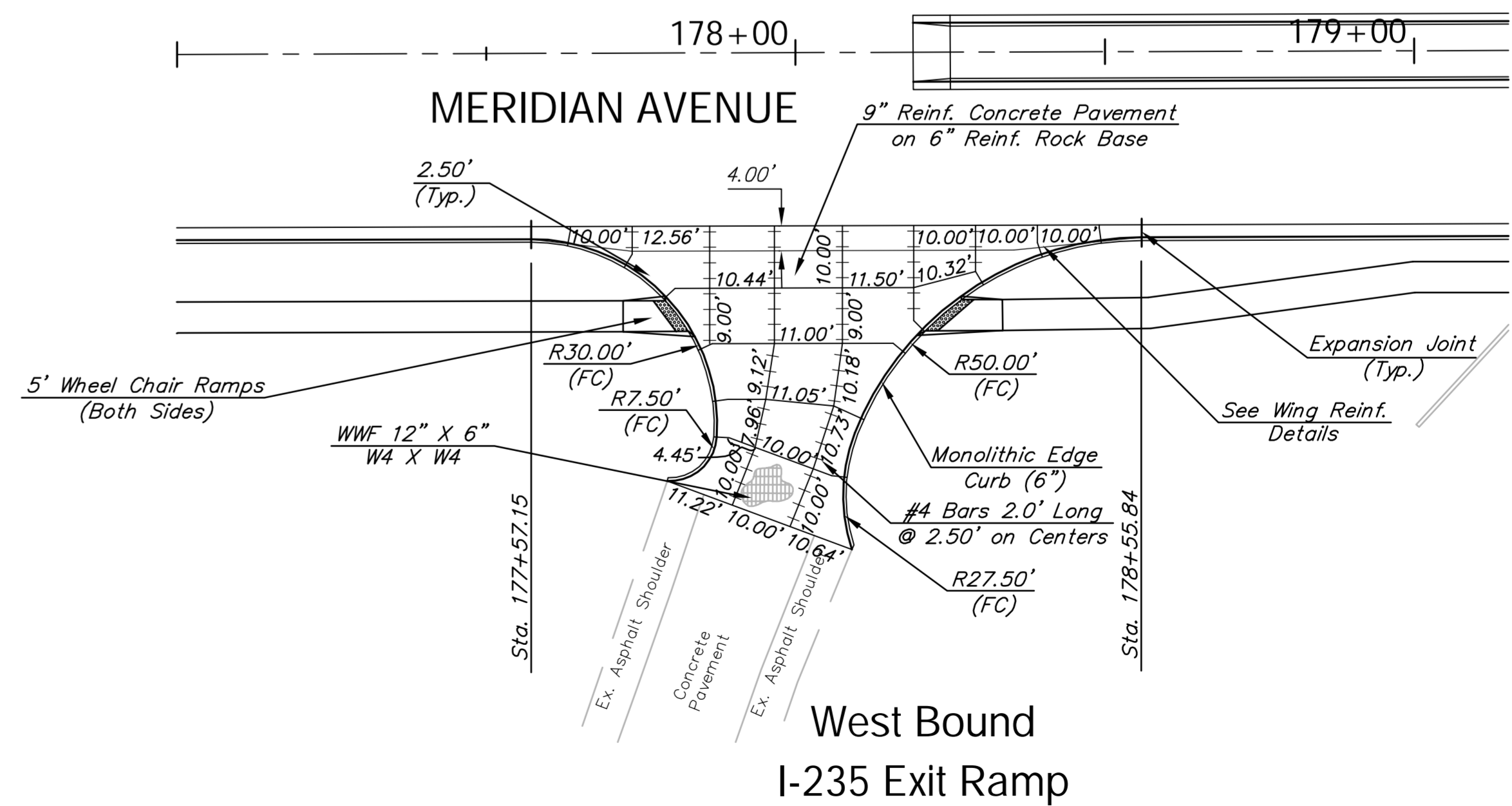

West Bound  
I-235 Exit Ramp

Drawing File: E:\eng\Meridian\47th to 31st\Details\I-235 details.dwg

Design: T. CURRY  
Drawn: T. CURRY  
Approved: TPV  
Scale: 1" = 20'

Project No. 0510E396 CAPITAL IMPROVEMENT PROJECT

I-235 RAMP JOINT PLAN

MERIDIAN AVENUE - 47TH STREET SOUTH TO 31ST STREET SOUTH

**Baughman Company, P.A.**  
315 Ellis St., Wichita, KS 67211 P 316-262-0149 F 316-262-0149  
Baughman ENGINEERING | SURVEYING | PLANNING | LANDSCAPE ARCHITECTURE

September 2009  
SHEET 44 OF 187