

BENCHMARK:  
 BM #5 - "C" Chiseled in the Back of Curb in the North  
 Curb Line of 43th Street South  
 Sta. 124+50, 98' Lt.  
 Elev. = 1281.40 MSL

The Existing 6" Kansas Gas Line Running  
 Parallel to the Proposed SWS System is to  
 Remain in Place During Construction. The  
 Contractor Shall Contact Jim Coe with KGS at  
 832-3126 to Coordinate Bracing, Support, etc.

SCALE:  
 HORIZONTAL: 1" = 20'  
 VERTICAL: 1" = 5'

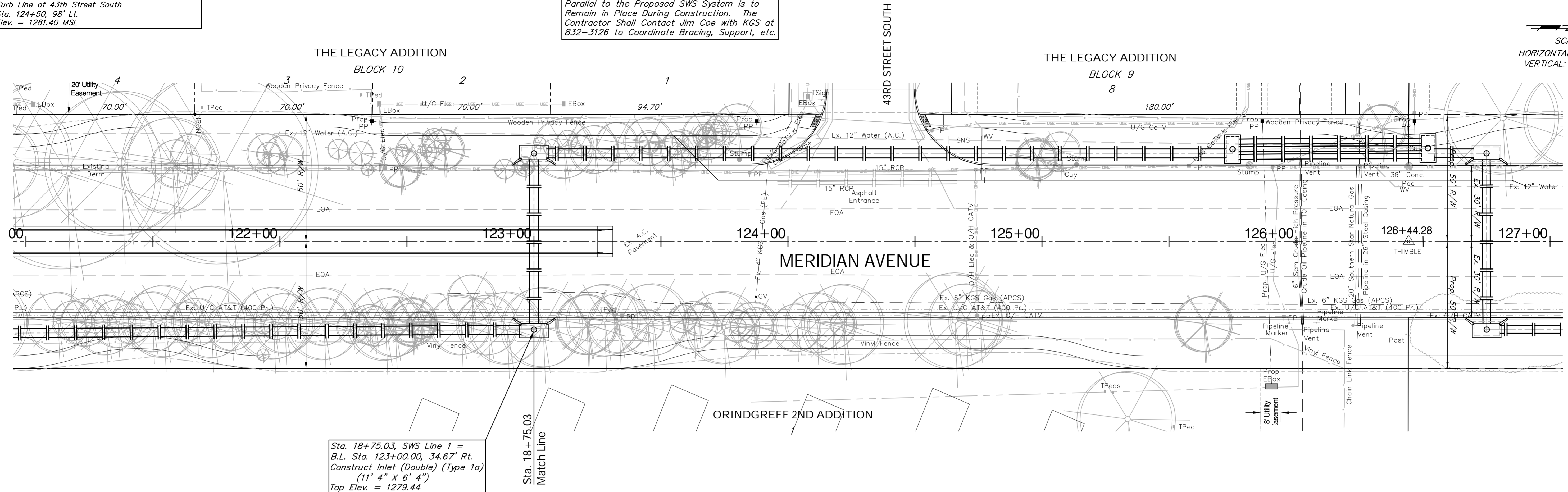

Sta. 18+75.03, SWS Line 1 =  
 B.L. Sta. 123+00.00, 34.67' Rt.  
 Construct Inlet (Double) (Type 1a)  
 (11' 4" X 6' 4")  
 Top Elev. = 1279.44

Sta. 18+75.03  
 Match Line

ORINDGREFF 2ND ADDITION

