

**BENCHMARK:**  
 BM #5 - "C" Chiseled in the Back of Curb in the North  
 Curb Line of 43th Street South  
 Sta. 124+50, 98' Lt.  
 Elev. = 1281.40 MSL

The Existing 6" Kansas Gas Line Running  
 Parallel to the Proposed SWS System is to  
 Remain in Place During Construction. The  
 Contractor Shall Contact Jim Coe with KGS at  
 832-3126 to Coordinate Bracing, Support, etc.

SCALE:  
 HORIZONTAL: 1" = 20'  
 VERTICAL: 1" = 5'

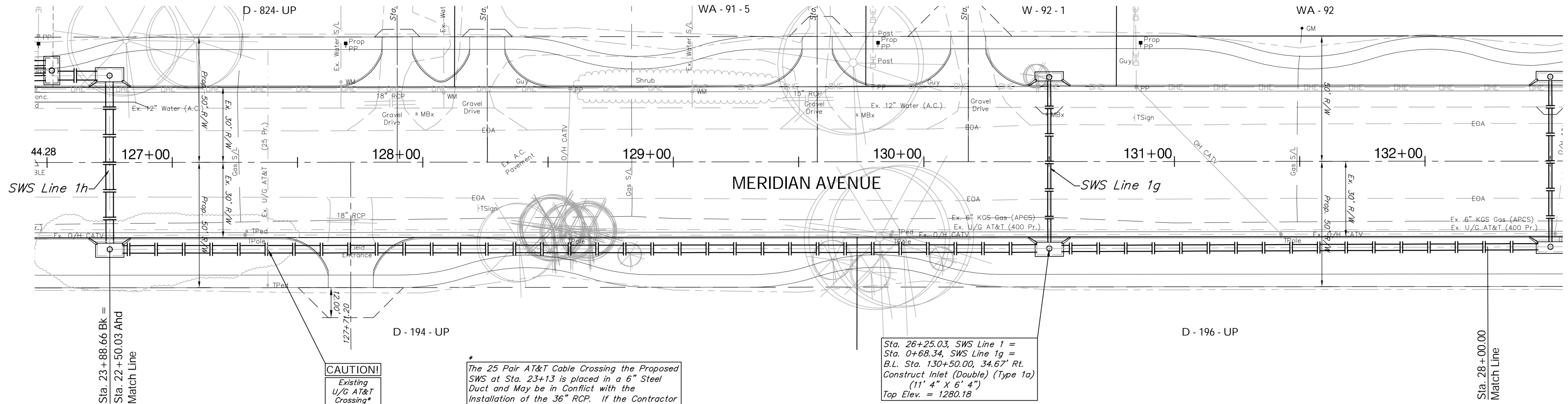

**CAUTION!**  
 Existing  
 U/G AT&T  
 Crossing\*

\*  
 The 25 Pair AT&T Cable Crossing the Proposed  
 SWS at Sta. 23+13 is placed in a 6" Steel  
 Duct and May be in Conflict with the  
 Installation of the 36" RCP. If the Contractor  
 is Unable to Lower or Work Around the Duct,  
 Contact John Fagan with AT&T at 268-2102.

Sta. 26+25.03, SWS Line 1 =  
 Sta. 0+68.34, SWS Line 1g =  
 B.L. Sta. 130+50.00, 34.67' Rt.  
 Construct Inlet (Double) (Type 1a)  
 (11' 4" X 6' 4")  
 Top Elev. = 1280.18

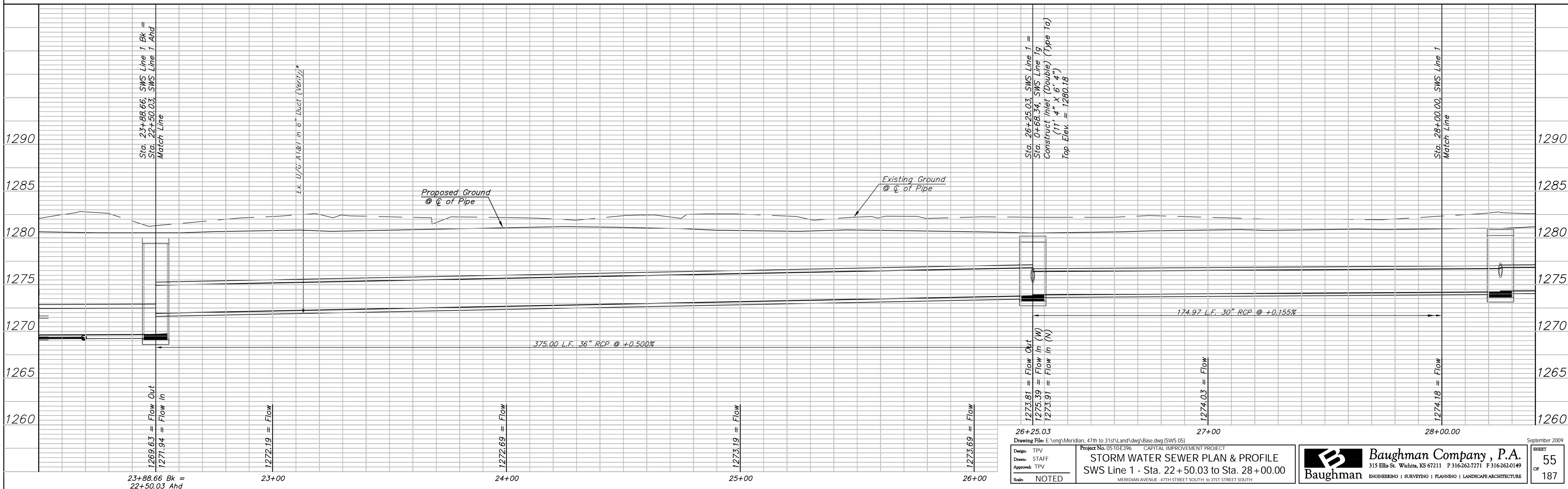

26+25.03  
 Drawing File: E:\eng\Meridian\_47th to 31st\Land\dwg\Base.dwg (SWS 05)  
 Project No. 0510E396 CAPITAL IMPROVEMENT PROJECT  
**STORM WATER SEWER PLAN & PROFILE**  
 SWS Line 1 - Sta. 22+50.03 to Sta. 28+00.00  
 MERIDIAN AVENUE - 47TH STREET SOUTH TO 31ST STREET SOUTH

Baughman Company, P.A.  
 315 Ellis St., Wichita, KS 67211 P 316-262-0149 F 316-262-0149  
 ENGINEERING | SURVEYING | PLANNING | LANDSCAPE ARCHITECTURE

September 2009  
 SHEET 55 OF 187