

BENCHMARK:
 BM #6 - "C" Chiseled in the Base at the South End of the Concrete Privacy Wall
 Sta. 139+69, 52' Rt.
 Elev. = 1282.88 MSL

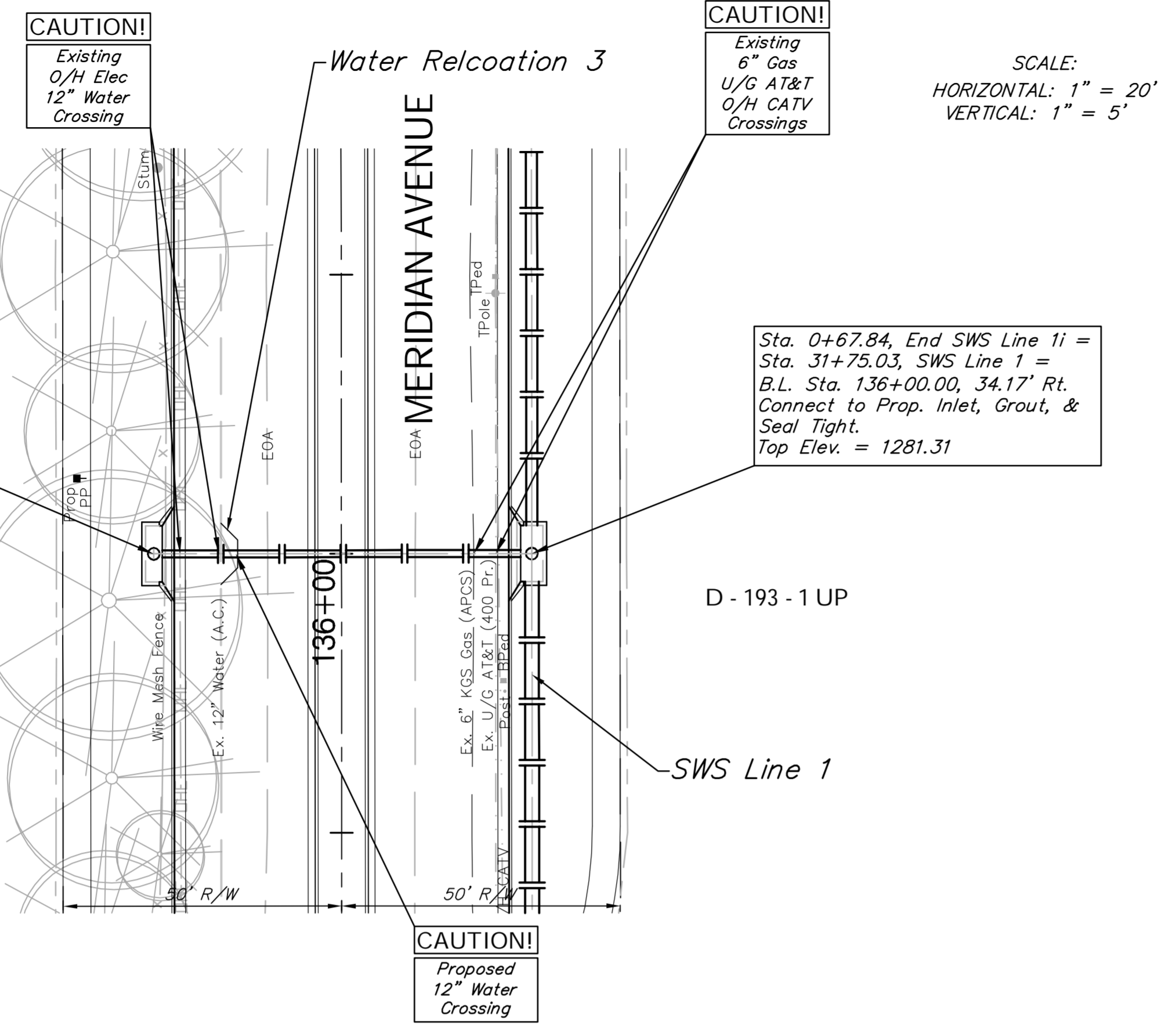

Sta. 0+00.00, Begin SWS Line 1i =
 B.L. Sta. 132+50.00, 33.67' Lt.
 Construct Inlet (Double) (Type 1a)
 (11' 4" X 4' 4")
 Top Elev. = 1281.31

Sta. 0+67.84, End SWS Line 1i =
 Sta. 31+75.03, SWS Line 1 =
 B.L. Sta. 136+00.00, 34.17' Rt.
 Connect to Prop. Inlet, Grout, &
 Seal Tight.
 Top Elev. = 1281.31

BENCHMARK:
 BM #7 - "C" Chiseled in the Base of the Concrete Privacy Wall
 Sta. 144+80, 52' Rt.
 Elev. = 1283.19 MSL

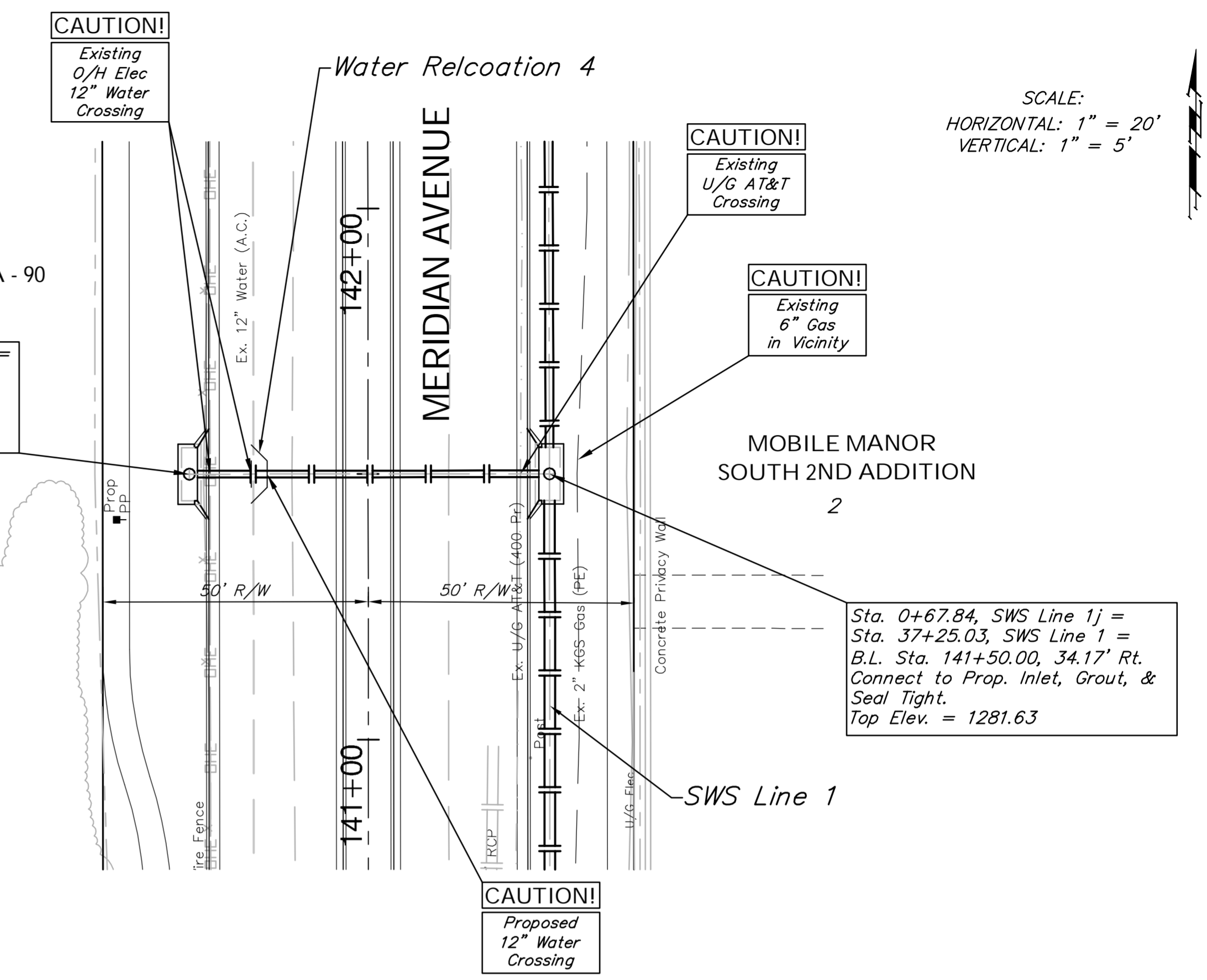

Sta. 0+00.00, Begin SWS Line 1j =
 B.L. Sta. 132+50.00, 33.67' Lt.
 Construct Inlet (Double) (Type 1a)
 (11' 4" X 4' 4")
 Top Elev. = 1281.63

Sta. 0+67.84, SWS Line 1j =
 Sta. 37+25.03, SWS Line 1 =
 B.L. Sta. 141+50.00, 34.17' Rt.
 Connect to Prop. Inlet, Grout, &
 Seal Tight.
 Top Elev. = 1281.63

