

BENCHMARK:
 BM #11 - "C" Chiseled in the Top of the Curb on the South Side of Median at Church Entrance
 Sta. 166+69, 56' Lt.
 Elev. = 1285.34 MSL

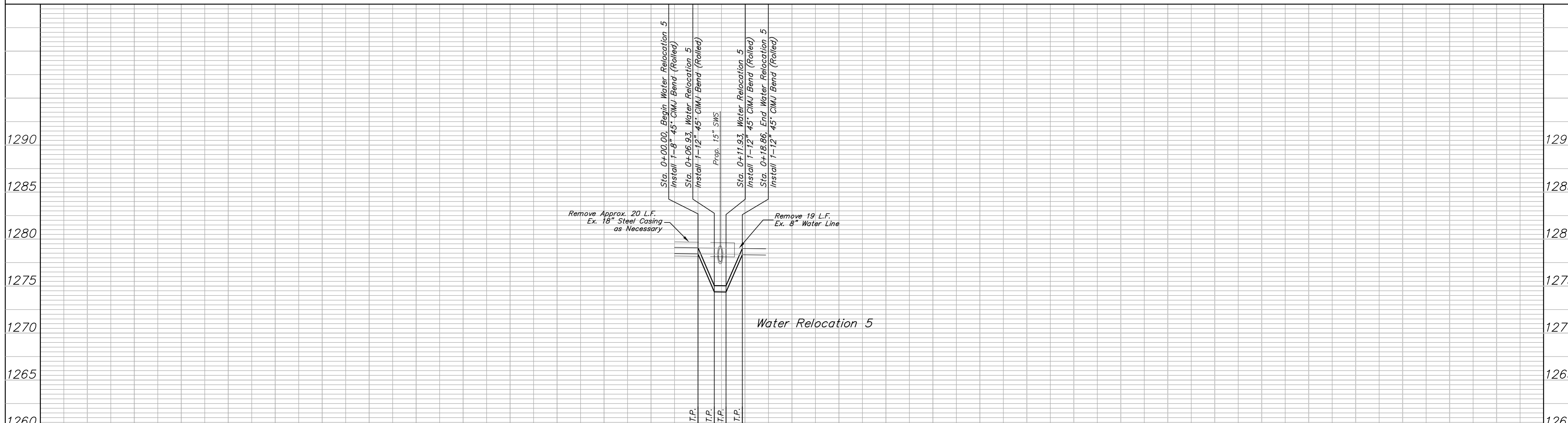
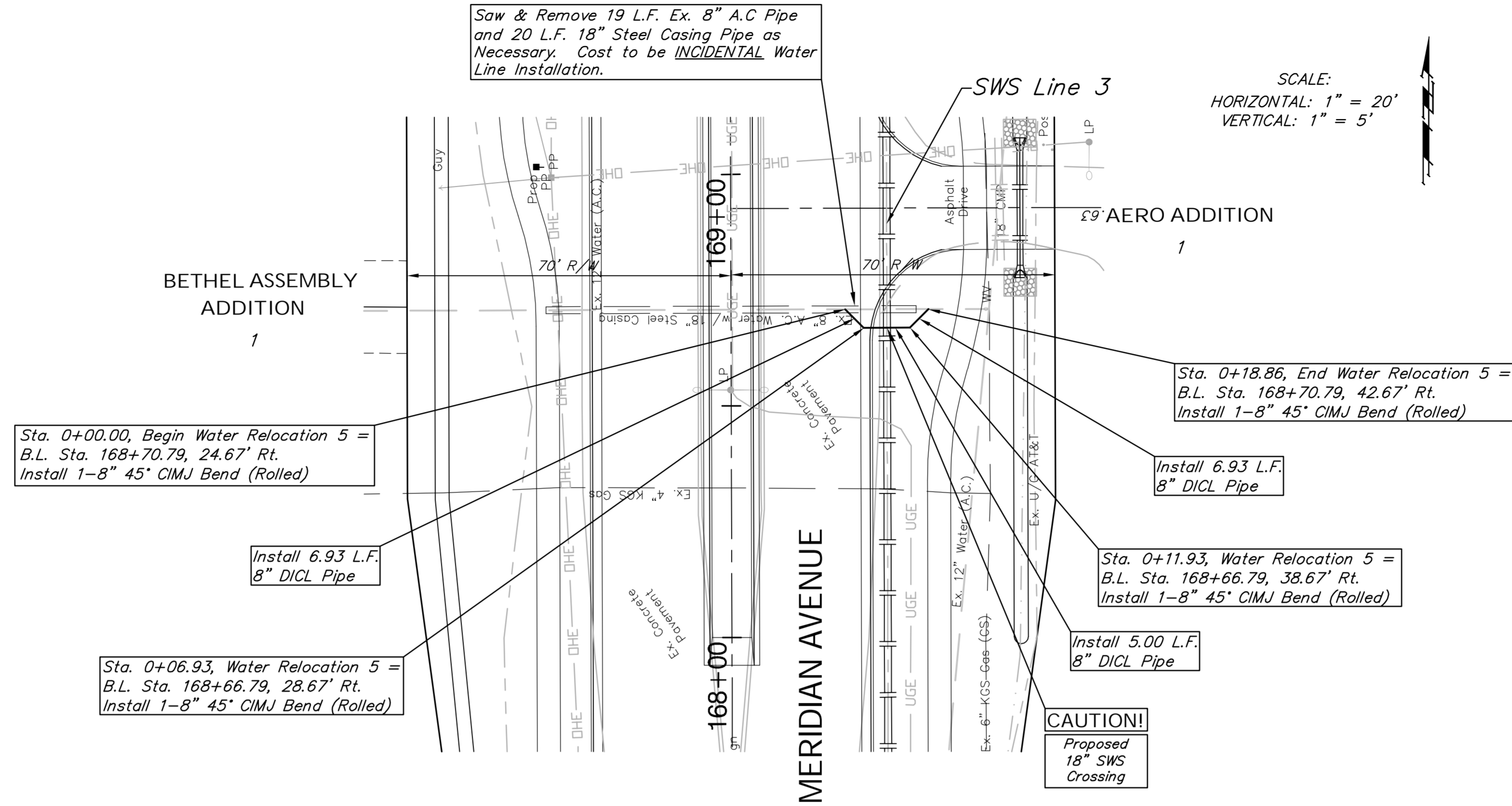

Drawing File: E:\eng\Meridian\47th to 31st\Land\dwg\Base.dwg (Water Relocation 03)
 Project No. 0510E396 CAPITAL IMPROVEMENT PROJECT
 Design: TPV
 Drawn: TPV
 Approved: TPV
 Scale: NOTED

WATER RELOCATION 5
 PLAN/PROFILE

MERIDIAN AVENUE - 47TH STREET SOUTH to 31ST STREET SOUTH

Baughman Company, P.A.
 315 Ellis St., Wichita, KS 67211 P 316-262-7171 F 316-262-0149
 Baughman ENGINEERING | SURVEYING | PLANNING | LANDSCAPE ARCHITECTURE

September 2009
 SHEET 99
 OF 187