

BENCHMARK:
 BM #11 - "C" Chiseled in the Top of the Curb on the South Side of Median at Church Entrance
 Sta. 166+69, 56' Lt.
 Elev. = 1285.34 MSL

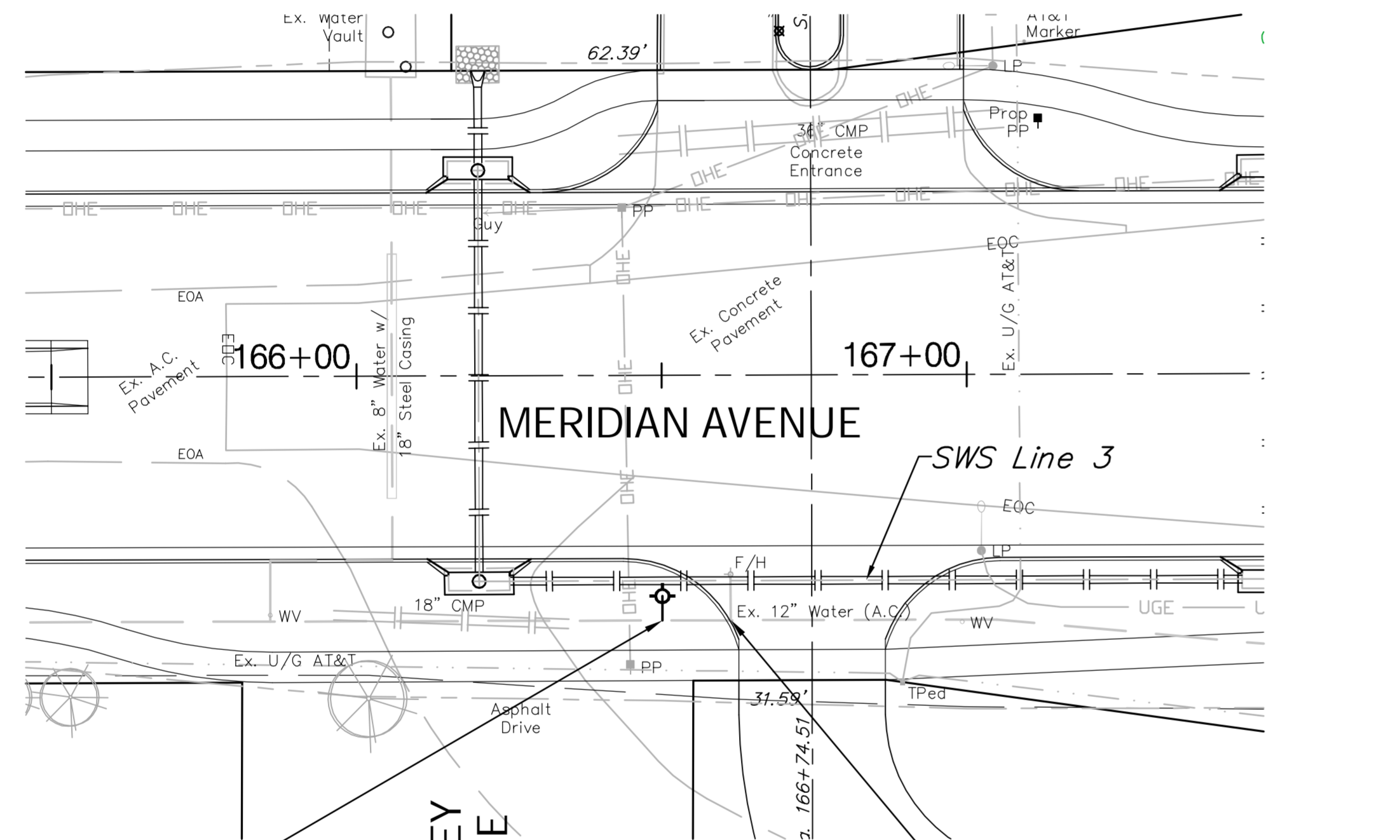

B.L. Sta. 66+50.00, 40.16' Rt.
 Saw & Remove Ex. 12" Water Line as Necessary to Install 1-Fire Hydrant Assy. (W)
 L = 4.00'
 Bury Line Elev. = 1282.92
 Valve Box Elev. = 1283.01

B.L. Sta. 66+61.19, 40.16' Rt.
 Remove Ex. Fire Hydrant Assy. & Salvage to the City of Wichita Water Dept.

BENCHMARK:
 BM #17 - City of Wichita Disc on the North Hubguard of the RCBC in the Northwest Corner of the Intersection of Meridian and 31st Street North
 Sta. 206+50, 40' Lt.
 Elev. = 1284.28 MSL

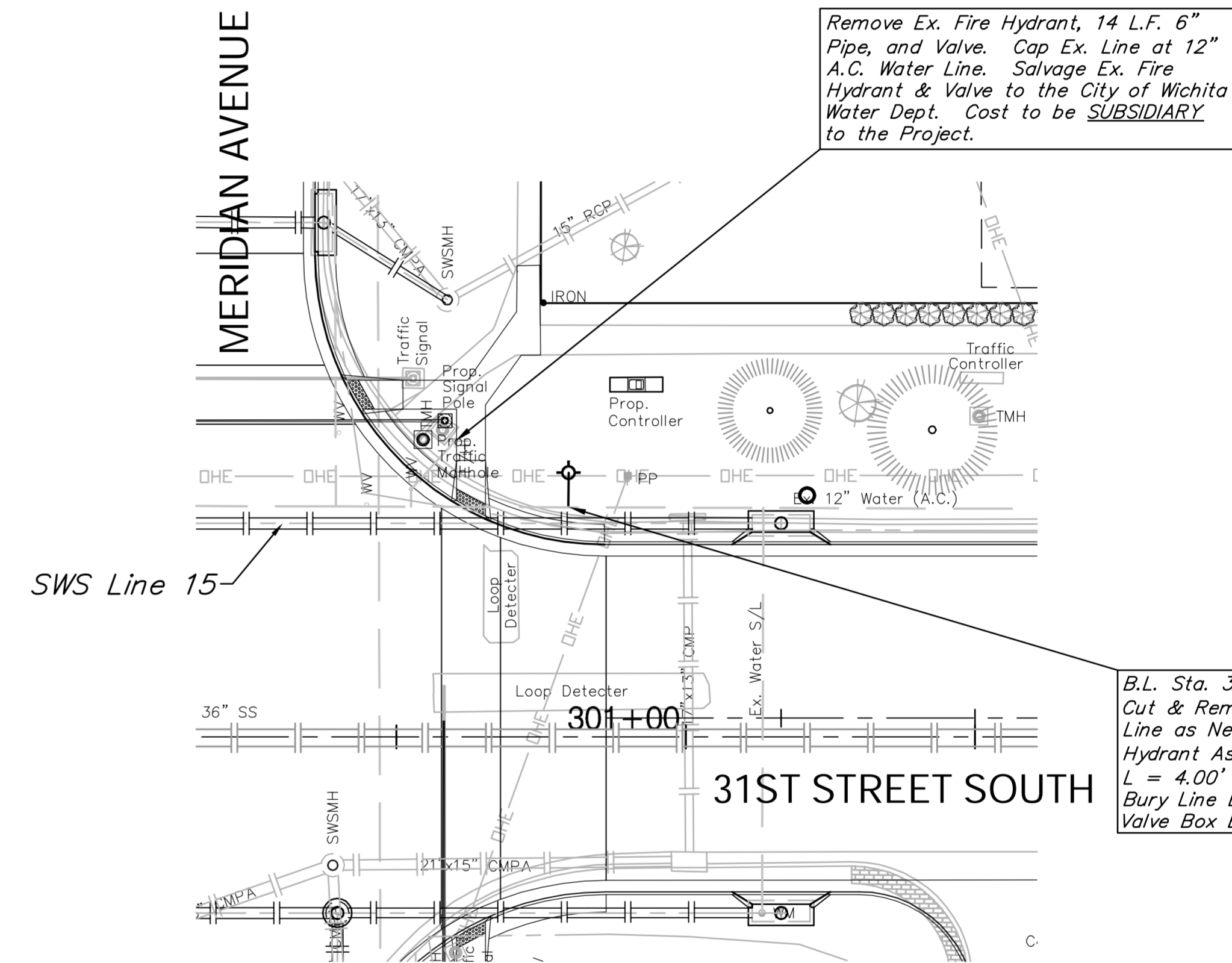

B.L. Sta. 300+79.73, 39.69' Rt.
 Cut & Remove Ex. 12" A.C. Water Line as Necessary to Install 1- Fire Hydrant Assy. (N)
 L = 4.00'
 Bury Line Elev. = 1284.33
 Valve Box Elev. = 1283.95

Drawing File: E:\eng\Meridian-47th to 31st\Land\dwg\Bse.dwg (Fire Hydrant)

Design: TPV
 Drawn: STAFF
 Approved: TPV
 Scale: 1" = 20'

Project No. 0510E396 CAPITAL IMPROVEMENT PROJECT

FIRE HYDRANT RELOCATION

MERIDIAN AVENUE - 47TH STREET SOUTH TO 31ST STREET SOUTH

Baughman Company, P.A.
 315 Ellis St., Wichita, KS 67211 P 316-262-7171 F 316-262-0149
 Baughman ENGINEERING | SURVEYING | PLANNING | LANDSCAPE ARCHITECTURE

September 2009
 SHEET 103 OF 187