

BILL OF MATERIALS		
ITEM	UNIT	QTY
POLE MOUNTED CONTROLLER & CABINET	EACH	1
TRAFFIC SIGNAL HEAD (SEE CHART A) W/ MOUNTING HARDWARE	EACH	6
PEDESTRIAN SIGNAL HEAD (16" COMB.) W/ MOUNTING HARDWARE	EACH	2
TRAFFIC SIGNAL POLE - STEEL	EACH	2
CONCRETE FOOTING - POLE	EACH	2
CONDUIT ELBOW 90°	EACH	As Req'd
CONDUIT ELBOW 90° 3"	EACH	As Req'd
BACK PLATE 5" - 3 SECTION	EACH	4
TRAFFIC MANHOLE	EACH	2
GROUND ROD & CLAMP	EACH	3
CONDUIT CLAMP	EACH	As Req'd
TRAFFIC SIGNAL LAMP RED LED KIT	EACH	6
TRAFFIC SIGNAL LAMP YELLOW LED KIT	EACH	6
TRAFFIC SIGNAL LAMP GREEN LED KIT	EACH	6
PEDESTRIAN SIGNAL LAMP LED (16" COMBINATION W/ COUNTDOWN)	EACH	2
ENTRANCE HEAD	EACH	1
CIRCUIT BREAKER & BOX	EACH	1
GUY WIRE GUARD	EACH	As Req'd
GUY WIRE CLAMP	EACH	As Req'd
THIMBLE EYE ANCHOR ROD	EACH	As Req'd
PEDESTRIAN PUSHBUTTON W/SIGN	EACH	2
LEAD-IN WIRE No. 4 A.W.G. 1/C (TYPE THHN)	LIN. FT.	-
STANDARD 1/C #8 (GROUND)	LIN. FT.	361
MULTI-CONDUCTOR CABLE No. 14 A.W.G. 7/C	LIN. FT.	188
CONDUIT 1.5" RGC	LIN. FT.	54
CONDUIT 2" RGC	LIN. FT.	21
CONDUIT 3" RGC	LIN. FT.	73

SIGNAL INVENTORY				
NO. WAYS	NO. SECTIONS (Per Face)	SIGNAL FACE ARRANGEMENT	MOUNTING TYPE	QTY
1	3	A	TYPE I	4
1	3	A	TYPE III	2
1	1	K (SYMB)	TYPE II	2

TRAFFIC MANHOLE	
STATION	DIST. - SIDE
Sta. 188+45.50	38.00' Rt.
Sta. 188+56.00	36.50' Lt.

TRAFFIC SIGNAL POLES						
STATION	DIST.	SIDE	ARM LENGTH	NO. OF SIGNALS ON ARM	SIGNAL SPACING	TYPE
Sta. 188+45.50	36.50'	Lt.	26.0'	2	13.3'-11.0'	STD
Sta. 188+54.20	41.50'	Rt.	31.0'	2	19.0'-11.0'	STD

CONDUIT		
CONDUIT SIZE	TRENCHED	PUSHED
1.5" RGC	53.9	-
2" RGC	20.7	-
3" RGC	72.9	-

TYPICAL SIGNAL HEADS

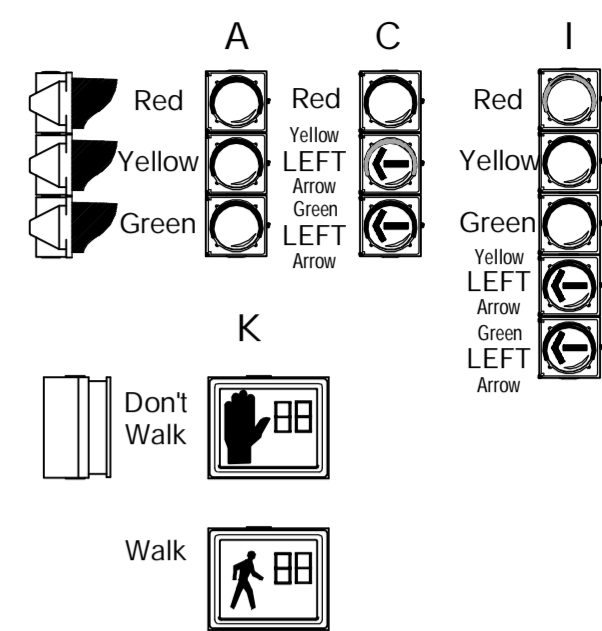

GENERAL NOTES

- The Contractor shall be responsible for furnishing and installing the controller, cabinet, concrete base, and for all equipment necessary for the complete and satisfactory operation of the traffic signal, whether said equipment is specifically mentioned or not.
- Lengths given are to the centerline of pole/box and do not include lengths for elbows and risers.
- Signal heads, pedestrian signals, traffic signs, etc. shall include all brackets, hardware, & other incidentals necessary for installation.
- See City of Wichita Standard Specifications for additional wiring notes.
- Quantities are for Information Only.

SPECIAL FINISH FOR TRAFFIC SIGNAL EQUIPMENT:

The brackets, sign blank backs, signal backs and other exposed surfaces shall be shop painted with an aerosol lacquer cellulose ester to match the traffic signal pole color. The contractor shall submit two copies of the proposed coating system to the City for approval to application.

TRAFFIC SIGNAL POLE, PEDESTAL, & CONTROLLER
CABINET EXTERIOR COATING:

In addition to being galvanized, all exterior surfaces shall be coated with a zinc rich epoxy powder to a minimum dry film thickness of 2.0 mils. The coating shall be electrostatically applied and partially cured in a gas fired convection oven by heating the steel substrate to a minimum of 250 degrees Fahrenheit.

The powder primed surface shall be coated with an intermediate coat of polyester powder to a minimum dry film thickness of 2.0 mils. The coating shall be electrostatically applied and cured by heating the steel substrate in a convection oven to minimum of 350 degrees and a maximum of 400 degrees Fahrenheit.

The intermediate coat shall be top coated with one coat of high-build acrylic polyurethane enamel to a minimum dry film thickness of 2.0 mils. The coating shall be electrostatically applied and cured by heating the substrate in a convection oven to a minimum of 225 degrees Fahrenheit. The final top coating color shall be BLACK.

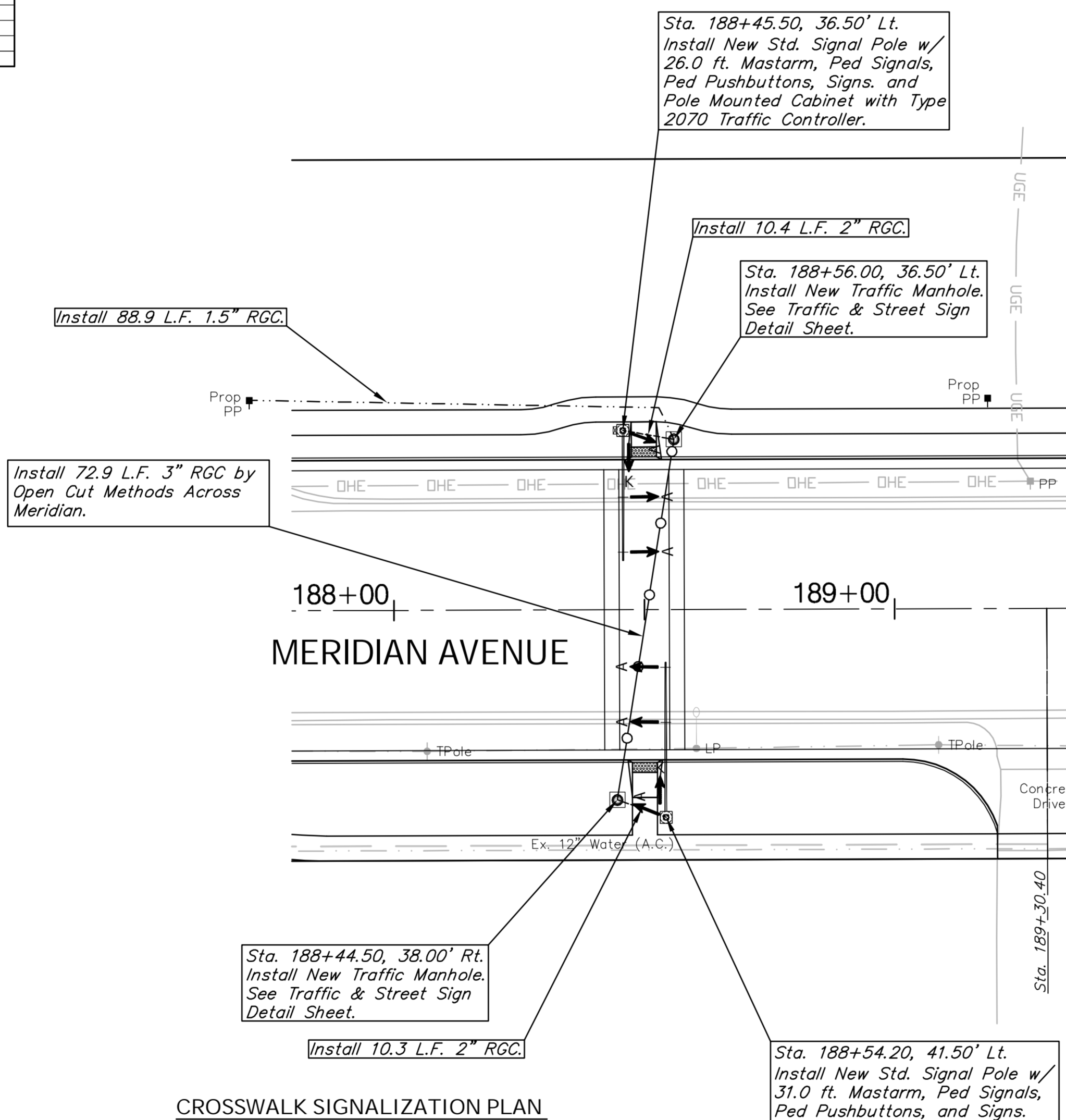

CROSSWALK SIGNALIZATION PLAN

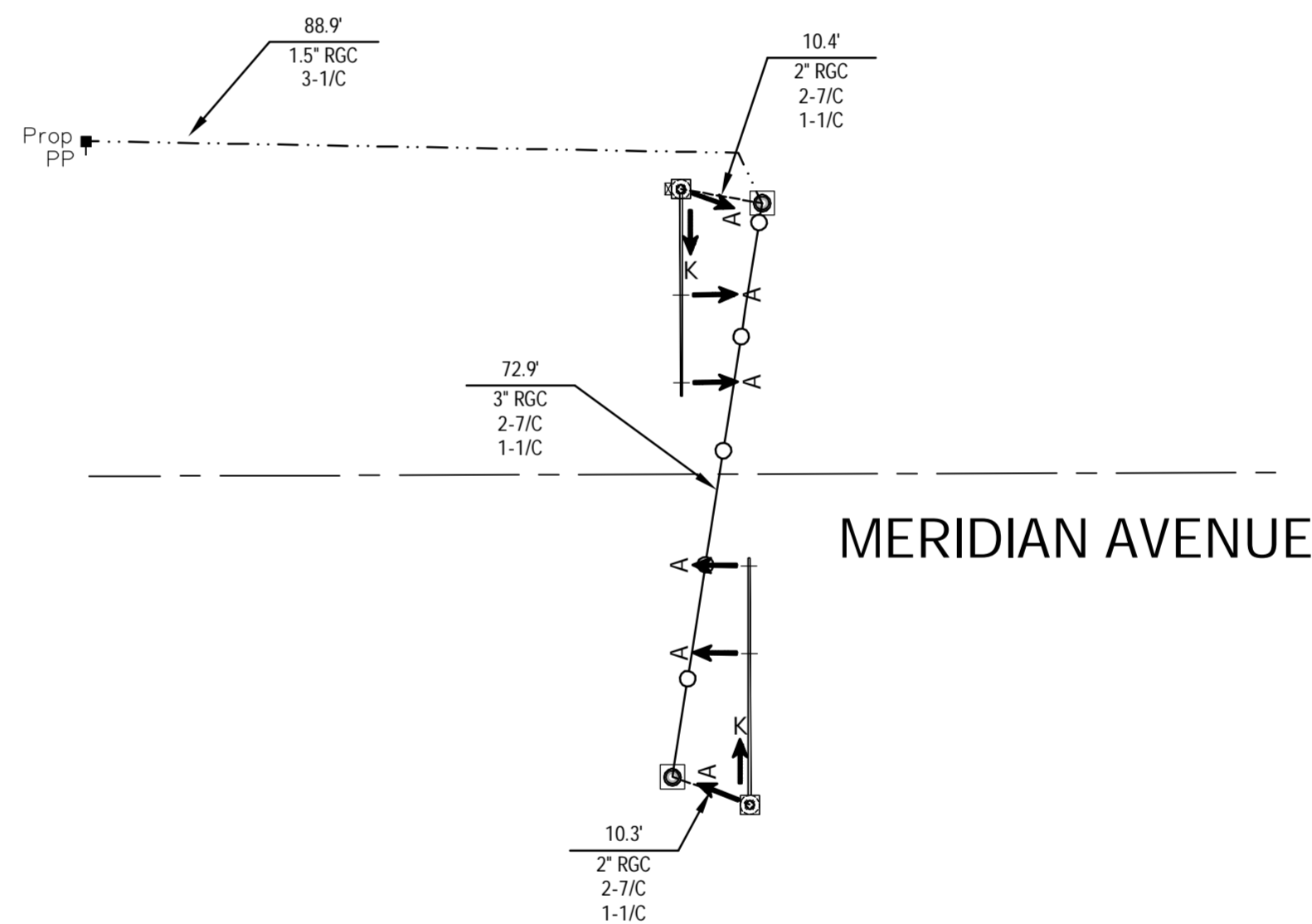

CROSSWALK WIRING PLAN

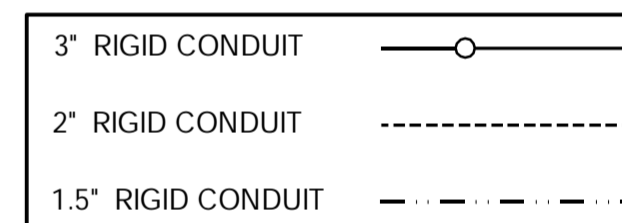

EQUIPMENT SPECIFICATIONS
2070 CONTROLLER

- A. Controller Units: The 2070L controllers supplied shall meet the requirements outlined in CalTrans TEES 2002 (latest revision), and the following requirements:
- The 2070L controller shall have a 19" EIA rack mountable chassis (mated to the 170 cabinet).
 - 2070-1B CPU module with RJ-45 Ethernet port.
 - 2070-2A C1 field I/O module for compatibility with CalTrans style C1 connector.
 - 2070-3B 8X40 front panel with LCD display.
 - 2070-4A 10 amp power supply.
 - 2070-7A asynchronous serial communications module (RS-232).
 - Any unused slot position shall have a cover plate.
- B. Conflict Monitors: The Conflict Monitors supplied shall be Model 2010 ECL conflict monitors with Ethernet capabilities.
- 1 - Loop-back cable for 2070-2A Field I/O (Type 170, 104 pin and 37 pin connector).
 - 1 - Loop-back cable for 2070-7A Port

Drawing File: E:\eng\Meridian_47th to 31st\Land\dwg\Base.dwg (Crosswalk)

Design: TPV
Drawn: TPV
Approved: TPV
Scale: NOTED

Project No. 0510E396 CAPITAL IMPROVEMENT PROJECT

MERIDIAN AVENUE CROSSWALK
SIGNALIZATION & WIRING PLAN
MERIDIAN AVENUE - 47TH STREET SOUTH TO 31ST STREET SOUTH

Baughman Company, P.A.
315 Ellis St., Wichita, KS 67211 P 316-262-7171 F 316-262-0149
ENGINEERING | SURVEYING | PLANNING | LANDSCAPE ARCHITECTURE

September 2009
SHEET 108 OF 187