

MERIDIAN AVENUE - 47TH STREET SOUTH to 31ST STREET SOUTH

SOUTH BOUND MERIDIAN AVENUE DETOUR PLAN

DETOUR DETAIL

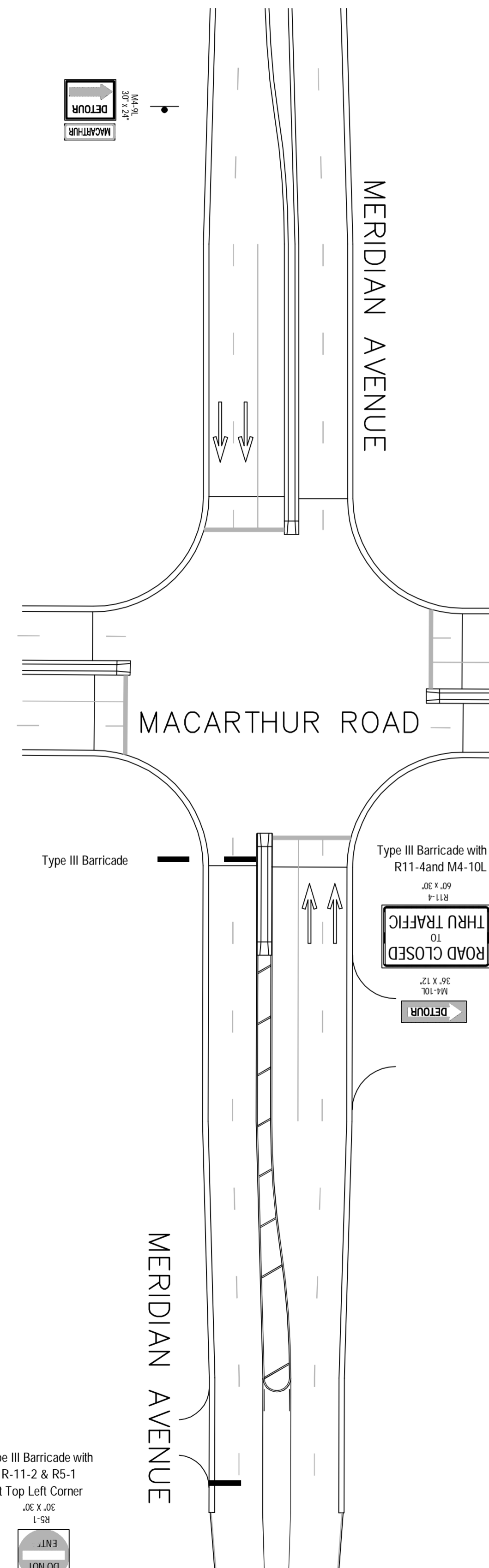

See Detail This Sheet

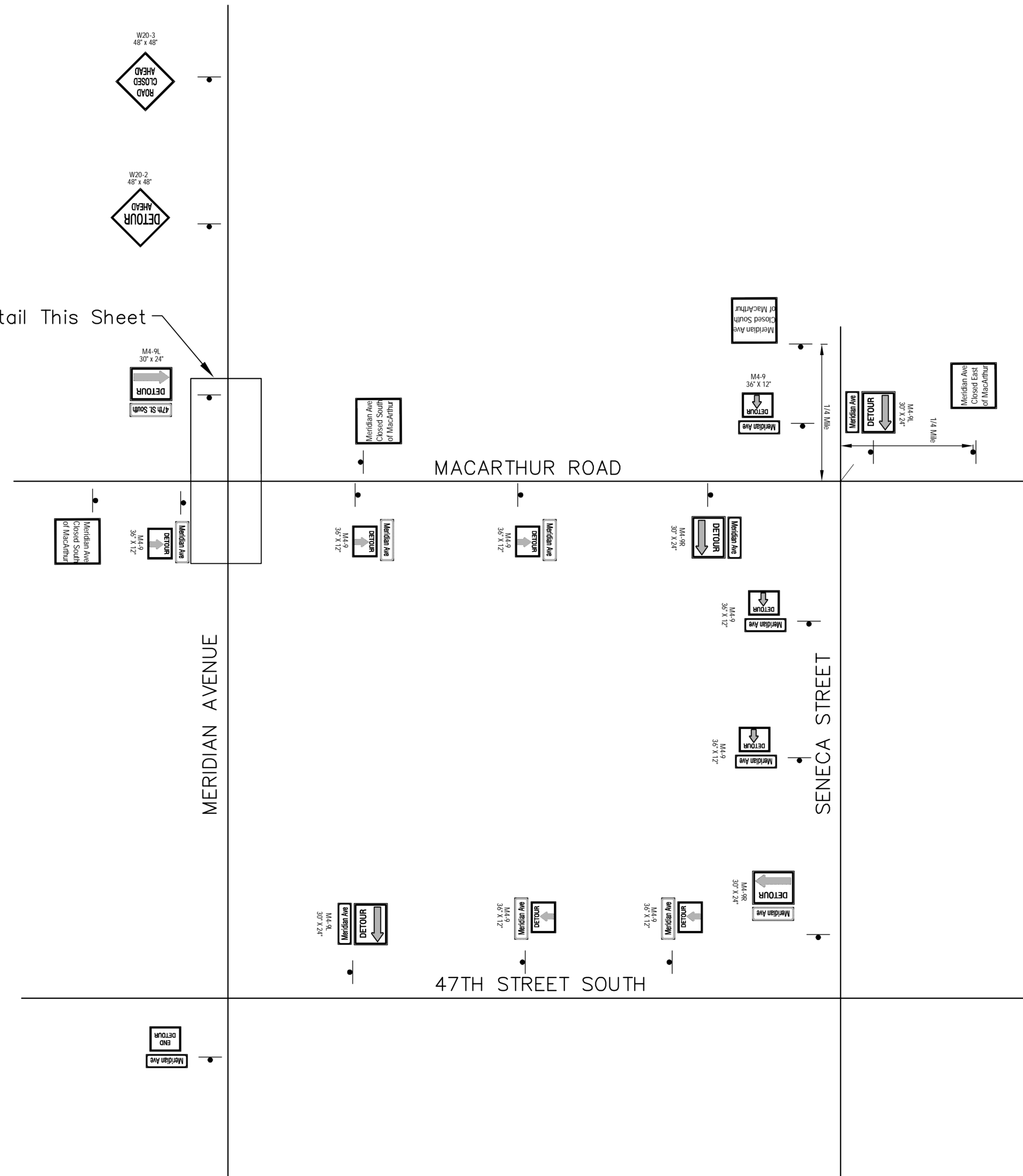

Traffic will be carried north-bound only on Meridian Avenue through portions of the construction. South-bound traffic on Meridian Avenue shall be detoured at MacArthur, East to Seneca, then South to 47th Street South, and then back West to Meridian.

Contractor shall provide, erect, and maintain traffic control devices in accordance with the Manual on Uniform Traffic Control Devices (M.U.T.C.D.) as shown on the Traffic Control plans and subject to the Engineer's approval.

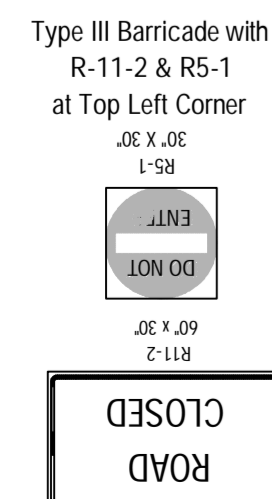

Drawing File: E:\eng\Meridian-47th to 31st\Traffic\ConSeq Base.dwg (Detour)

Project No. 0510E396 CAPITAL IMPROVEMENT PROJECT

DESIGN: TPV
 DRAWN: TPV
 APPROVED: TPV
 SCALE: None

MERIDIAN AVENUE DETOUR PLAN

MERIDIAN AVENUE - 47TH STREET SOUTH to 31ST STREET SOUTH

Baughman Company, P.A.
 315 Ellis St., Wichita, KS 67211 P 316-262-7171 F 316-262-0149
 Baughman ENGINEERING | SURVEYING | PLANNING | LANDSCAPE ARCHITECTURE

September 2009

SHEET
 122
 OF
 187