

MERIDIAN AVENUE

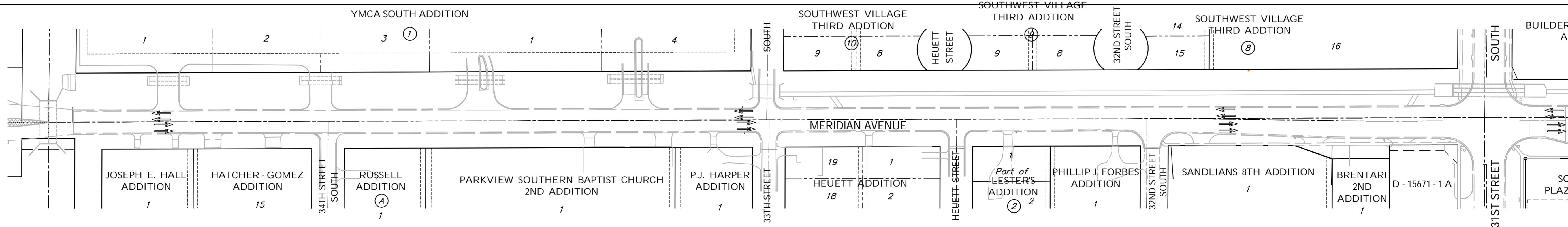

31st STREET SOUTH

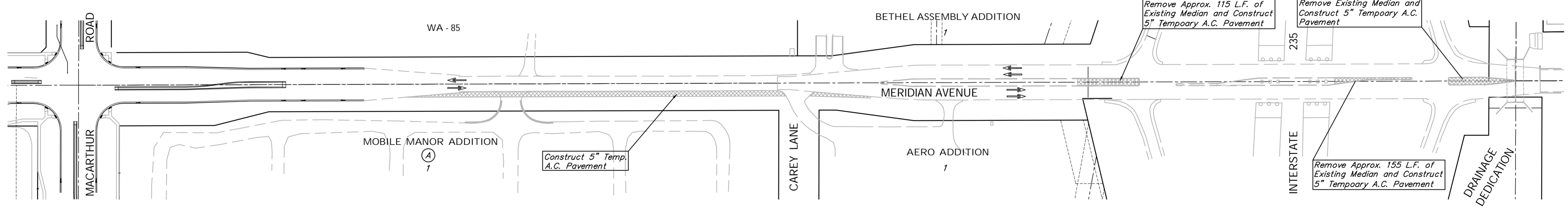
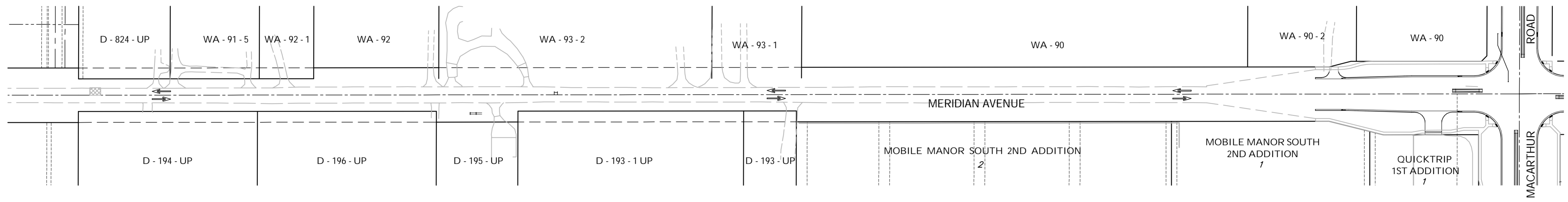
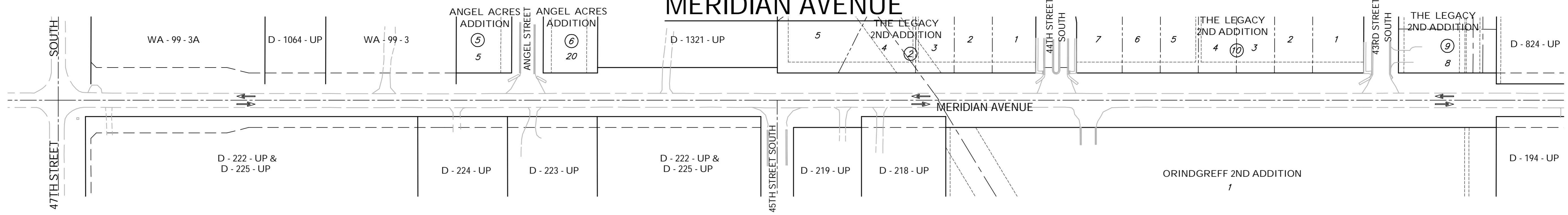
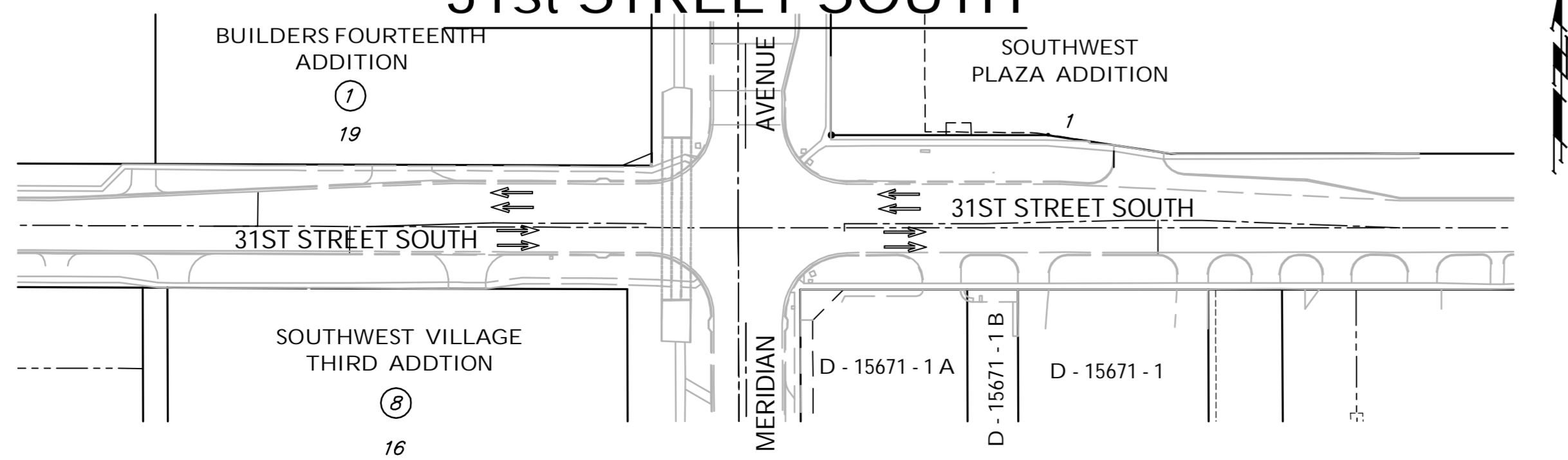

LEGEND

- Work Area
- Temp. A.C. Pavement
- Reflectorized Drum (40' Spacing)
- Tubular Marker (30' Spacing)
- Type III Barricade
- Traffic Flow Pattern

PAVEMENT QUANTITIES FOR PHASE 1

Temporary A.C. Pavement - 1,140 S.Y.

PHASE 1

Remove conflicting trees, shrubs, fences, etc. throughout Project. Use lighted information boards and/or traffic signs to inform public that traffic on Meridian Avenue from 47th Street South to MacArthur will be north-bound only during portions of the construction. Set up detour for south-bound traffic on Meridian Avenue at MacArthur east to Seneca Street using signs, barricades, etc. Construct 10' wide Temporary A.C. Pavement lane on the east side of Meridian from north of the MacArthur improvements to Carey Lane. Two-way traffic is to be maintained on 47th Street South and Meridian on the existing pavement. Flagmen may be used to close short sections of road during the day as necessary. Local access to residences shall be maintained.

Drawing File: E:\Meridian\Traffic\Con Seg Base.dwg (Phase 1)
 Date: ENGINEER
 Drawn: STAFF
 Approved: ENGINEER
 Scale: 1" = 100'

Project No. 0510E396 CAPITAL IMPROVEMENT PROJECT
MERIDIAN AVENUE CONSTRUCTION SEQUENCING PLAN - PHASE 1
 MERIDIAN AVENUE - 47TH STREET SOUTH TO 31ST STREET SOUTH

Baughman Company, P.A.
 315 Ellis St., Wichita, KS 67211 P 316-262-7171 F 316-262-0149
 ENGINEERING | SURVEYING | PLANNING | LANDSCAPE ARCHITECTURE

September 2009
 SHEET 126 OF 187