

**BENCHMARK:**  
 BM #2 - "Chiseled in the Back of Curb in the North Curb Line of Angel  
 Sta. 108+77, 154' Lt.  
 Elev. = 1281.74 MSL

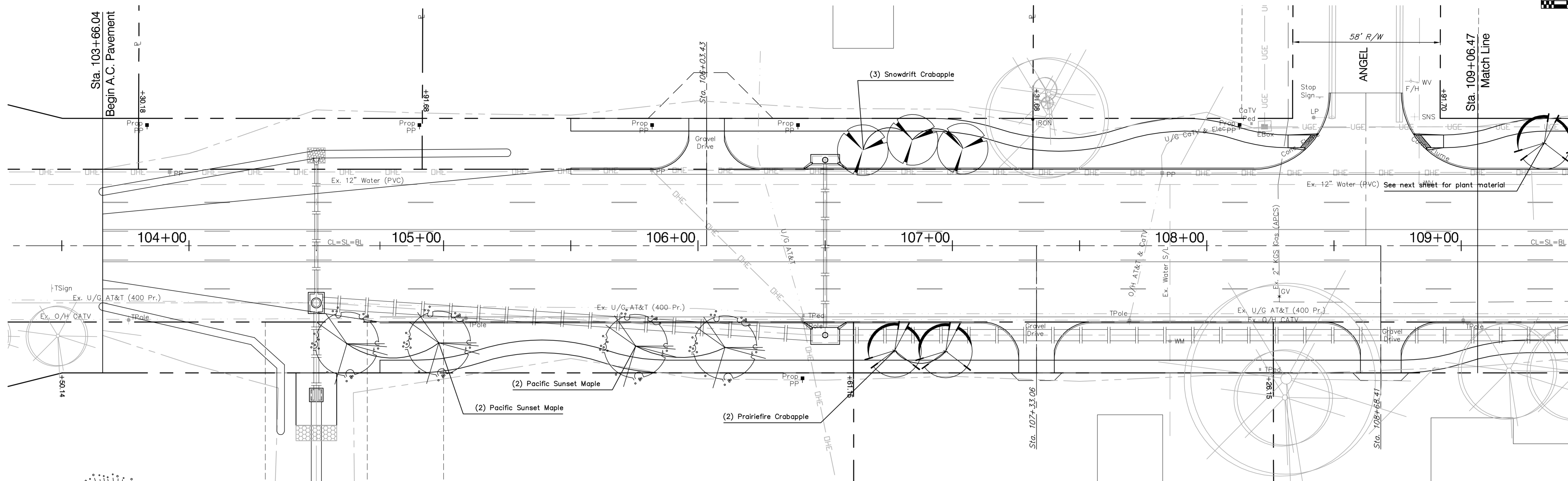
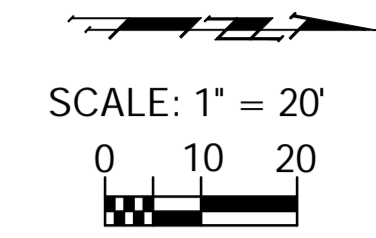

**LANDSCAPE NOTES:**

- All landscape work shall be done in accordance with industry standards.
- All areas called out on the plan as "Sod" shall be installed as follows:  
SOD--Buffalograss Sod "Prestige"
- Trees with broken leaders or no central leader will not be accepted.
- All planting beds shall be prepared by killing all existing vegetation with Round-Up (or equal) according to label directions. A Pre-emergent herbicide such as Treflan (5%) (or equal) shall be applied per label directions. All planting beds to receive 2" organic matter (such as cotton bur mulch, compost, or humus) and shall be rototilled in to a depth of 10-12".
- Mulch all planting beds with min. 3" of mulch. Mulch all tree saucer wells with min. 3" of mulch. Mulch material to be shredded cypress mulch of uniform consistency.
- Metal edging shall be used to separate all turf areas from planting beds. Edging shall be 10 gauge thickness, commercial grade, or approved equal.
- Topsoil hauled onto site shall be fertile, friable, natural loam topsoil, of uniform quality characteristic of representative local soils which produce heavy growth of crops, grass, or other vegetation. It shall be free of trash, or other matter toxic to plant growth.
- Topsoil shall be delivered in an unfrozen and non-muddy condition and shall be subject to approval by the Landscape Architect.
- Prior to any excavation for landscaping purposes the location of underground utilities shall be determined by calling Kansas One Call at 687-2470/1-800-344-7233. Contractor shall be responsible for any damage done to existing utilities.
- Report any discrepancies in the planting plan to the Landscape Architect, prior to starting construction.
- The Landscape Contractor shall coordinate with the G.C. to gain site access to install the plants and maintain grounds, until final acceptance from owner. Upon final acceptance, the one (1) year guarantee period will begin.
- The Landscape Contractor shall coordinate with the G.C. to install the plants and maintain grounds, until final acceptance from owner.
- The Landscape Contractor shall submit bid with unit prices for all plants, including mulch, installation, 1 year guarantee, bed preparation, fertilizer, etc.
- The Landscape Contractor is responsible for any damage done to sidewalks, curbs, pavement, utilities, existing trees to remain, or adjacent property not within project limits when installing or maintaining the plantings before final acceptance.
- General Contractor to coordinate with appropriate Local City Official to Remove/Transplant exist trees.
- Fall planting season shall be September 1 through October 31. Spring planting season shall be April 1 through June 30. For grass seeding, fall season shall be September 1 through mid October. Spring season for seeding shall be from March 15 through mid May.
- Quantities listed on the plant palette are for informational purposes only. Landscape Contractor shall be responsible for calculating quantities necessary to complete the installation of these plans.
- Landscape Contractor shall provide maintenance until final project acceptance including landscape maintenance and watering.

**Plant List - This Sheet**

Quantity	SCIENTIFIC	COMMON	SIZE	METHOD	NOTE
4	Acer truncatum 'Pacific Sunset'	Pacific Sunset Maple	2" Cal	B&B	Full & Healthy
2	Malus 'Prairiefire'	Prarie Fire Crabapple	2" Cal	B&B	Full & Healthy
3	Malus 'Snowdrift'	Snowdrift Crabapple	2" Cal.	B&B	Full & Healthy

**Plant List - Summary**

Quantity	SCIENTIFIC	COMMON	SIZE	METHOD	NOTE
11	Acer rubrum 'October Glory'	October Glory	2" Cal	B&B	Full & Healthy
27	Acer truncatum 'Pacific Sunset'	Pacific Sunset Maple	2" Cal	B&B	Full & Healthy
48	Cercis canadensis ssp. texensis 'Oklahoma'	Oklahoma Redbud	2" Cal	B&B	Full & Healthy
16	Cercis canadensis ssp. texensis 'Oklahoma Whitebud'	Oklahoma Whitebud	2" Cal	B&B	Full & Healthy
60	Malus 'Prairiefire'	Prarie Fire Crabapple	2" Cal	B&B	Full & Healthy
45	Malus 'Snowdrift'	Snowdrift Crabapple	2" Cal.	B&B	Full & Healthy
7	Pistacia chinensis	Chinese Pistache	2" Cal	B&B	Full & Healthy
39	Pyrus calleryana 'Aristocrat'	Aristocrat Pear	2" Cal	B&B	Full & Healthy
10	Quercus shumardii	Shumard Oak	2" Cal	B&B	Full & Healthy
13	Ulmus parvifolia 'Allee'	Lacebark Elm	2" Cal	B&B	Full & Healthy

**Median Turf - Summary**

Quantity	SCIENTIFIC	COMMON	SIZE	METHOD	NOTE
1085		Buffalograss 'Prestige'		Sod	Full & Healthy

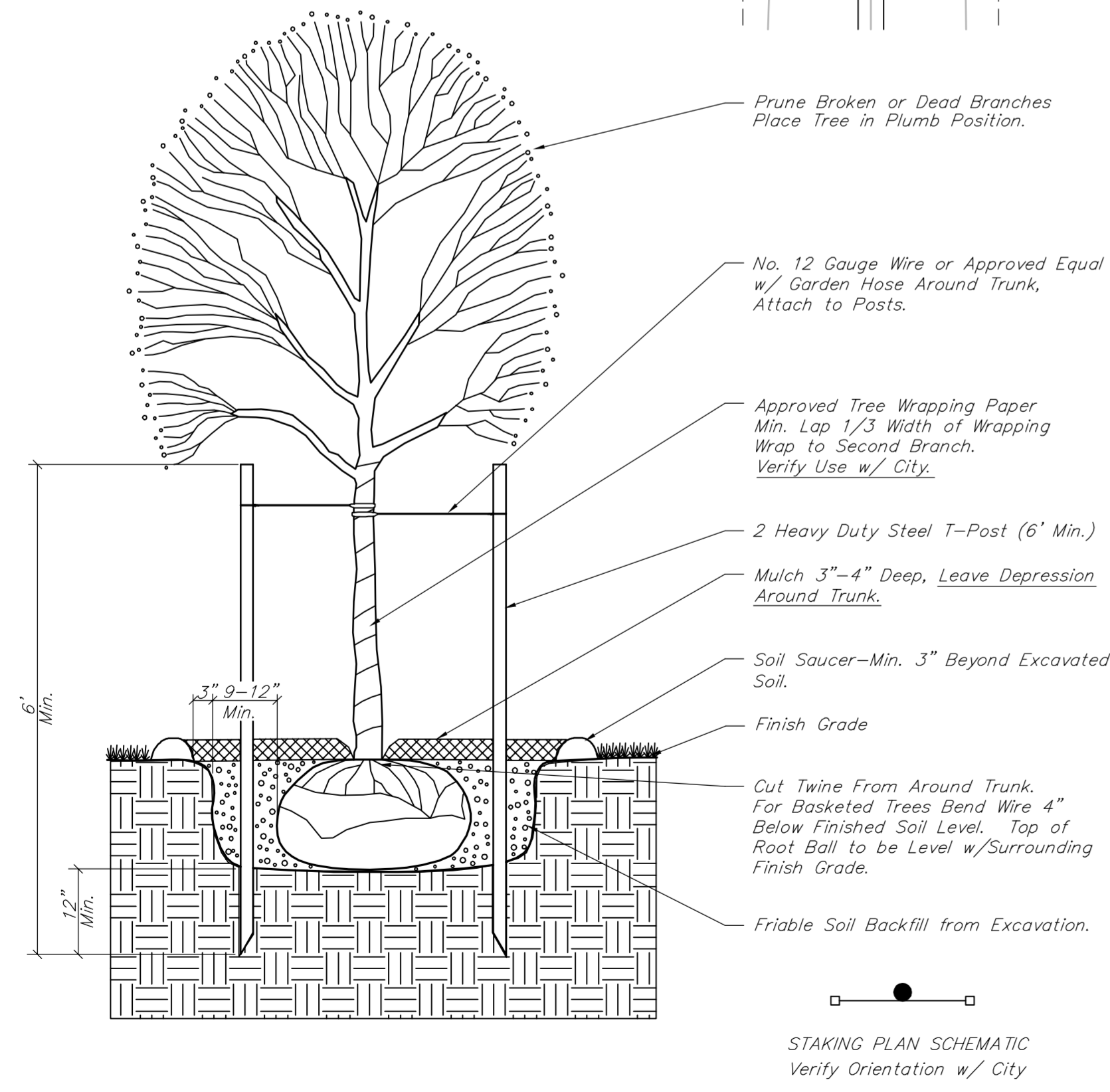

**TREE PLANTING & STAKING DETAIL**

Deciduous Trees Larger than 2" Cal. No Scale  
 Evergreen Trees Larger than 6' Height