

BENCHMARK:  
 BM #15 - "C" Chiseled in the Northeast Corner of the RCBC  
 Under the YMCA Entrance.  
 Sta. 190+61, 68' Lt.  
 Elev. = 1282.23 MSL

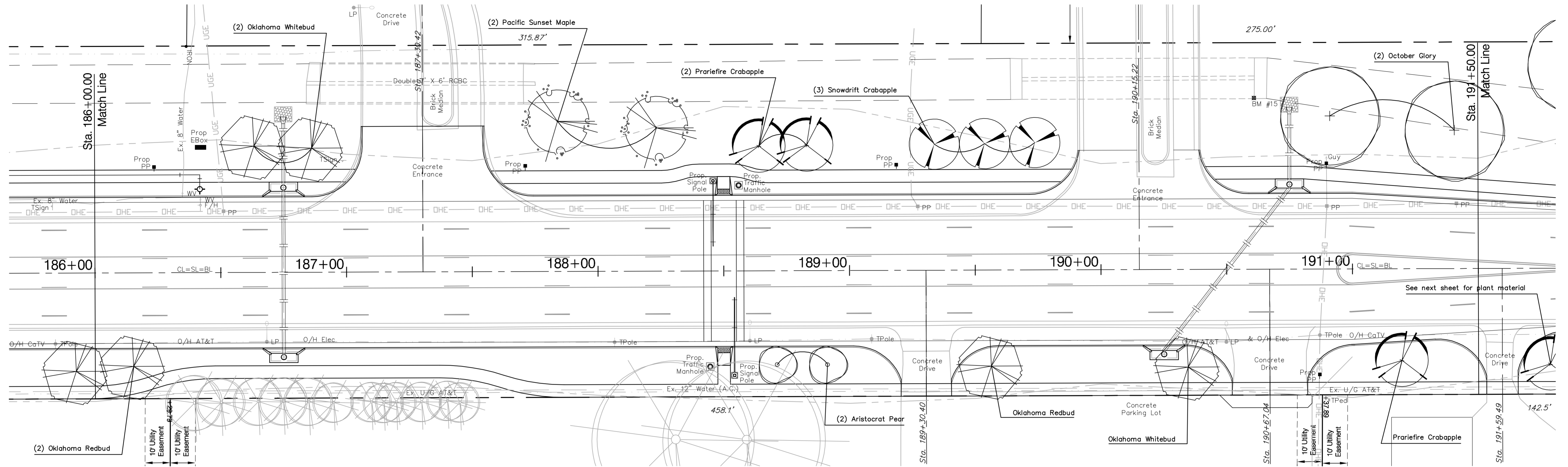
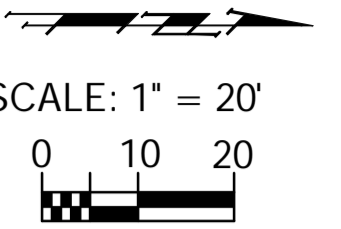

Plant List - This Sheet

Quantity	SCIENTIFIC	COMMON	SIZE	METHOD	NOTE
2	<i>Acer rubrum</i> 'October Glory'	October Glory	2" Cal	B&B	Full & Healthy
2	<i>Acer truncatum</i> 'Pacific Sunset'	Pacific Sunset Maple	2" Cal	B&B	Full & Healthy
3	<i>Cercis canadensis</i> ssp. <i>texensis</i> 'Oklahoma'	Oklahoma Redbud	2" Cal	B&B	Full & Healthy
3	<i>Cercis canadensis</i> ssp. <i>texensis</i> 'Oklahoma Whitebud'	Oklahoma Whitebud	2" Cal	B&B	Full & Healthy
3	<i>Malus</i> 'Prairiefire'	Prairie Fire Crabapple	2" Cal	B&B	Full & Healthy
3	<i>Malus</i> 'Snowdrift'	Snowdrift Crabapple	2" Cal	B&B	Full & Healthy
2	<i>Pyrus calleryana</i> 'Aristocrat'	Aristocrat Pear	2" Cal	B&B	Full & Healthy

Drawing File: E:\eng\Meridian\_47th to 31st\Landscape.dwg

Design: BKB  
 Drawn: BKB  
 Approved: PJM  
 Scale: 1"=20'

Project No. 0510E396 CAPITAL IMPROVEMENT PROJECT

MERIDIAN AVENUE LANDSCAPE  
 Sta. 186+00.00 to Sta. 191+50.00  
 MERIDIAN AVENUE - 47TH STREET SOUTH to 31ST STREET SOUTH

**Baughman Company, P.A.**  
 315 Ellis St. Wichita, KS 67211 P 316-262-7271 F 316-262-0149  
 ENGINEERING | SURVEYING | PLANNING | LANDSCAPE ARCHITECTURE

September 2009

SHEET  
 OF 154  
 OF 187