

FHWA REG. NO.	STATE	PROJECT NO.:	YEAR	SHEET NUMBER	TOTAL SHEETS
7	KANSAS	87 N-0502-01	2009	8	226

A.R.R.A.-N050(201)

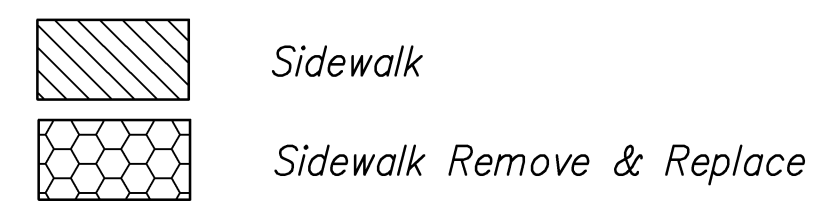
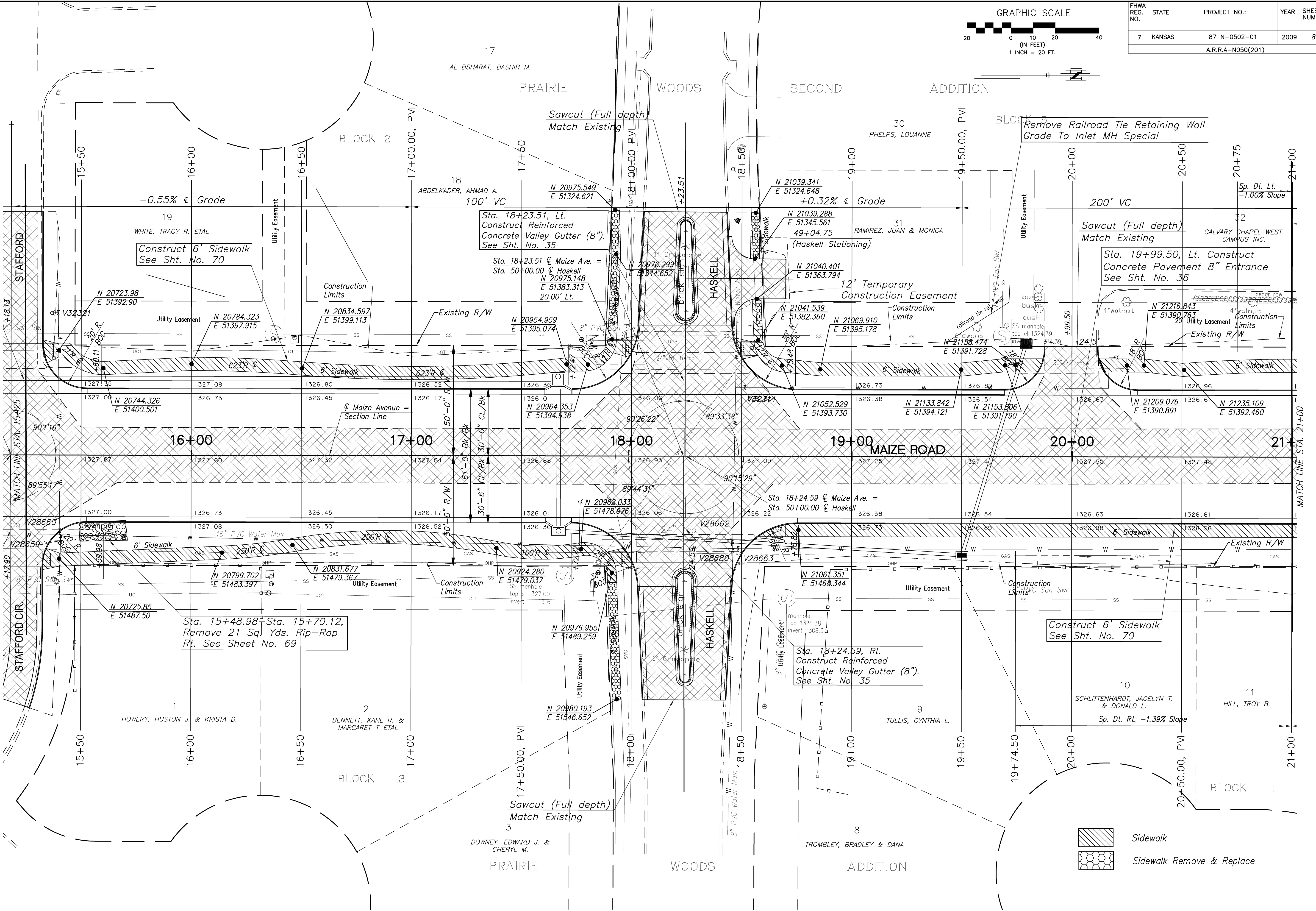

MAIZE ROAD WEST KELLOGG AVE. TO PANWEE AVE. CITY OF WICHITA, KANSAS PAVEMENT PLAN 15+25 TO 21+00		POE & ASSOCIATES, INC. CONSULTING ENGINEERS 5940 E. Central, Suite 200 • Wichita, KS 67208-4242 Phone: 316/685-4114 • FAX: 316/685-4444
ENGINEER: P. FERGUSON DESIGNER: K. WARREN KDOT Job No.: 87 N-0502-01 Pce Job No.: 1935 Date: SEPTEMBER 2009		