

FHWA REG. NO.	STATE	PROJECT NO.:	YEAR	SHEET NUMBER	TOTAL SHEETS
7	KANSAS	87 N-0502-01	2009	101	226
A.R.R.A-N050(201)					

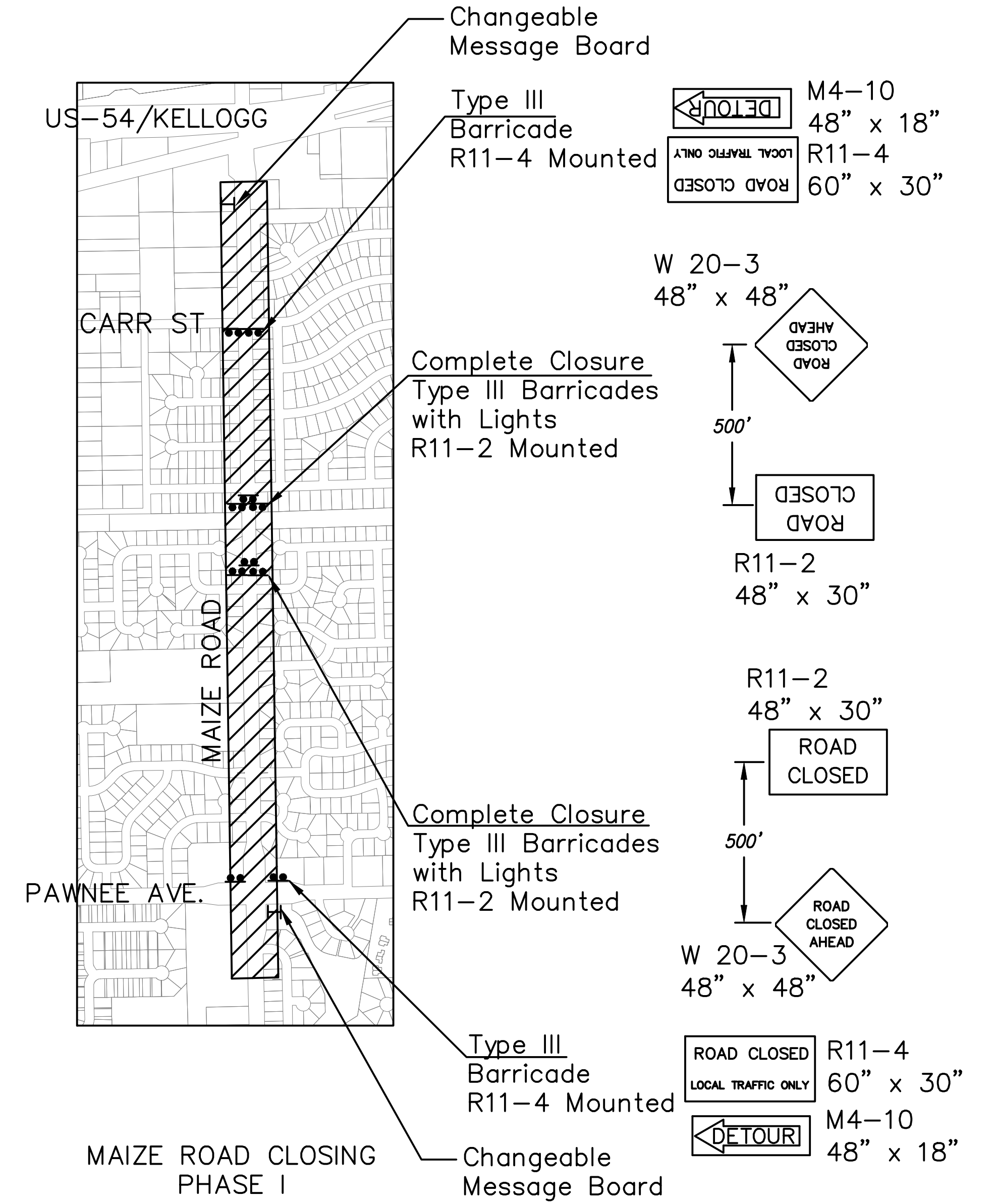
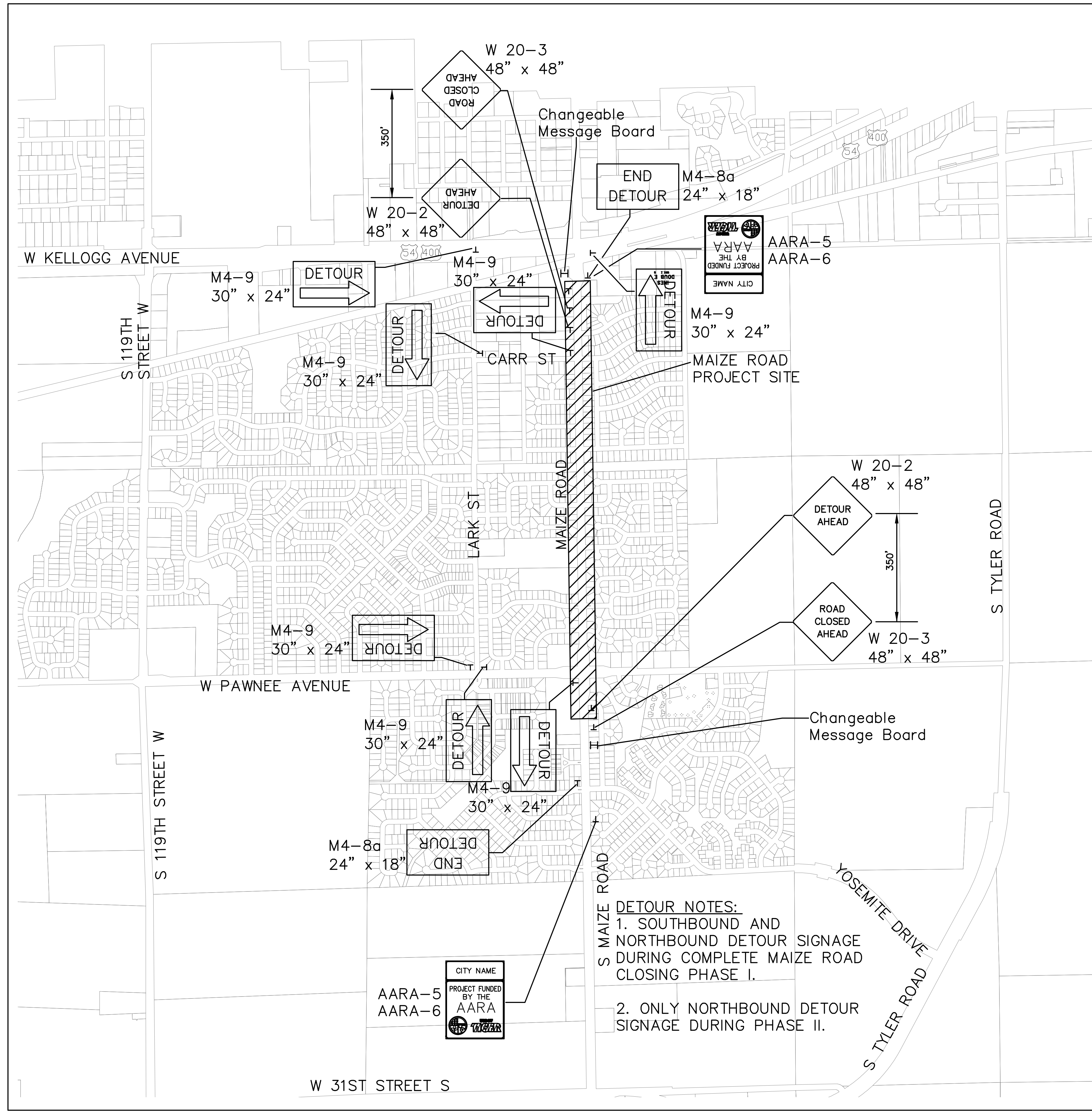
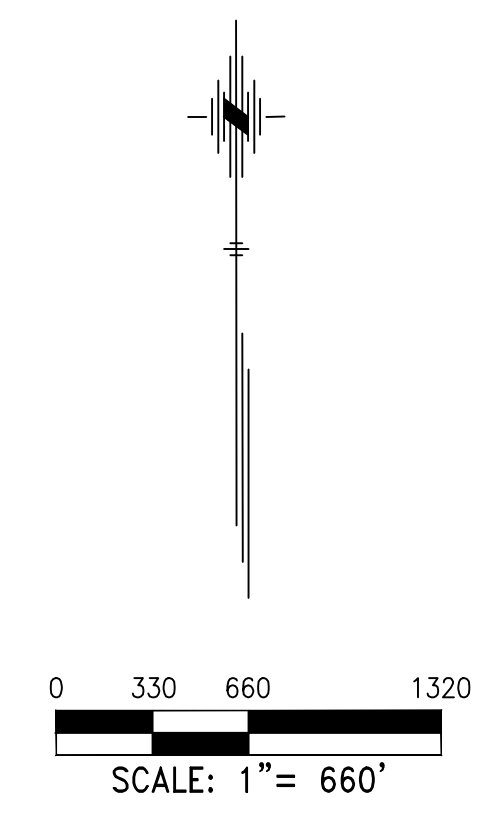

**DETOUR NOTES:**  
 1. SOUTHBOUND AND NORTHBOUND DETOUR SIGNAGE DURING COMPLETE MAIZE ROAD CLOSING PHASE I.  
 2. ONLY NORTHBOUND DETOUR SIGNAGE DURING PHASE II.

No.	Date	By	Approved	Revision
1				
<b>MAIZE ROAD</b> WEST KELLOGG AVE. TO PAWNEE AVE. CITY OF WICHITA, KANSAS DETOUR ROUTING				
<b>POE &amp; ASSOCIATES, INC.</b> CONSULTING ENGINEERS 5940 E. Central, Suite 200 ■ Wichita, KS 67208-4242 Phone: 316/685-4114 ■ FAX: 316/685-4444				
<b>FINAL</b>				
Engineer:	P. FERGUSON	Designer:	K. WARREN	Date:
KDOT Job No.:	87 N-0502-01	Poe Job No.:	1935	
Sheet 101 of 226				