

8
BURGESS, JARED & HEIDI
REGIER

FHWA REG. NO.	STATE	PROJECT NO.:	YEAR	SHEET NUMBER	TOTAL SHEETS
7	KANSAS	87 N-0502-01	2009	13	226
A.R.R.A.-N050(201)					

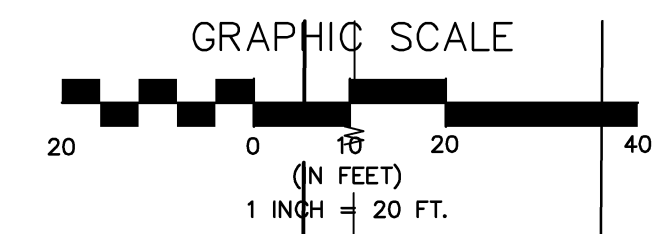

MAIZE AVENUE
2ND
ADDITION
BLOCK A

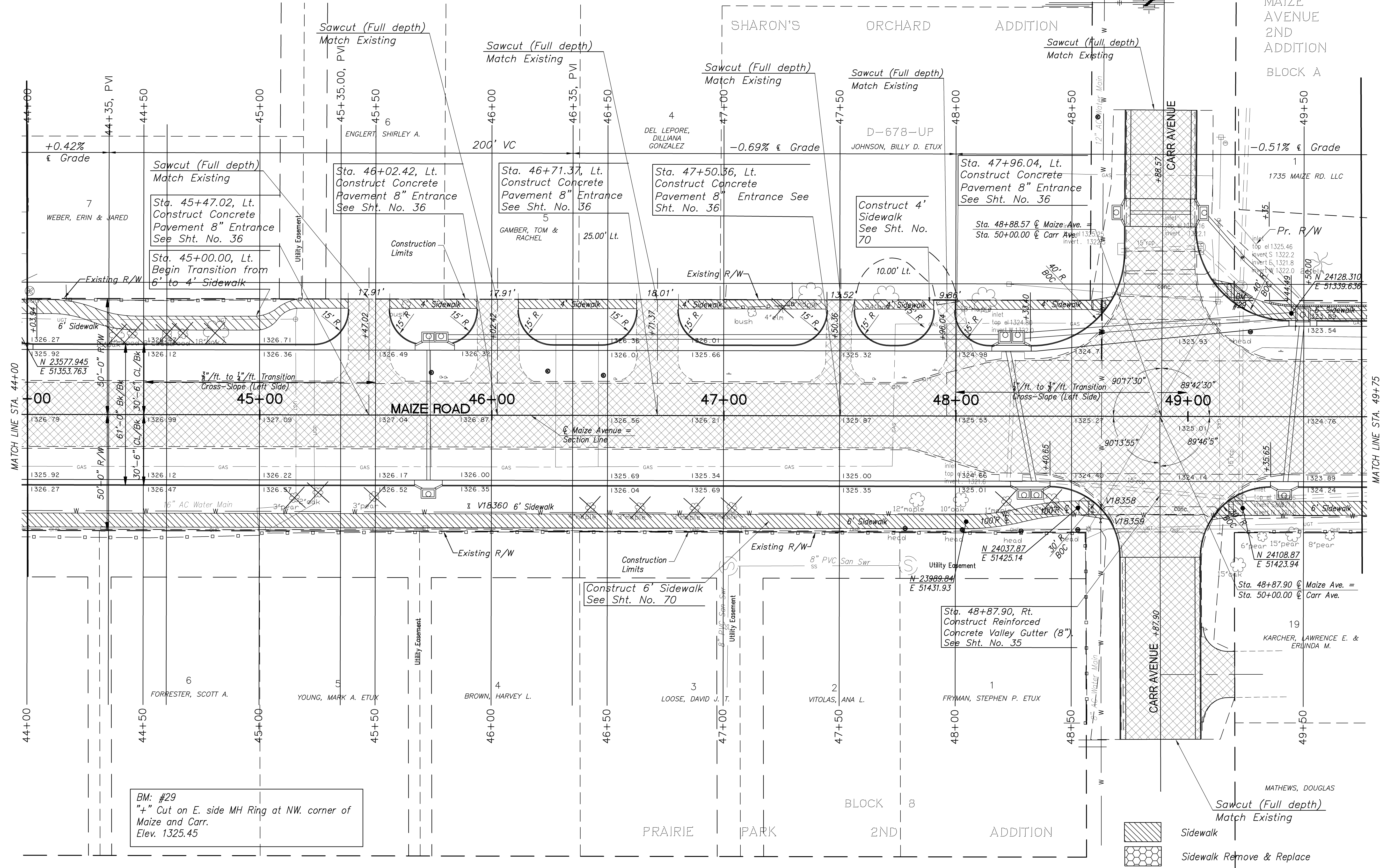

BM: #29
"+" Cut on E. side MH Ring at NW. corner of
Maize and Carr.
Elev. 1325.45

Sidewalk
 Sidewalk Remove & Replace

MAIZE ROAD WEST KELLOGG AVE. TO PANWEE AVE. CITY OF WICHITA, KANSAS PAVEMENT PLAN 44+00 to 49+75	
POE & ASSOCIATES, INC. CONSULTING ENGINEERS 5940 E. Central, Suite 200 • Wichita, KS 67208-4242 Phone: 316.685-4114 • FAX: 316.685-4444	
Engineer: P. FERGUSON Designer: K. WARREN KDOT Job No.: 87 N-0502-01 Poe Job No.: 1935 Date: SEPTEMBER 2009	Sheet 13 of 226