

| FHWA REG. NO.    | STATE  | PROJECT NO.: | YEAR | SHEET NUMBER | TOTAL SHEETS |
|------------------|--------|--------------|------|--------------|--------------|
| 7                | KANSAS | 87 N-0502-01 | 2009 | 139          | 226          |
| A.R.R.A-N05(201) |        |              |      |              |              |

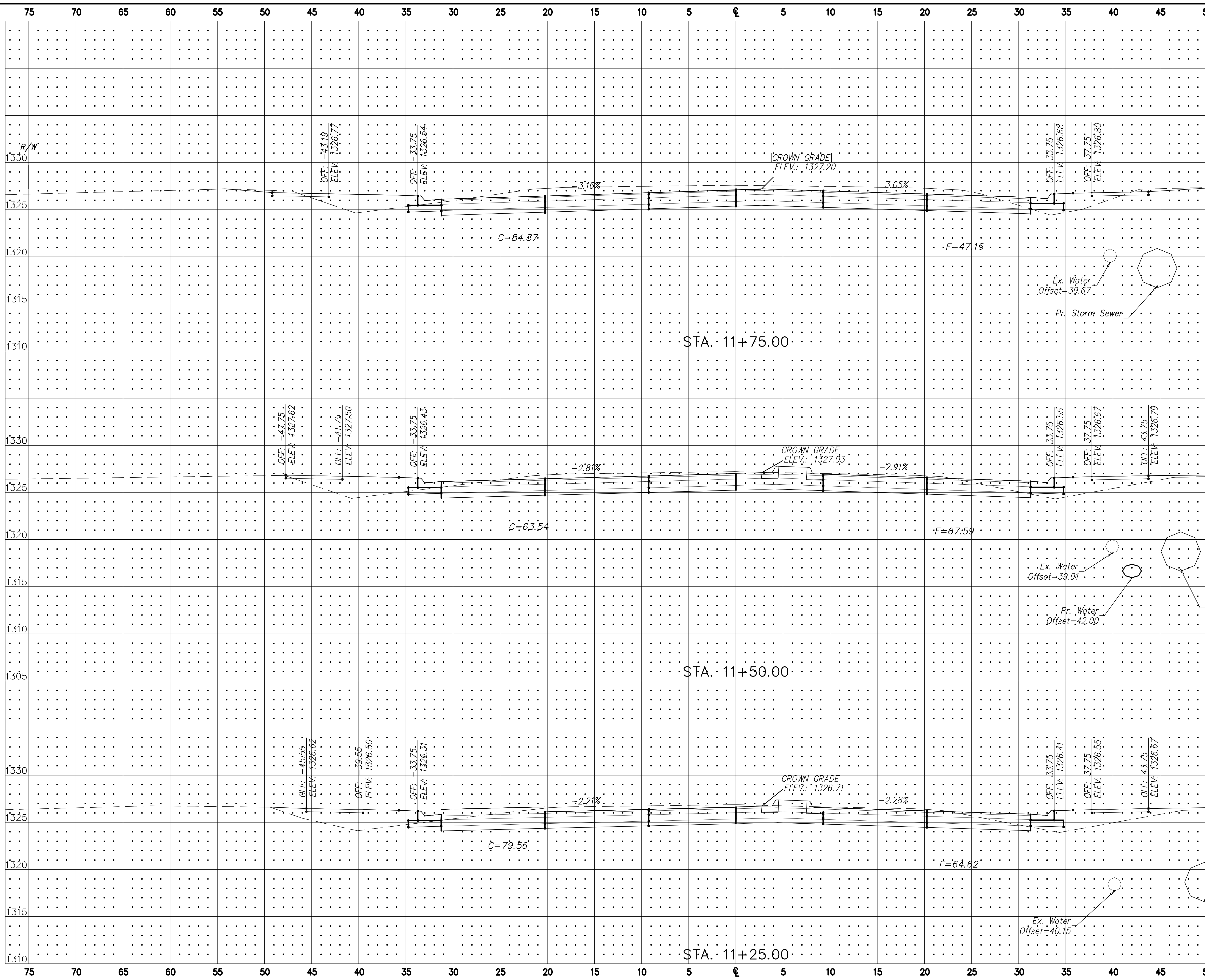

75 70 65 60 55 50 45 40 35 30 25 20 15 10 5 0 5 10 15 20 25 30 35 40 45 50

|                        |                                  |  |
|------------------------|----------------------------------|--|
| MAIZE ROAD             | WEST KELLOGG AVE. TO PAWNEE AVE. | CITY OF WICHITA, KANSAS  |
| POE & ASSOCIATES, INC. | CONSULTING ENGINEERS             | 5940 E. Central, Suite 200 • Wichita, KS 67208-0242<br>Phone 316/685-4714 • FAX 316/685-4444 |
| Engineer: P. FERGUSON  | Designer: K. WARREN              | KDOT Job No.: 87 N-0502-01   |
| Date: AUG 2008         |                                  | Sheet 139 of 226   |