

FHWA REG. NO.	STATE	PROJECT NO.:	YEAR	SHEET NUMBER	TOTAL SHEETS
7	KANSAS	87 N-0502-01	2009	27	226

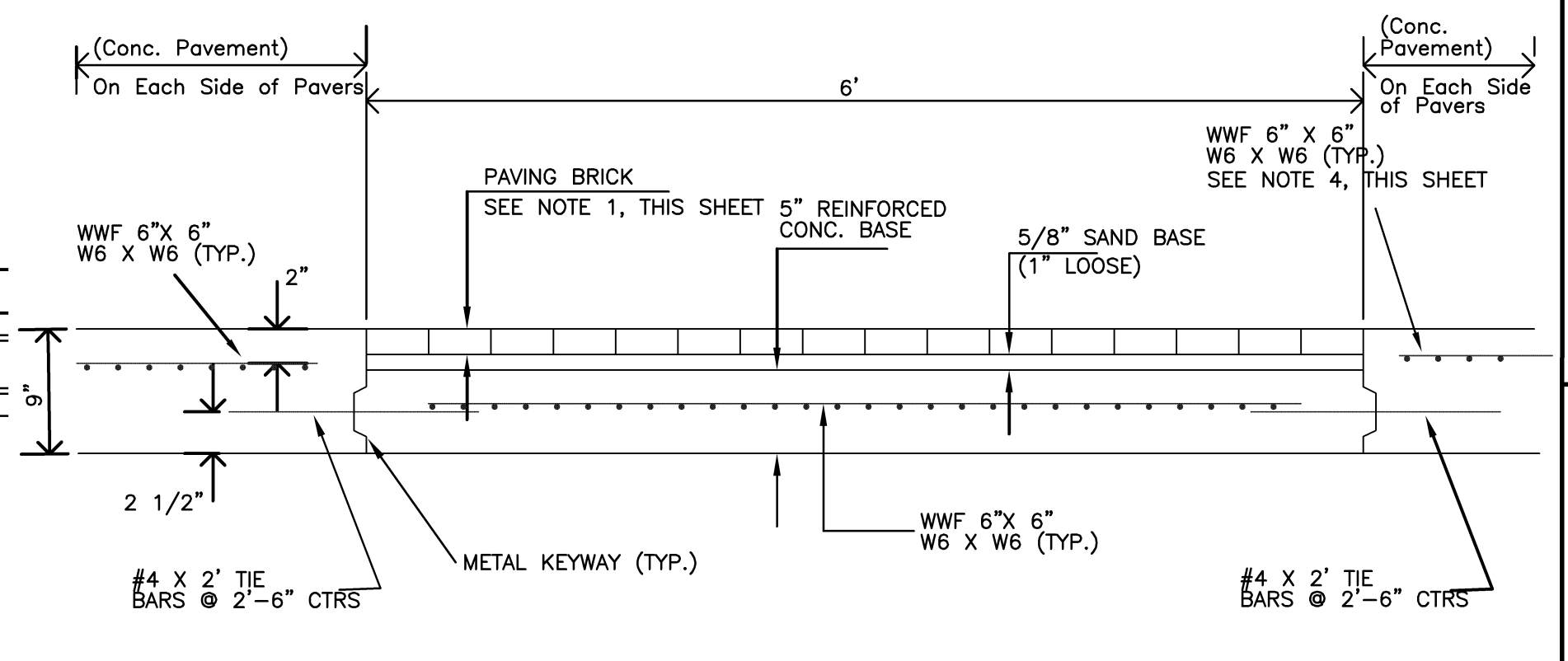
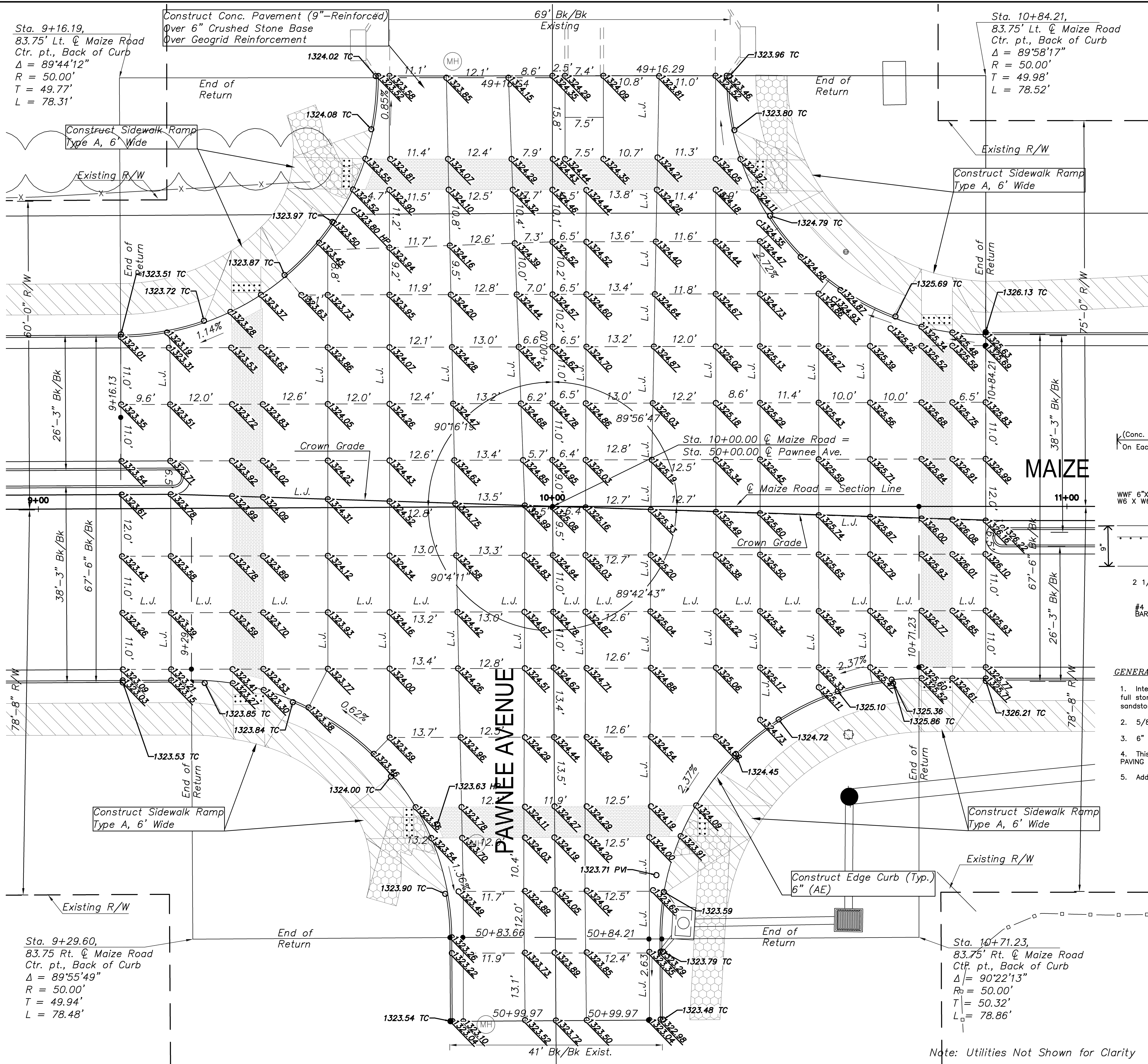
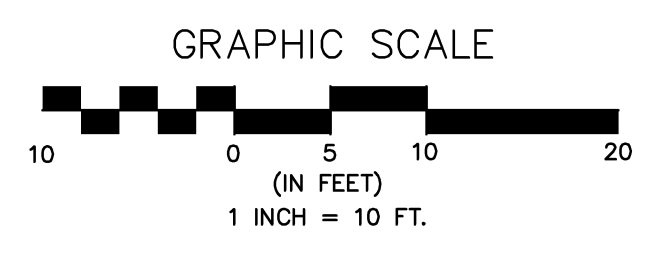

**GENERAL NOTES**

1. Interlocking Concrete Paving Stones (ASTM C936-82) used shall be Holland Stone Style consisting of full stones (8" X 4" X 3 1/8"). Color of the Paving Stones shall be Charcoal-Red (natural, brown, sandstone, charcoal, red/black blend).
2. 5/8" sand base shall be Subsidiary to "Paving Brick".
3. 6" Reinforced Concrete Base shall be paid for under Bid Item 9"-Conc. Pavement (AE)
4. This reinforcement to be placed in concrete panels adjacent to brick crosswalk and is Subsidiary to PAVING BRICK.
5. Additional work involved in forming pavement for Paving Brick will be Subsidiary to PAVING BRICK.

Note: Utilities Not Shown for Clarity

No.	Date	By	Approved	Revision

**MAIZE ROAD**  
WEST KELLOGG AVE. TO PAWNEE AVE.  
CITY OF WICHITA, KANSAS  
PAWNEE 10+00.00

**POE & ASSOCIATES, INC.**  
CONSULTING ENGINEERS  
5940 E. Central, Suite 200 • Wichita, KS 67208-4242  
Phone: 316/685-4114 • FAX: 316/685-4444

Engineer: P. FERGUSON	Sheet	27 of 226
Designer: K. WARREN	Date: SEPTEMBER 2009	
KDOT Job No.: 87 N-0502-01    Proj. Job No.: 1935		