

Sta. 38+26.69, 34.67' Lt.
Construct Type 1-A Curb Inlet
L=16'-10", W=6'-4",
H=6'-0"
Install 204.2 L.F. 30 RCP(S)
See Sheet No. 58

E6

Sta. 41+09.68, 34.17' Lt.
Construct Type 1-A Curb Inlet
L=16'-10", W=5'-4",
H=5'-6"
Install 282.9 L.F. 24" RCP(S)
See Sheet No. 58

E8

Sta. 38+21.27, 33.67' Rt.
Construct Type 1-A Curb Inlet
L=11'-4", W=4'-4", H=5'-0"
Install 68.4 L.F. 18" RCP(W)
See Sheet No. 58

E5

Sta. 41+09.52 33.66' Rt.
Construct Type 1-A Curb Inlet
L=6'-4", W=4'-4", H=5'-0"
Install 67.8 L.F. 18" RCP(W)
See Sheet No. 58

E7

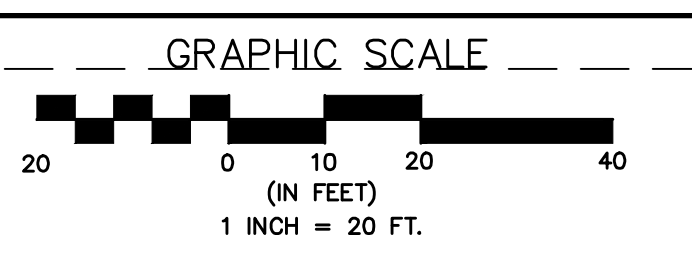

FHWA REG. NO.	STATE	PROJECT NO.:	YEAR	SHEET NUMBER	TOTAL SHEETS
7	KANSAS	87 N-0502-01	2009	51	226

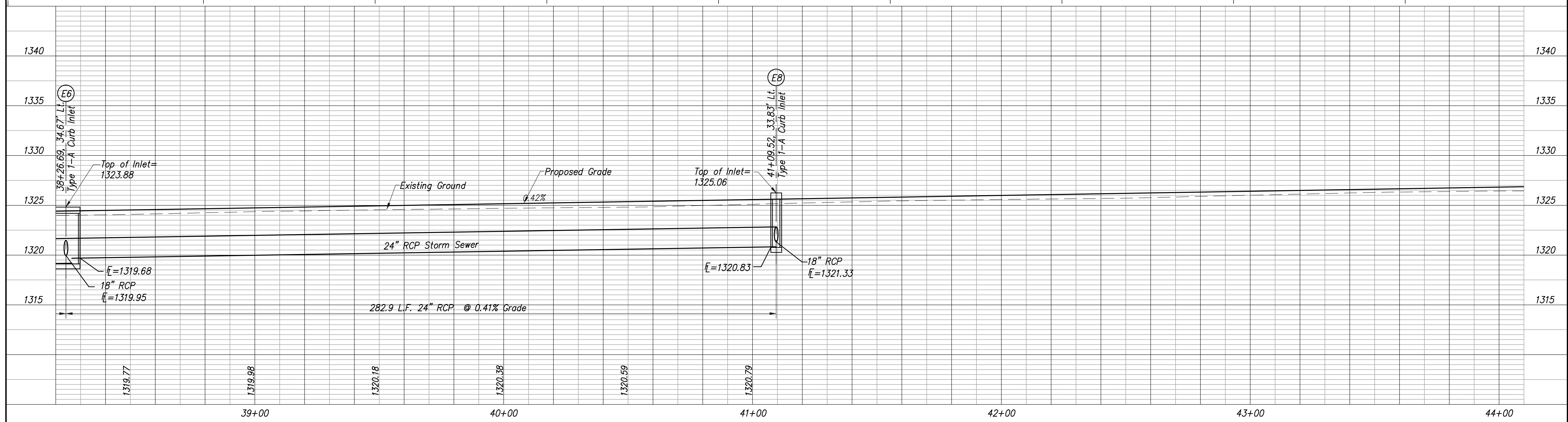
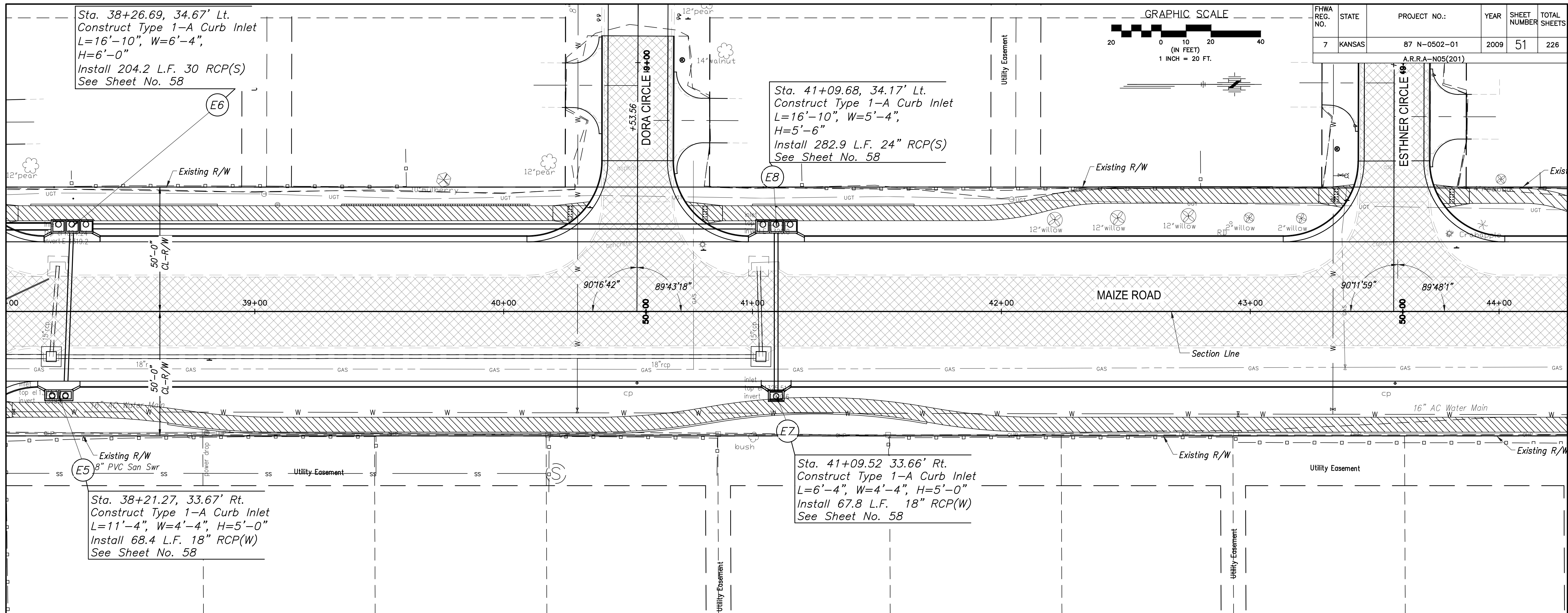

MAIZE ROAD	By	Date	Revision
WEST KELLOGG AVE. TO PAWNEE AVE.			
CITY OF WICHITA, KANSAS			
STORM SEWER P & P 38+20 to 44+00			

POE & ASSOCIATES, INC.
CONSULTING ENGINEERS
5940 E. Central, Suite 200 • Wichita, KS 67208-9212
Phone 316/685-4174 • FAX 316/685-4444

FINAL

Engineer: P. FERGUSON
Designer: K. WAPREN
KDOT Job No.: 87 N-0502-01 Poe Job No.: 1935
Date: SEPTEMBER 2009

Sheet 51 of 226