

COUNTY	STATE	PROJECT NO.	YEAR	SHEET NO.	TOTAL SHEETS
SEDGWICK	KANSAS	87 N-0386-01	2009	2	255

GREENWICH ROAD STREET & SWS IMPROVEMENTS

SW Cor. Sec 27, T27S, R2E
 1. Iron pin flush with pavement
 2. 0.00' Rt. of ℓ Sta. 100+00.00
 3. 3 nails in a power pole 55.30' NE
 4. 3 nails in a power pole 63.30' SE
 5. Nail & Tin in a power pole 62.60' SW
 N-1,678,342.5744
 E-1,686,343.5631

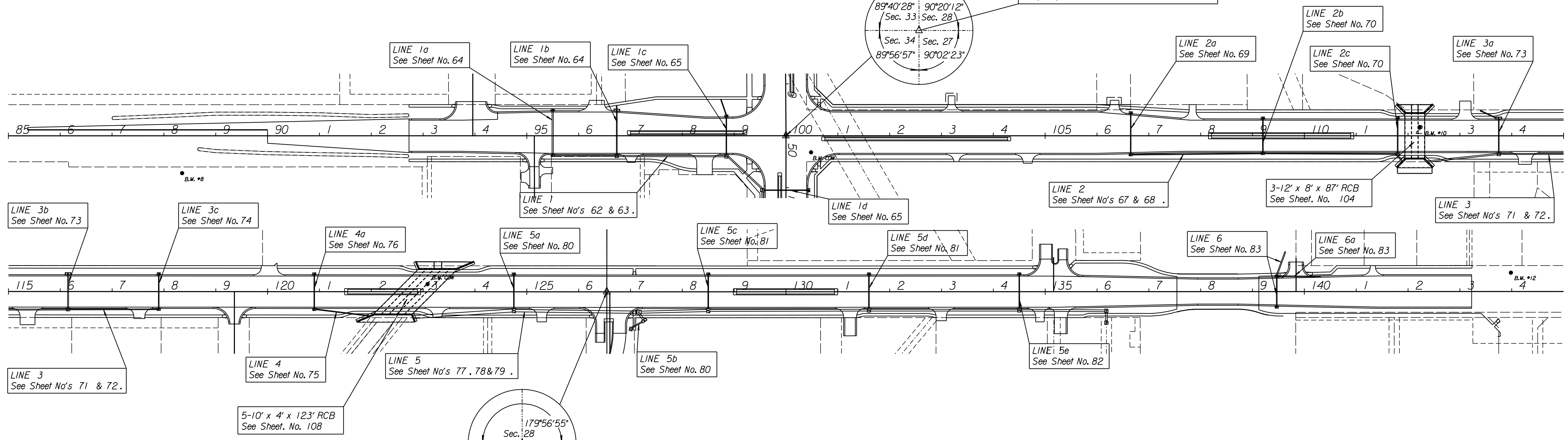

HARRY STREET STREET & SWS IMPROVEMENTS

SW Cor. NW 1/4 Sec 27, T27S, R2E
 1. 0.00' Rt. of ℓ Sta. 126+54.39
 2. Not Found
 N-1,680,996.6895
 E-1,686,305.4534

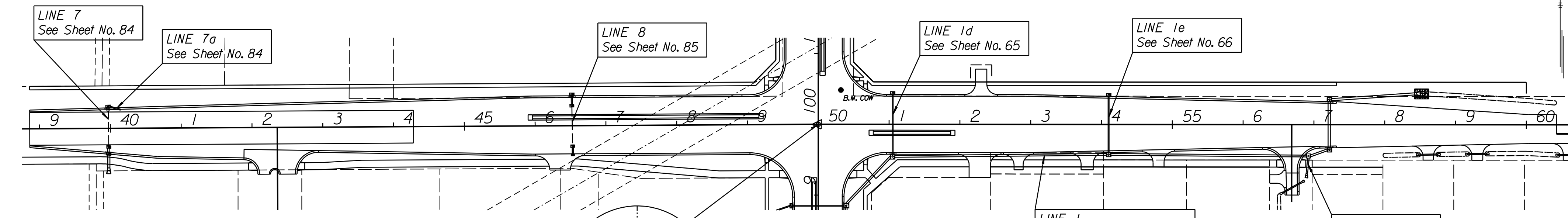

BENCHMARKS

- | | | | |
|---|---|---|--|
| B.M. #8 Chiseled "C" on top of light pole
72' Rt. ℓ Sta. 88+34.94 El. 1346.96 | City of Wichita B.M. Brass Disk on R.C.B. hub guard
15' Lt. ℓ Sta. 123+08.53 El. 1334.01 | City of Wichita B.M. Brass Disk on traffic signal base
SE of int 66.94' Rt. ℓ Sta. 152+50.79 El. 1352.18 | B.M. #15 Chiseled "C" on top of sewer manhole
277' Rt. ℓ Harry Street Sta. 56+48.42 El. 1337.85 |
| City of Wichita B.M. Brass Disk on traffic signal base
32' Rt. ℓ Sta. 100+48.40 El. 1343.91 | B.M. #11 Chiseled "C" on top of C-G inlet
170' Rt. ℓ Sta. 126+75.25 El. 1335.86 | B.M. #13 Hex bolt with steel plate stamped RD on top of fire
hydrant 33' Rt. ℓ Harry Street Sta. 38+02.02 El. 1342.98 | B.M. #16 Chiseled "C" NE corner of concrete box
16' Lt. ℓ Harry Street Sta. 69+27.72 El. 1326.20 |
| B.M. #10 Chiseled "C" on R.C.B. hub guard
15' Rt. ℓ Sta. 112+22.19 El. 1332.64 | B.M. #12 Chiseled "C" on NE corner traffic signal base
36' Lt. ℓ Sta. 143+98.35 El. 1345.96 | B.M. #14 "U" in USA on top of fire hydrant
203' Rt. ℓ Harry Street Sta. 41+93.82 El. 1347.85 | |

CITY OF WICHITA JAMES ARMOUR, P.E., CITY ENGINEER GREENWICH ROAD <h3 style="text-align: center;">KEYSHEET</h3> HARRY STREET TO KELLOGG 188. Wichita, Kansas		
SCALE 1"=100'	DATE 11/23/2009	DWG. NO. 35751A

K:\35751A\CADD\SHEETS\GENERAL\GRNWHKEY.dgn
 SURV. PLOT CADD DES. JRI TR. CKD. JJR APP.