

Scale
Horizontal: 1" = 20'
Vertical: 1" = 2'

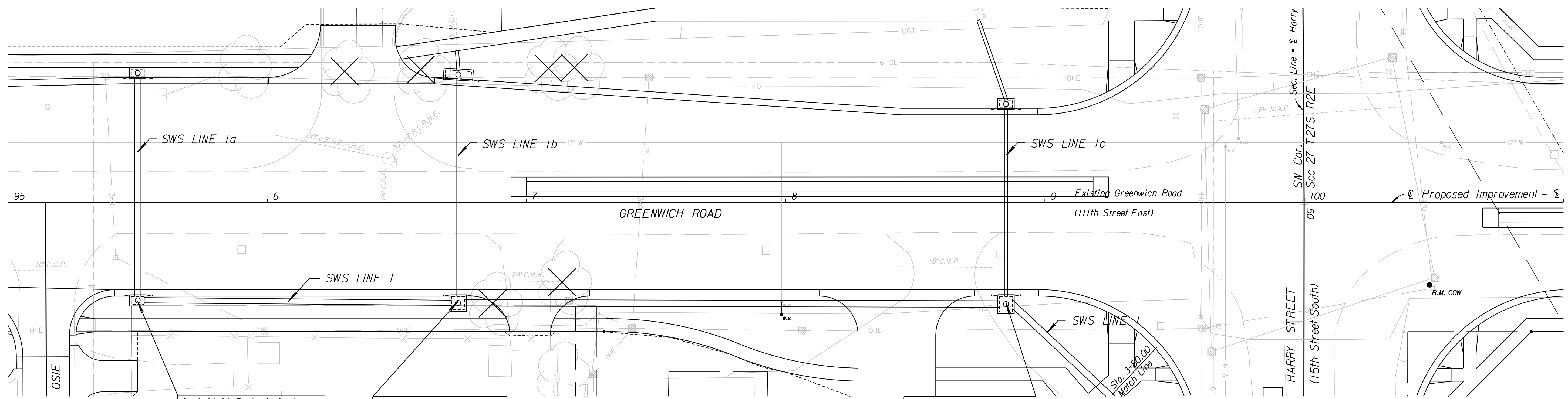

Sta. 0+00.00, Begin SWS Line I =
Sta. 0+88.50, SWS Line 1a =
Sta. 95+50.00, 38.25' Rt.
Construct Inlet (Single)(Type I)
(6'-4" x 4'-4")
Install 24" x 123.60'
Storm Sewer (RCP) (N)
See Sh. No's 90, 96 & 97.

Sta. 1+23.60, SWS Line I =
Sta. 0+84.98, SWS Line 1b =
Sta. 96+73.60, 38.25' Rt.
Construct Inlet (Single)(Type I)
(6'-4" x 6'-4")
Install 30" x 211.39'
Storm Sewer (RCP) (N)
See Sh. No's 90, 96 & 97.

Sta. 3+34.99, SWS Line I =
Sta. 0+76.50, SWS Line 1c =
Sta. 98+85.00, 38.75' Rt.
Construct Inlet (Single)(Type I)
(6'-4" x 7'-4")
Install 30" x 96.29'
Storm Sewer (RCP) (N)
See Sh. No's 90, 96 & 97.

City of Wichita B.M. Brass Disk on traffic signal base
32' Rt. Sta. 100+48.40 El. 1343.91

