

COUNTY	STATE	PROJECT NO.	YEAR	SHEET NO.	TOTAL SHEETS
SEDGWICK	KANSAS	87 N-0386-01	2009	186	255

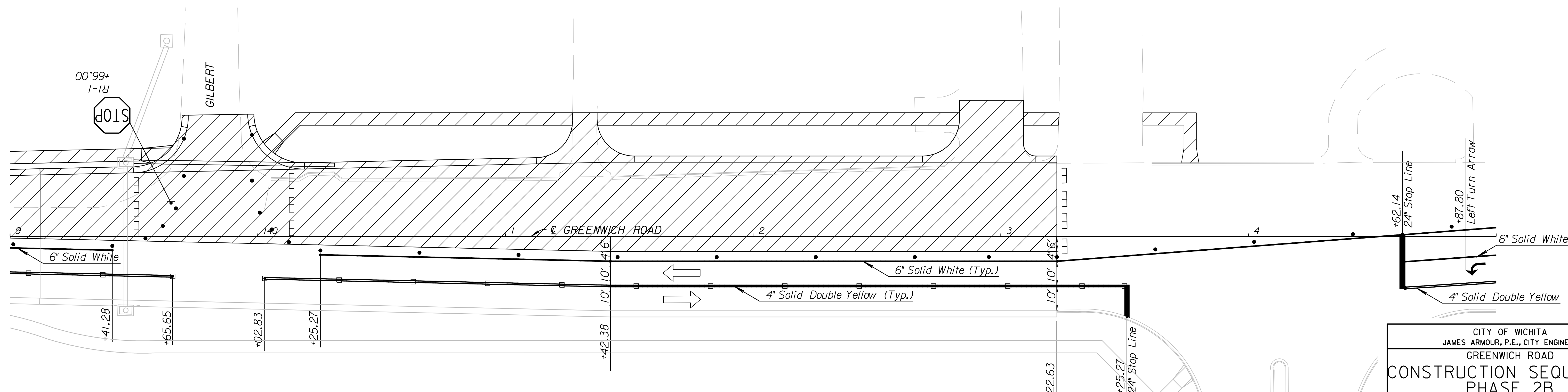
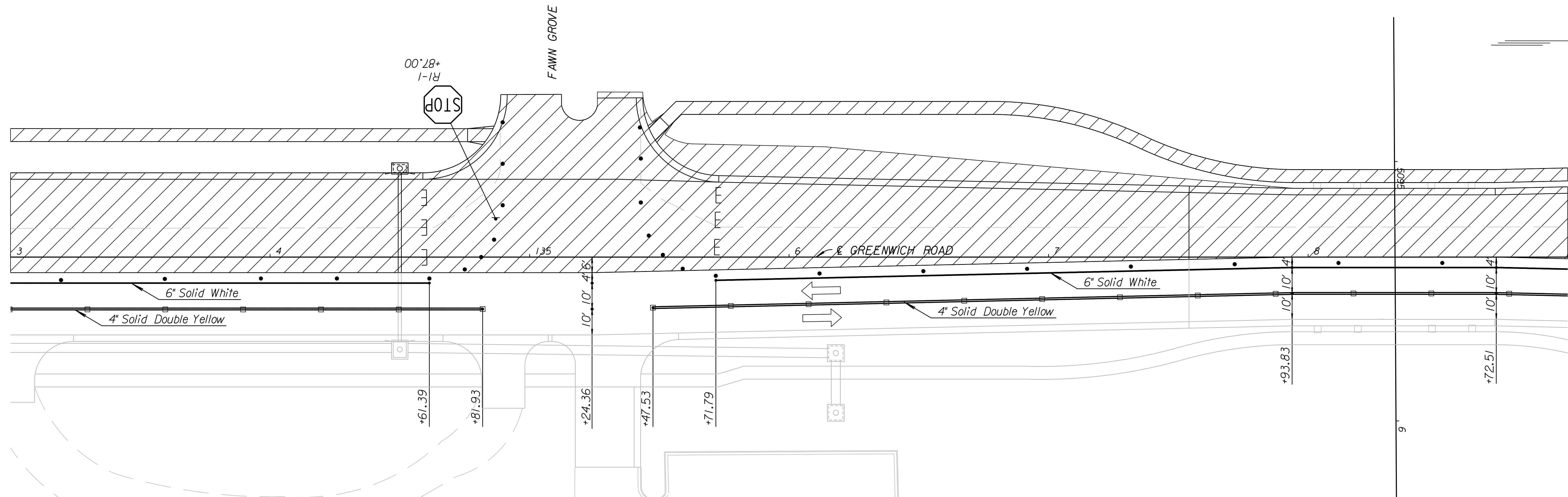

NOTE:
Existing Traffic Signal at Wal-Mart
Entrance shall remain operational at
all times. Conflicting signal heads
shall be covered.

CITY OF WICHITA JAMES ARMOUR, P.E., CITY ENGINEER		
GREENWICH ROAD		
CONSTRUCTION SEQUENCING PHASE 2B		
STA. 133+00.00 TO STA. 145+00.00		
SCALE 1"=20'	DATE 11/23/2009	DWG. NO. 35751A

K:\35751A\CADD\SHEETS\TRAFFIC\SEQUENCE\PHASE 2B\GRNWHPH205B.dgn
 SURV. PLOT CADD DES. RAN DR. JRI TR. CKD. JJR APP.