





STATE	PROJECT NO.	YEAR	SHEET NO.	TOTAL SHEETS
KANSAS	472-84295	2010	17	194

LEGEND

-  Pavement Removal
-  Sidewalk Removal
-  Pavement Milling
-  Tree Removal

NOTE:
Contractor Shall See Streetscape Plans for all Items of Construction Beyond the Back of Curb. See Shts. 22-40

All Control and Coordinate Data is Located on Sht. 3



DATE	BY
REFERENCES NOTED	
REFERENCES CHECKED	

Plotted By: danavarro
File: g:\W05\0001\ROAD\001\p07.sht

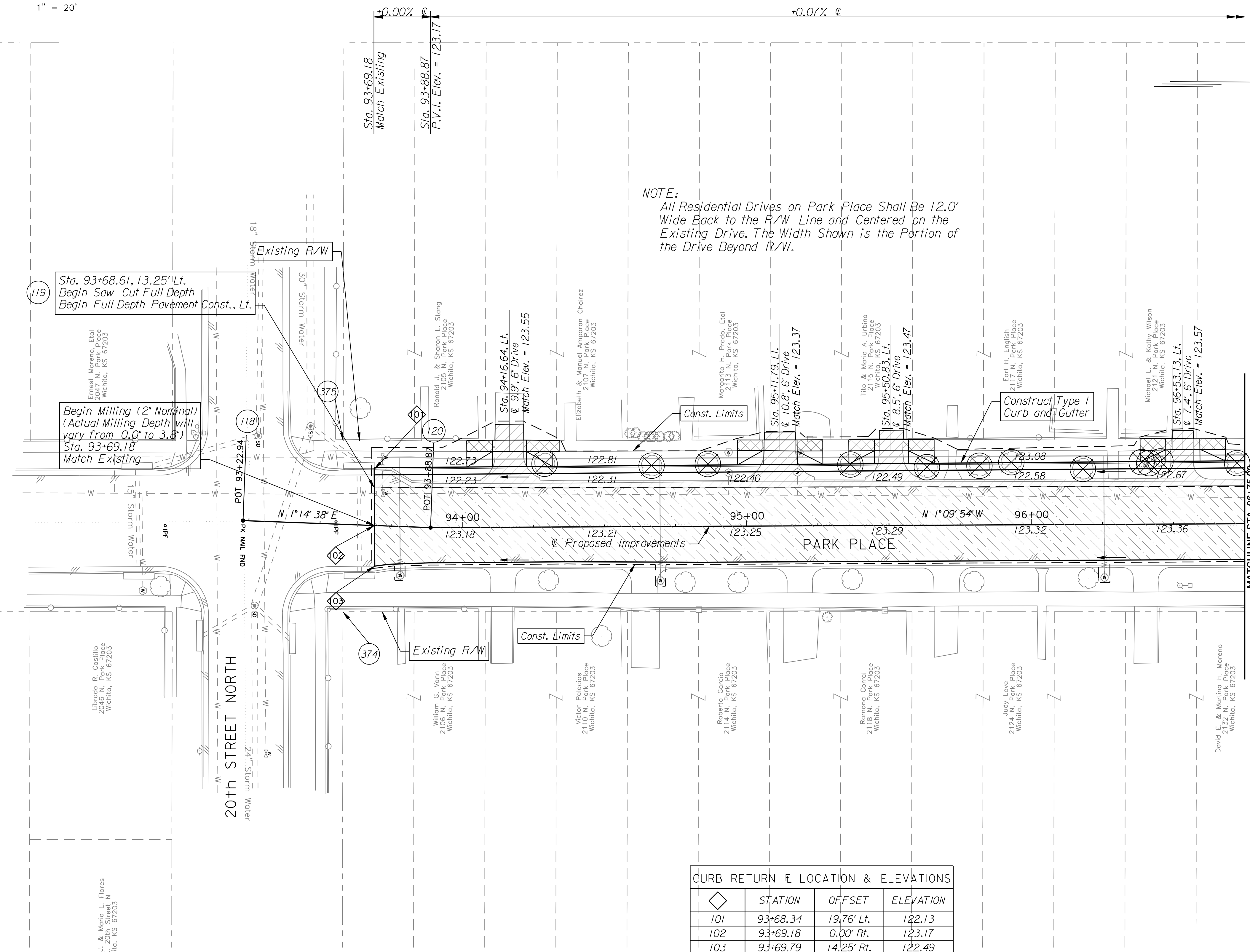

NOTE:
All Residential Drives on Park Place Shall Be 12.0' Wide Back to the R/W Line and Centered on the Existing Drive. The Width Shown is the Portion of the Drive Beyond R/W.

Symbol	STATION	OFFSET	ELEVATION
◇	93+68.34	19.76' Lt.	122.13
◇	93+69.18	0.00' Rt.	123.17
◇	93+69.79	14.25' Rt.	122.49

CITY OF WICHITA
21ST STREET NORTH & BROADWAY AVENUE INTERSECTION
PROPOSED PLAN & PROFILE
PARK PLACE
STA. 93+69.18 to STA. 96+75.00
WICHITA, KANSAS

DESIGNED: M.D.B. DATE: 1/8/2010
DRAWN: D.A.N.
CHECKED: B.A.L.

