

A STREETScape IMPROVEMENT PLAN
 STA 6+79.80 - STA. 9+25.00 (BROADWAY AVE SOUTH OF 21ST) 1"=20'-0"
 NORTH

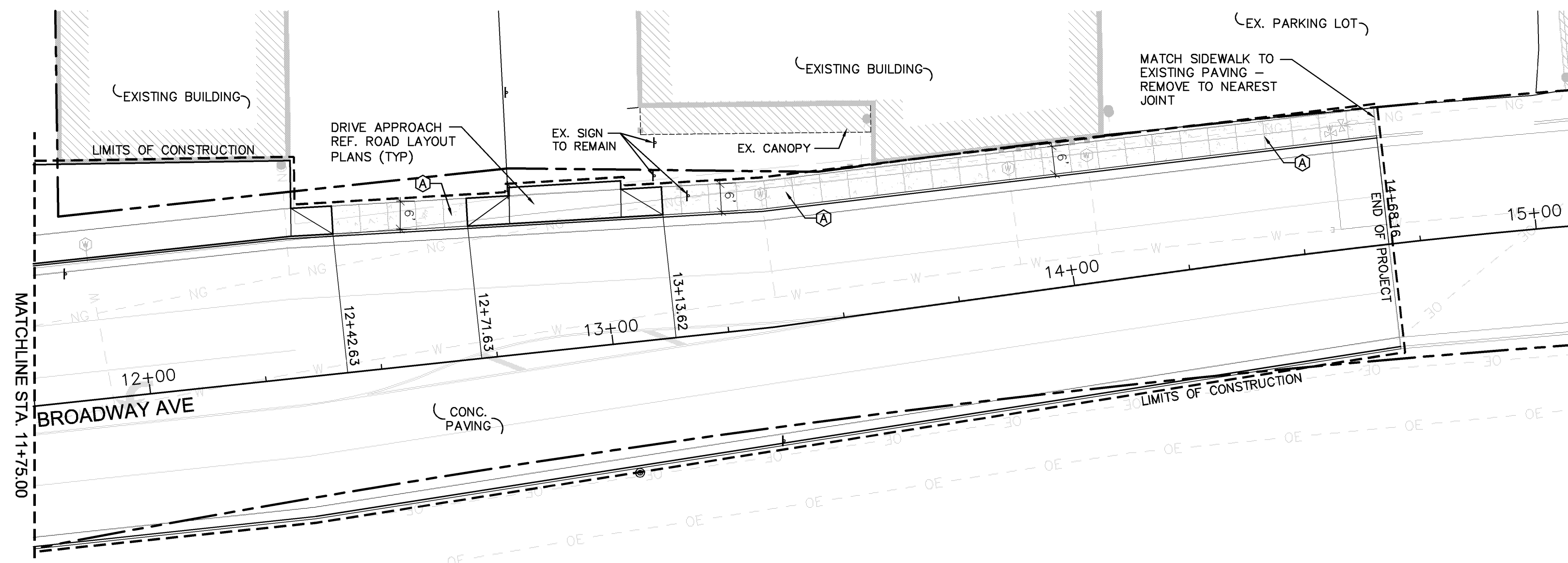

B STREETScape IMPROVEMENT PLAN
 STA 11+75.00 - STA. 15+00.00 (BROADWAY AVE NORTH OF 21ST) 1"=20'-0"
 NORTH

DATE	
BY	
REFERENCES NOTED	
REFERENCES CHECKED	

REFERENCE	DETAIL	DETAIL REFERENCE
(A)	4" PLAIN CONCRETE SIDEWALK	1,2/34, 7/35
(B)	16" CLAY PAVER BAND	B,C,F/30
(C)	PAVERS ON CONCRETE	C/30
(D)	LIGHT POLE PLANTER	1/35
(E)	TREE WELL PLANTER	7/34
(F)	PRIMARY CAST STONE PANEL	5/34
(G)	DISTRICT MONUMENT	6/34
(H)	BENCH	3/35
(HB)	BENCH BACKLESS	4/35

DETAIL	DETAIL REFERENCE
(I) BIKE RACK	5/35
(J) ADA ACCESS RAMP	SHEETS 31,32,33
(K) CROSSWALK PAVER PATTERN	A,E/30
(L) SECONDARY CAST STONE PANEL	4/34
(M) 2" INTEGRAL CONCRETE CURB	3/34
(N) 6" INTEGRAL CONCRETE CURB	1/28
(O) 6" STEEL BOLLARD	2/28
(P) PAVER ISLAND	D/30

LAW/KINGDON, INC.
 ARCHITECTS, ENGINEERS, PLANNERS
 & LANDSCAPE ARCHITECTS

CITY OF WICHITA
 21ST STREET NORTH &
 BROADWAY AVENUE INTERSECTION
 SITE ARCHITECTURAL PLAN
 WICHITA, KANSAS

DESIGNED: J.A.B./W.A.W. DATE: 01-11-2010
 DRAWN: W.A.W.
 CHECKED: J.A.B.

TranSystems