

8" Brick Masonry
PIPE PLUG DETAIL

- Mortar used in plug construction shall be in accordance with standard specifications.
- All brick used in stack construction shall meet Grade ASTM C32 for MM and MS.
- Pipe plugs shall be Subsidiary to the project.

SPRINKLER LINES IN CONFLICT WITH CONSTRUCTION SHALL BE REPAIRED BY THE CONTRACTOR. INCIDENTAL TO THE BID ITEM FOR SITE CLEARING AND RESTORATION

FIELD ADJUST END SECTION TO MATCH POND SLOPE. RESTRAIN END SECTION AND FIRST JOINT BACK.

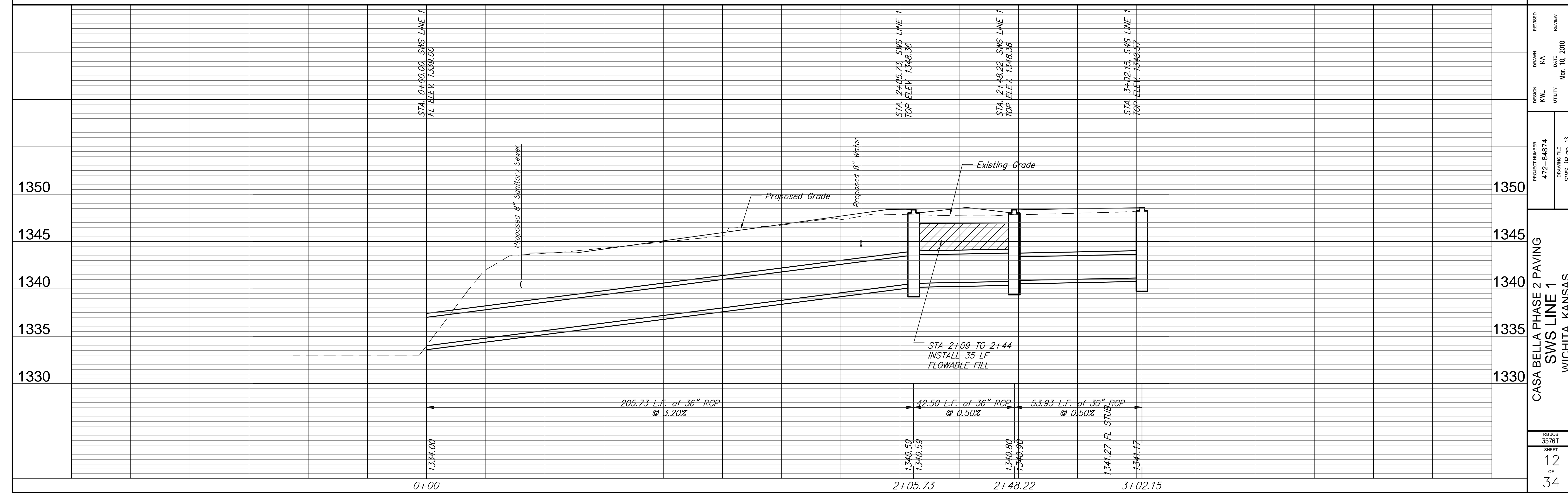

REVISIONS
DRAWN RA
DATE Mar. 10, 2010
REVIEW
DESIGN KWL
UTILITY
PROJECT NUMBER 472-84874
DRAWING FILE SWS (Plan 1)
CASA BELLA PHASE 2 PAVING
SWS LINE 1
WICHITA KANSAS